

Ward of Savana Grande
 County of Victoria
 Cadastral Sheet G.14.D 64.D.
 1/d

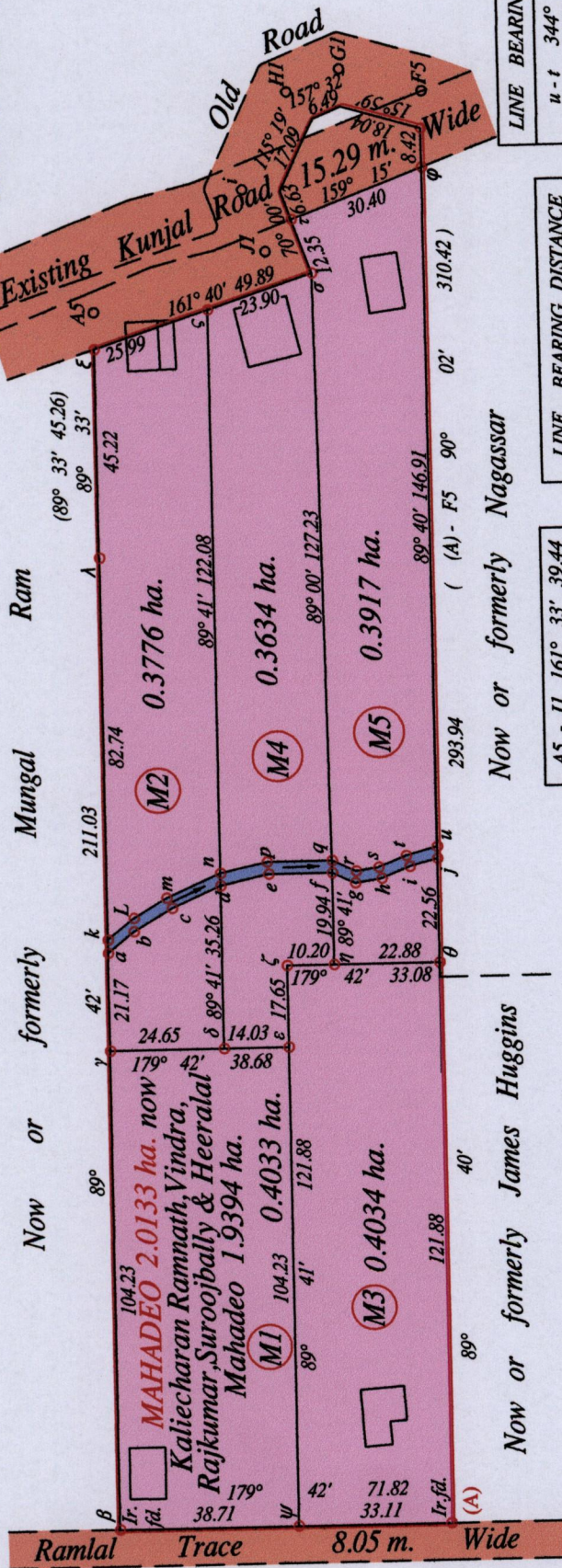

Now or formerly James Huggins

Now or formerly Nagassar

Approved
 Director of Surveys 14/3/14

Vide S.O.# 500 / 17
 Vide Bk. 385 fol. 85

At Station (A)
 E 0679581
 N 1126292
 Reading taken with
 Handheld G.P.S.
 U.T.M. Zone 20
 Naparima
 + 5 m.

SCALE : 1:1500

Distances are in metres
 PLAN of 5 Parcels of land coloured pink in the Ward of Savana Grande
 Containing together one point nine three nine four hectares
 Surveyed by me, with due authority, in March 2010
 Certified Correct in accordance with Regulation 25(1) of the Land Surveyors Regulations 1998

Checked by
 Entered on Trinidad & Tobago Land Surveyor 11.07.2014

A5 - J1	161° 33'	39.44
J1 - i	70° 00'	14.30
i - H1	115° 19'	23.23
H1 - G1	157° 32'	12.47
G1 - F1	15° 59'	18.51

LINE	BEARING	DISTANCE
(A) - β	359° 42'	71.82
β - a	89° 42'	125.40
a - b	140° 47'	7.27
b - c	149° 17'	9.70
c - d	156° 13'	11.57
d - e	167° 10'	10.69
e - f	179° 38'	13.79
f - g	204° 48'	5.48
g - h	171° 09'	5.83
h - i	157° 52'	6.60
i - j	164° 37'	6.23
j - (A)	269° 40'	144.44

Area: 9951.4m²
 Misclosure: 0.01 @ 195° 17' 40"
 Precision: 51336

LINE	BEARING	DISTANCE
u - t	344° 37'	7.04
t - s	337° 52'	6.46
s - r	351° 09'	4.97
r - q	24° 48'	5.70
q - p	359° 38'	14.11
p - n	347° 10'	10.37
n - m	336° 13'	12.82
m - L	329° 17'	8.32
L - k	320° 47'	7.32
k - A	89° 42'	82.74
A - ξ	89° 33'	45.22
ξ - ζ	161° 40'	25.99
ζ - σ	161° 40'	23.90
σ - τ	70° 00'	12.35
τ - φ	159° 15'	30.40
φ - u	269° 40'	146.91

Area: 9440.6m²
 Misclosure: 0.01 @ 198° 02' 04"
 Precision: 98975

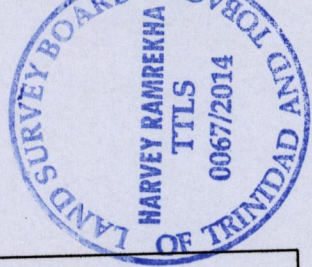

1655

183