

1655

165

R.P.O Vol. 235 Fol. 285
C.T. Vol. 5385 Fol. 195

Ward of Siparia.
County of St. Patrick.
Cadastral Sheet G.18.G. 73C
2/b

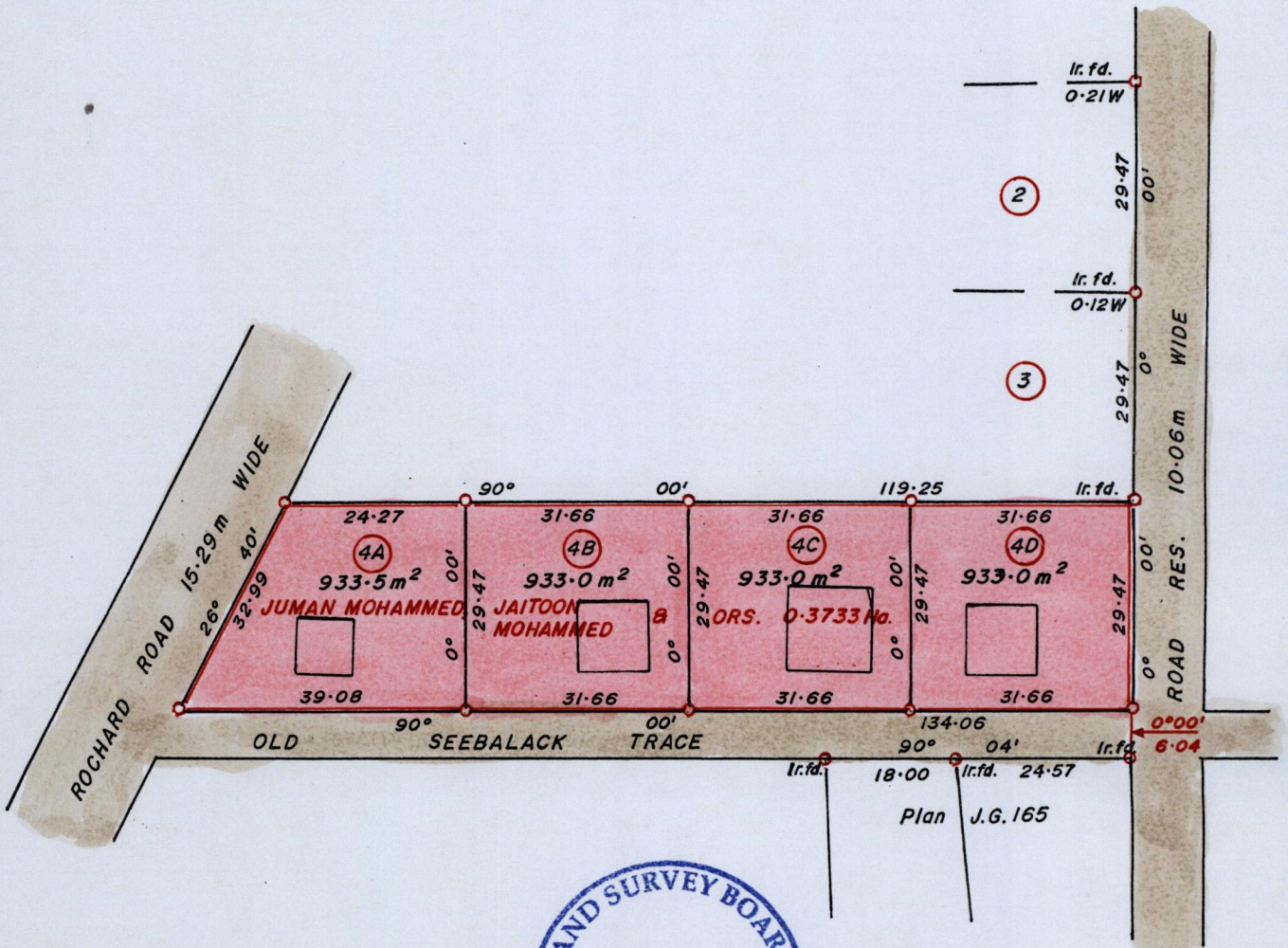
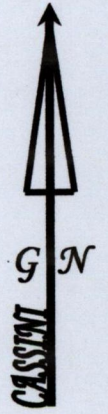

X
1121476 m N ; 673405 m E.
U.T.M. 20 ; WGS 84 (+/-5.0m)
GPS Handheld Direct Obs.

Bk. 1103 : 184.

Approved
Director of Surveys 24/11/14

SCALE 1 : 1250

Distances are in METRES
o Denotes Iron Put except otherwise stated
Bearings are Cassini Grid based on Solar Observations.
Note : To obtain compass Bearing subtract 00 minutes.

PLAN of 4 Parcels of land coloured PINK in the Ward of Siparia.
Containing three thousand seven hundred and thirty two point five square metres.
Re-surveyed by me, with due authority, in May 2014.
Certified correct in accordance with Reg. 25(1) of the Land Surveyors' Regulations 1998,

Checked by
Entered
Trinidad and Tobago Land Surveyor 17 August 2014.