

R.P.O. Vol. 137 Fol. 37
C.T. Vol. 3827 Fol. 197

Ward of Siparia
County of St. Patrick
Cadastral Sheet G 18 D, 73 C
2/a&c

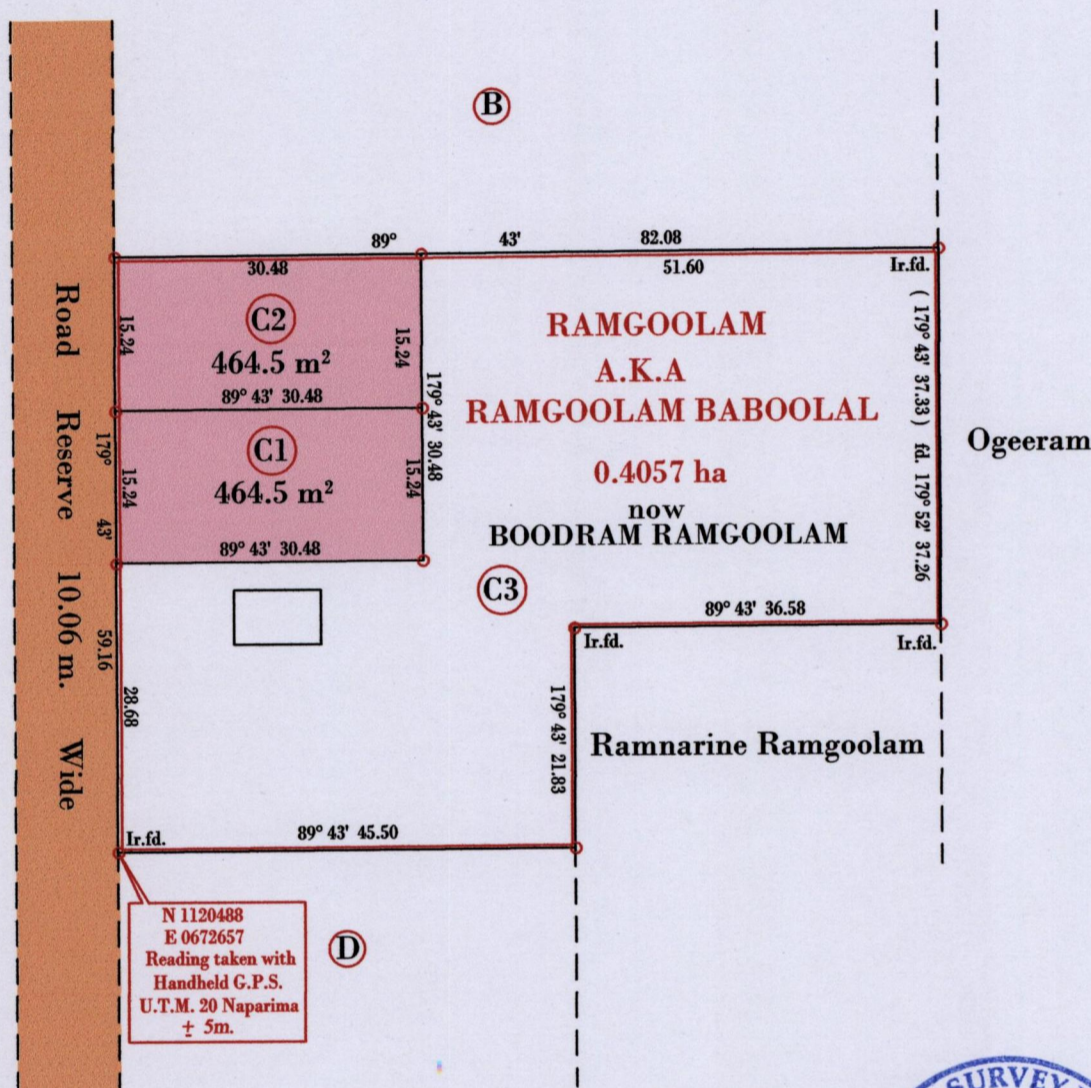

N 1120488
E 0672657
Reading taken with
Handheld G.P.S.
U.T.M. 20 Naparima
± 5m.



Approved
Director of Surveys *u/m*

Vide Bk. 397 fol. 50
Vide Bk. 1128 fol. 63
Vide Bk. 1233 fol. 78

SCALE : 1:750

Note: Bearings are U.T.M. grid based on solar observations Distances are in metres

PLAN of 2 Parcels of land coloured pink in the Ward of Siparia
Containing together nine hundred and twenty nine point zero square metres
Surveyed by me, with due authority, in July 2013
Certified correct in accordance with Regulation 25 (1) of the Land Surveyors Regulations 1998.

Checked by *H.R. 17/09/14* *R. Ramaul*

Entered on Trinidad & Tobago Land Surveyor *15th October* 2014