

R.P.O. Vol. 235 Fol. 273

C.T. Vol. 3572 Fol. 369

Ward of Siparia

County of St. Patrick

Cadastral Sheet G.18.D. 73C  
2/b

Bk. 1195 fol. 141

Bk. 1211 fol. 28

Bk. 1211 fol. 32

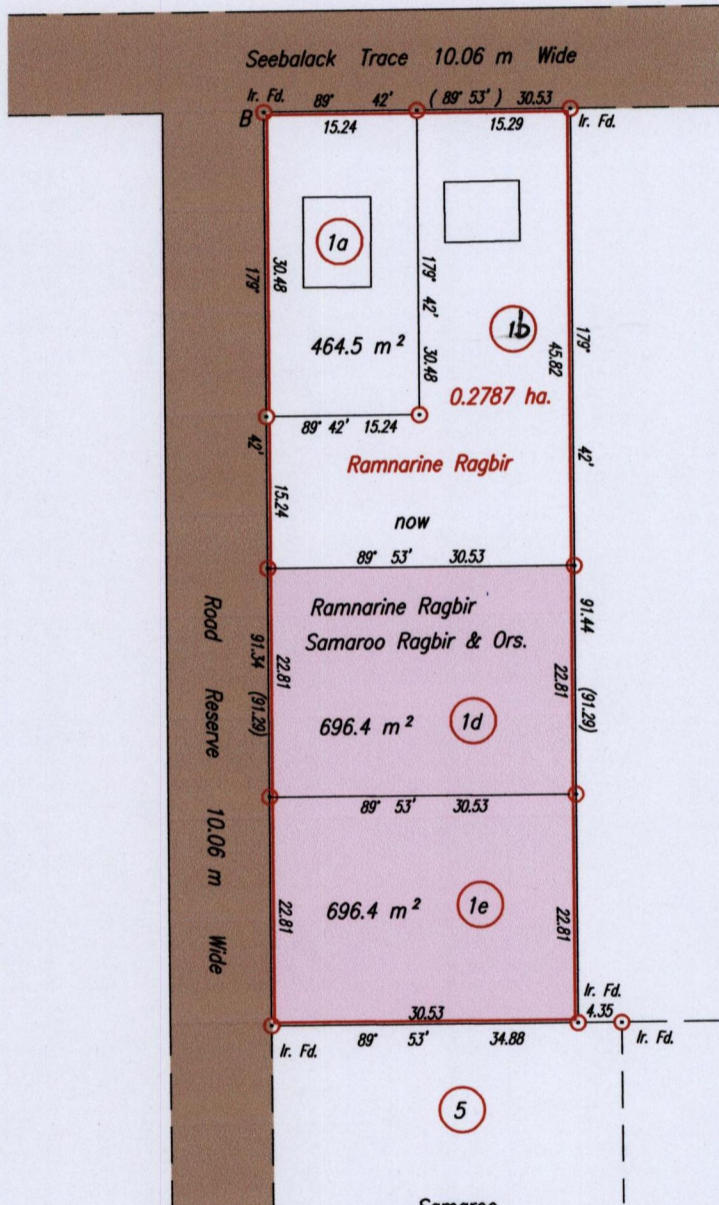

2

Moonindar  
Ragbir

Ir. fd. B 673716m E ; 1121843m N  
 UTM WGS84 ±5m  
 Observation from handheld GPS



5  
Samaroo  
Ragbir

Approved : *[Signature]*  
 Director of Surveys  
 10/11/14

SCALE 1:750

○ denotes iron put except otherwise stated.  
 Bearings are U.T.M. Grid based on solar observations. Distances are in Metres  
 Plan of two Parcels of land coloured pink in the Ward of Siparia  
 Containing together **One Thousand Three Hundred and Ninty Two point Eight** square metres.  
 Surveyed by me, with due authority, in April 2007.  
 Certified Correct In accordance with Regulation 25(1) of the Land Surveyors' Regulations 1998.

Checked by . . . . . *[Signature]* . . . . .  
 Entered . . . . . Trinidad & Tobago Land Surveyor 22<sup>nd</sup> September .2014