

R.P.O. Vol. 100 Fol. 201

C.T. Vol. 3089 Fol. 393

Cadastral Sheet B.18.O. 24A

2/c

Ward of Tacarigua

County of St. George

Point 'A' = N 1176170, E 677825
Coordinates obtained by Hand Held GPS.
U.T.M. 20, NAPARIMA (+/-5.0m.)

REMAINING PORTION

Reference :
Bk.1227 Fol.192
Plan E.H. 138

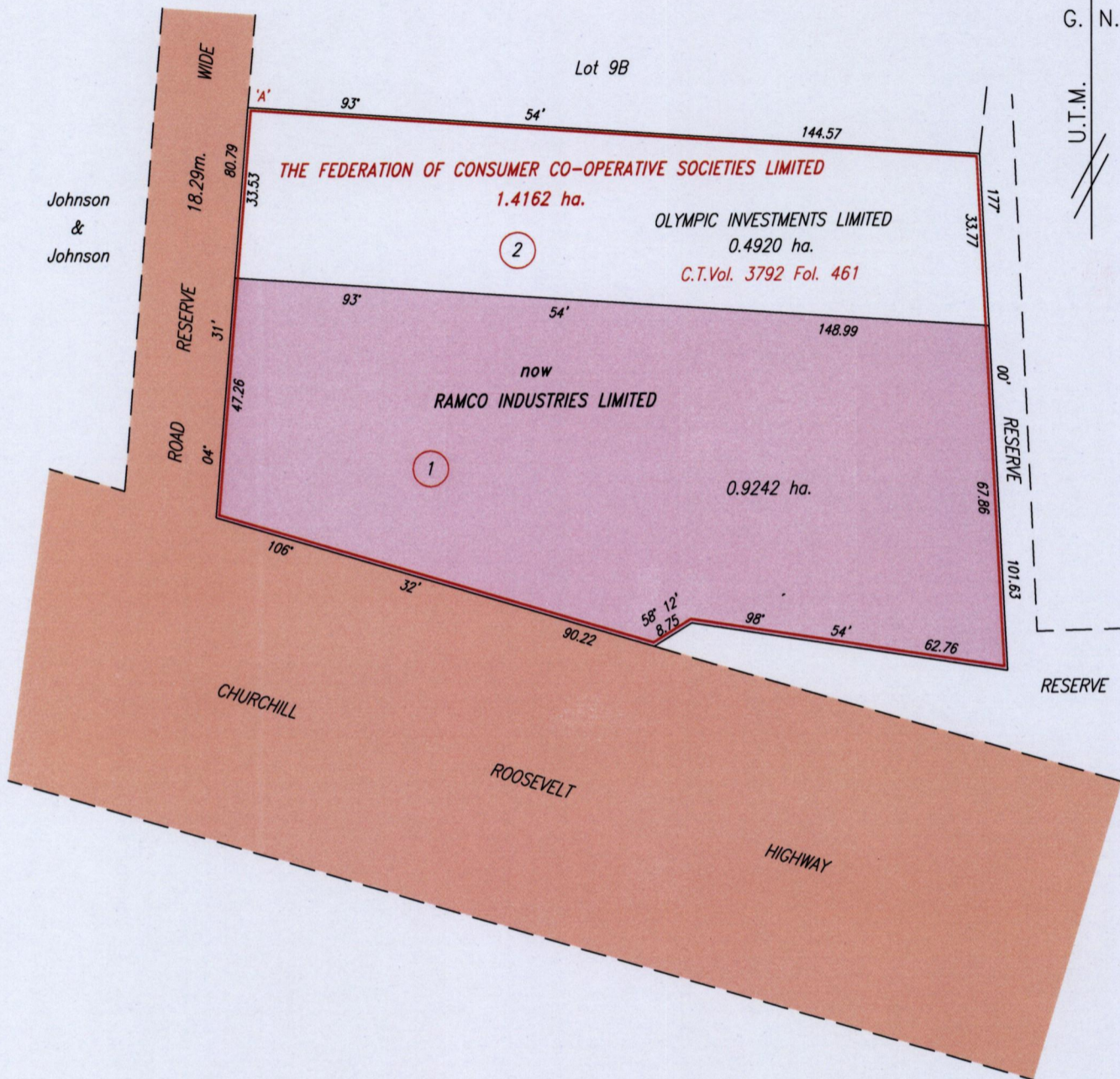
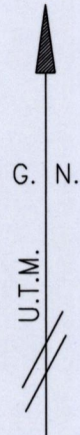

Approved

Director of Surveys

[Signature]
16/7/14

SCALE 1:1250

Distances are in metres

PLAN of one point four one six two hectares originally transferred to
THE FEDERATION OF CONSUMER CO-OPERATIVE SOCIETIES LIMITED

Showing a portion coloured pink and containing zero point nine two four two hectares
Being the remainder after one (1) previous transfer of a portion of the land.

In accordance with Regulation 25 (1) of the Land Surveyors' Regulations 1998,
I certify that this plan represents the remaining portion.



Checked by

[Signature]

Entered on

Trinidad & Tobago Land Surveyor. 2nd May 2014.