

R.P.O. Vol. 152 Fol. 241
C.T. Vol. 2354 Fol. 417

Ward of Siparia
County of St. Patrick
Cadastral Sheet G.18.D 73C.
2/d

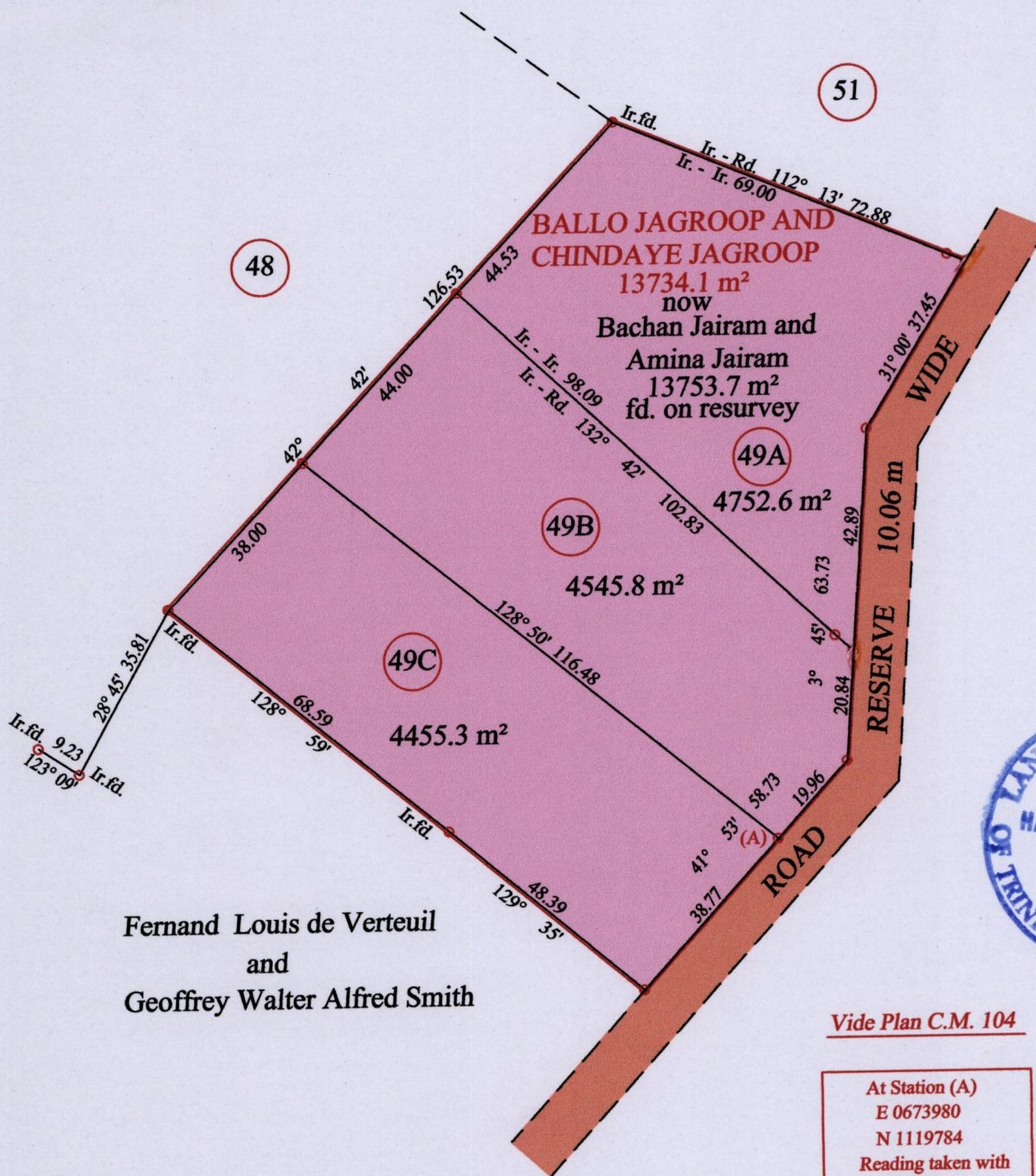

Fernand Louis de Verteuil
and
Geoffrey Walter Alfred Smith



Vide Plan C.M. 104

At Station (A)
E 0673980
N 1119784
Reading taken with
Handheld G.P.S.
U.T.M. Zone 20
Naparima
+ 5 m.

Approved
Director of Surveys

o Denotes Iron put except stated otherwise.
Note: Bearings are U.T.M. grid based on solar observations
PLAN of 3 Parcels of land coloured pink in the Ward of Siparia
Containing together thirteen thousand seven hundred and fifty three point seven square metres
Surveyed by me, with due authority, in February 2014

Certified Correct in accordance with Regulation 25(1) of the Land Surveyors Regulations 1998

Checked by

Entered on Trinidad & Tobago Land Surveyor 9.10.2014

SCALE : 1:1250

Distances are in metres