

R.P.O. Vol. 217 Fol. 559
C.T. Vol. 5237 Fol. 149
U.P.I.N. No.:

Ward of Siparia
County of St. Patrick
Cadastral Sheet G.13.K. 63F
4/a

Reference: Bk.856 Fol.125

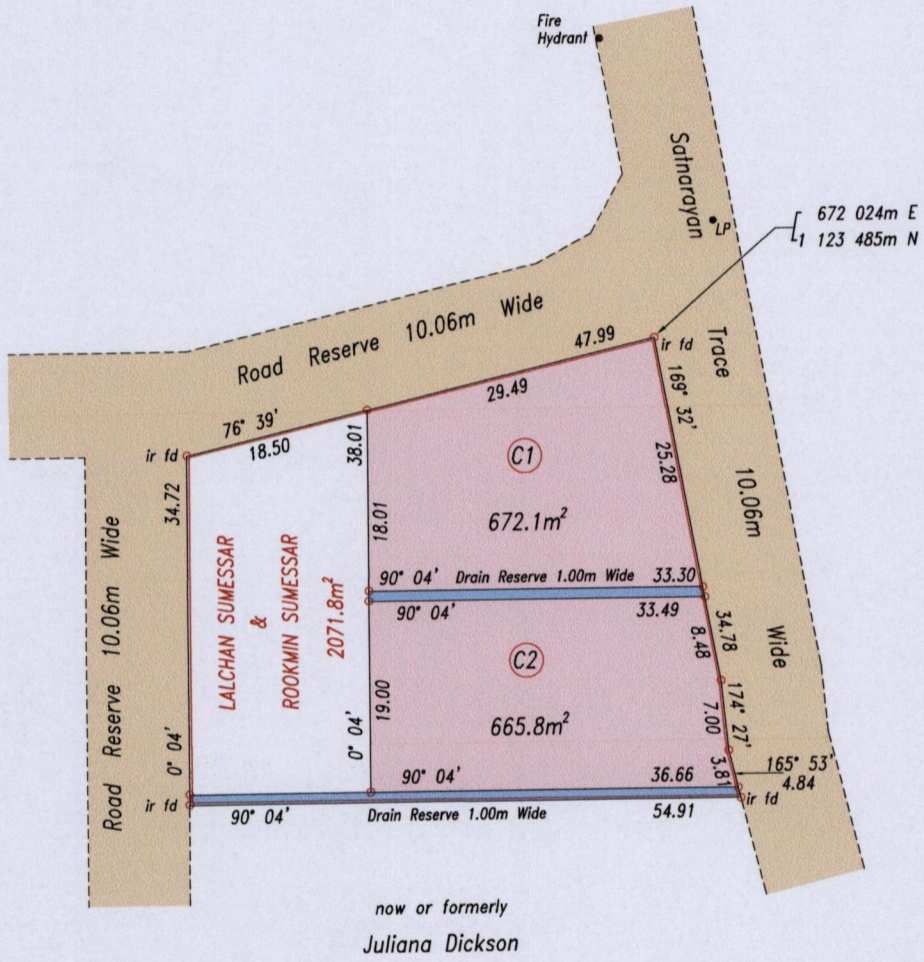
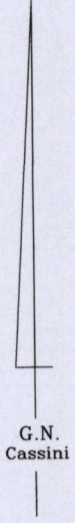

Approved

Director of Surveys

[Signature]
25/10/14

Coordinate Information
Source: GPS (Hand Held)
Error Statement: +/- 5m
Datum: Naparima, UTM (Zone 20).

SCALE 1: 750

Distances are in metres

o Denotes iron put except otherwise stated

Bearings are Cassini Grid based on Solar Observations

PLAN of 2 parcels of land coloured pink in the Ward of Siparia
Containing together one thousand three hundred and thirty seven point nine square metres
Surveyed by me, with due authority, in May 2013

Certified Correct in accordance with Regulation 25(1) of the Land Surveyors' Regulations 1998.

Checked by
Entered

[Signature]
Trinidad & Tobago Land Surveyor 9/7/2014

