

U.P.R.N.

REMAINING PORTION

Cadastral Sheet G. 16. K., 72C/4/b

R.P.O. Vol. 202 Fol. 165

Ward of Erin

C.T. Vol. Fol.

County of St. Patrick

X - 657,450mE, 1118185mN  
UTM ZONE 20, Naparima (+/- 3.00M)  
Direct Observation-GPS Hand held

Bk: 714 Fol: 108

STATE

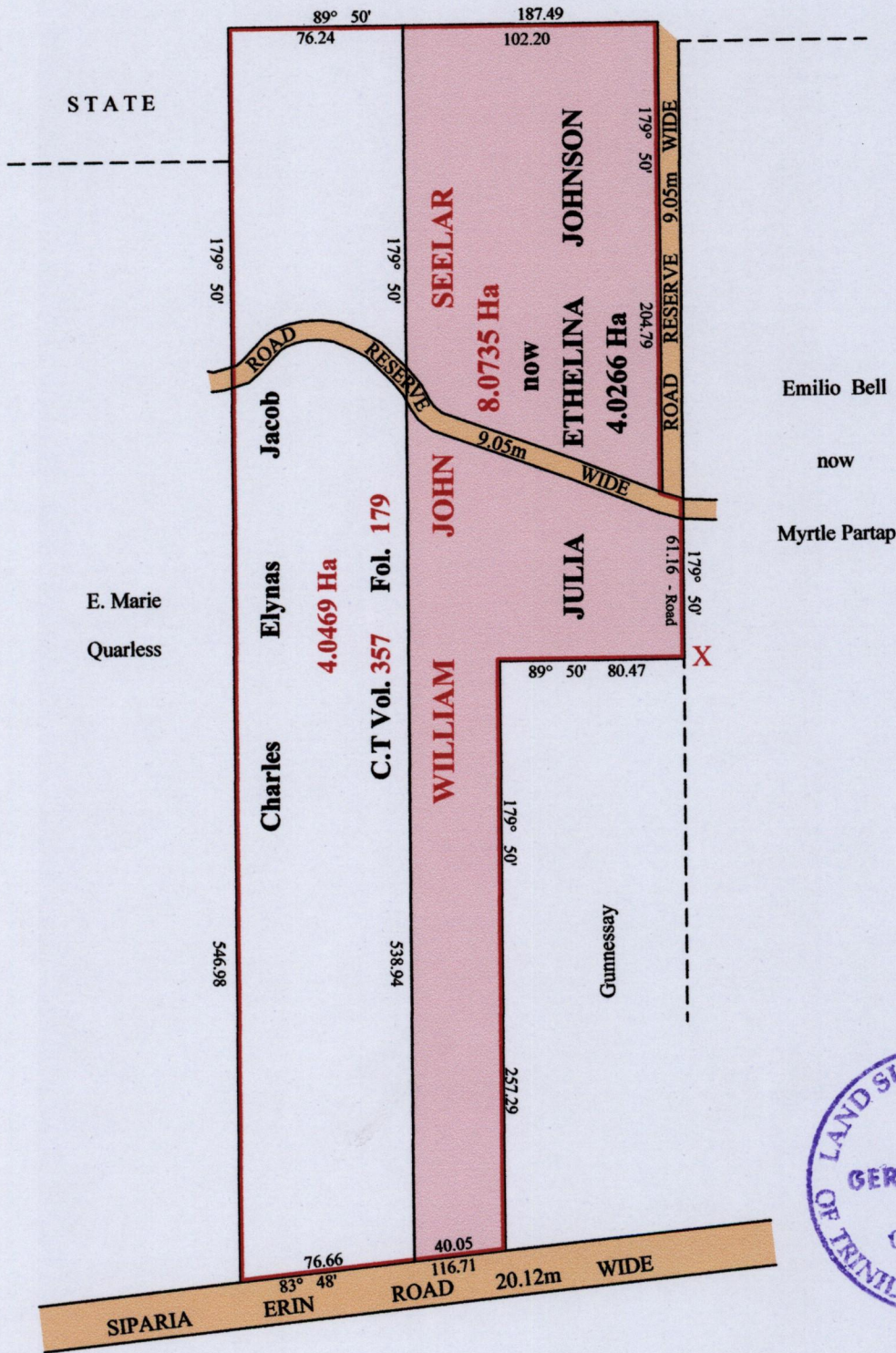

Emilio Bell  
now  
Myrtle Partap

E. Marie  
Quarless



Approved .....  
Director of Surveys

SCALE 1: 3000  
Distances are in Metres

Plan of eight point zero seven three five hectares originally granted to WILLIAM JOHN SEELAR, showing a portion coloured pink and containing four point zero two six six hectares being the remainder after one previous transfer of another portion of the land.

In accordance with Regulations 25 (1) of the Land Surveyors Regulations 1998, I certify that this plan represents the remaining portion.

Entered by .....

Checked by HR-06/10/14

Trinidad & Tobago Land Surveyor ..... 21/06/2014