

REMAINING PORTION PLAN

R.P.O. Vol. 1 Fol. 435
C.T. Vol. 4386 Fol. 251

Ward of Savana Grande
County of Victoria
Cadastral Sheet G.9.P 64.B.
3/a

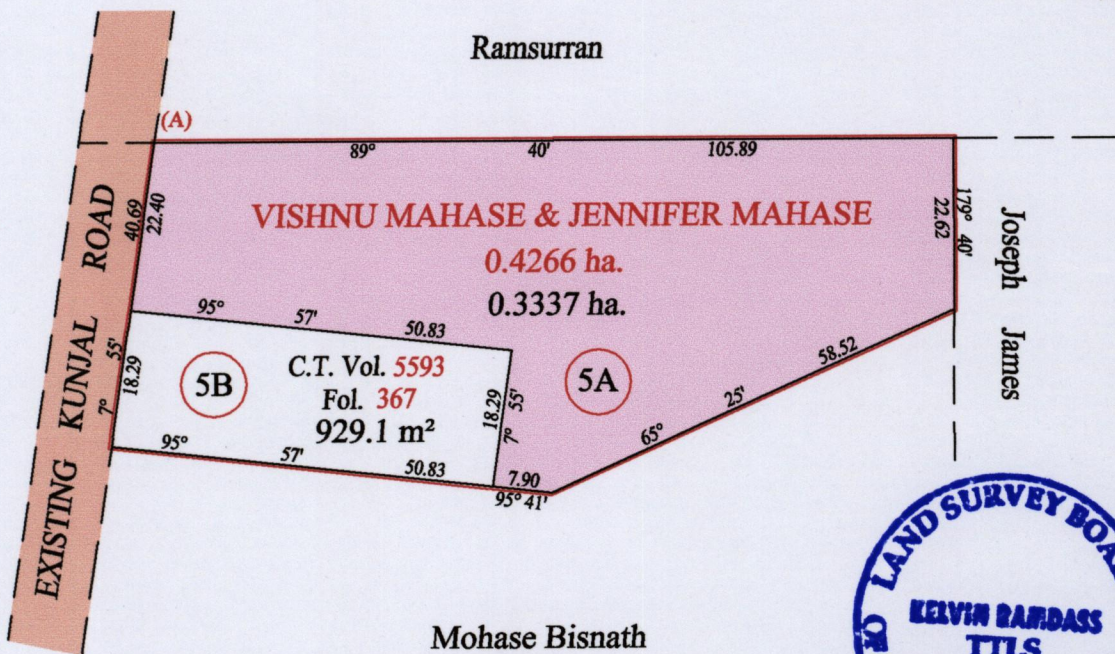
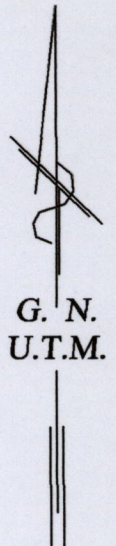

At Station (A)
E 0680402
N 1129263
Reading taken with
Handheld G.P.S.
U.T.M. Zone 20
Naparima
± 5 m.

Vide Bk. 327 fol. 96
Vide Bk. 327 fol. 120
Vide Bk. 718 fol. 60

Approved *[Signature]*
Director of Surveys 2/10/14

SCALE : 1:750

Note: Bearings are U.T.M. grid based on solar observations Distances are in metres
Plan of zero point four two six six hectare
originally transferred to Vishnu Mahase and Jennifer Mahase showing a portion
coloured pink and containing zero point three three three seven hectare
being the remainder after one (1) previous transfer of another portion of the land.
In accordance with Regulation 25(1) of the Land Surveyors Regulations 1998
I certify that this plan represents the remaining portion

Checked by *[Signature]*

Entered on Trinidad & Tobago Land Surveyor *[Signature]* 2014