

1654

834

RPO Vol 71 Fol 419
CT Vol 1228 Fol 409

Cadastral Sheet G.20.F., 74B
County of Victoria 2/d
Ward of Moruga

Refs. Bk 315 Fol 124, 138, 178
Bk 1124 Fol 197
Plans AF 33, RG 70, KH 34, QD 54
S.O.# 1203/1925
S.O.# 327/1910

Basseterre

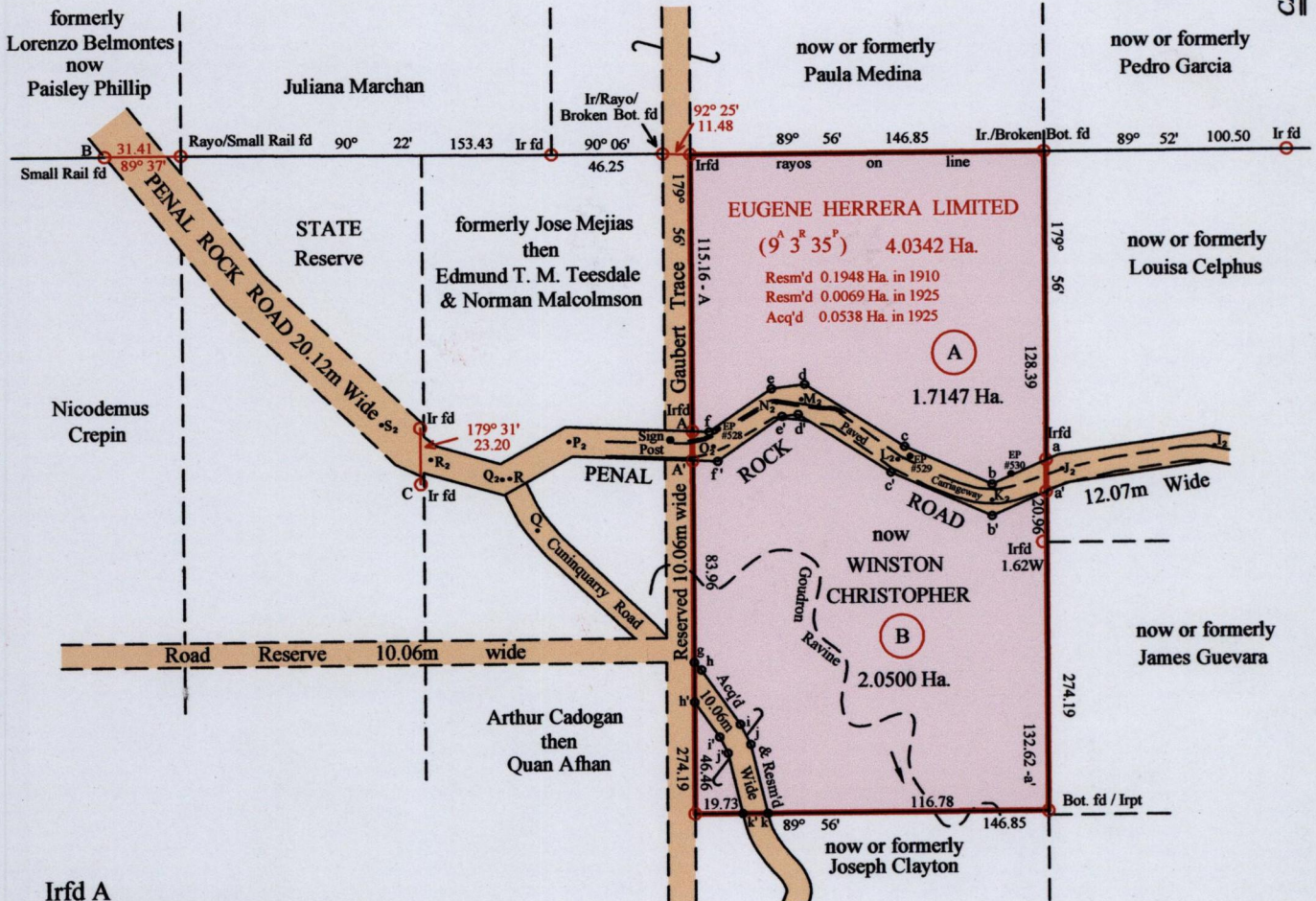

Irfd A
Hand-held GPS Coords.
UTM Zone 20, Naparima 1955
E 0684726 ±6m
N 1119849

Note: Cuninquiry Road was positioned by scanning, scaling and tracing.

B-C	136° 38'	188.98	a-a'	179° 56'	13.18	A-A'	179° 56'	12.09
a-b	246° 21'	24.67	a'-b'	246° 21'	24.71	g-h'	179° 56'	16.52
b-c	293° 46'	39.55	b'-c'	293° 46'	45.75	h-i'	144° 50'	17.89
c-d	302° 18'	48.92	c'-d'	302° 18'	45.52	i-j'	152° 52'	7.54
d-e	263° 06'	13.99	d'-e'	263° 06'	6.74	j'-k'	166° 28'	25.82
e-f	235° 40'	31.46	e'-f'	235° 40'	32.53	k'-k	89° 56'	10.34
f-A	272° 28'	6.87	f'-A'	272° 28'	10.35	g-h	137° 25'	4.35
						h-i	144° 50'	27.79
						i-j	152° 52'	9.44
						j-k	166° 28'	29.43

Original Survey BK. 315 fol. 124

Approved

Meela Mohammed
Director of Surveys 6/3/14

○ denotes Iron put except otherwise stated
Bearings are Cassini Grid based on Solar Obs.
Distances are in Metres
SCALE 1/3000

PLAN of two parcels of land coloured pink in the Ward of Moruga
Comprising together three point seven six four seven Hectares
Surveyed by me, with due authority, in August 2013.
Certified correct in accordance with Regulation 25 (1) of the Land Surveyors' Regulations 1998.

Checked by
Entered on

Meela Mohammed
Trinidad and Tobago Land Surveyor

17th Jan. 2014