

R.P.O Vol. 212 Fol. 177

C.T Vol. 1326 Fol. 13

Ref: Bk.722 Fol.211

Ward of Siparia
County of St. Patrick
Cadastral Sheet 73B
3/b & 3/d G.17.L

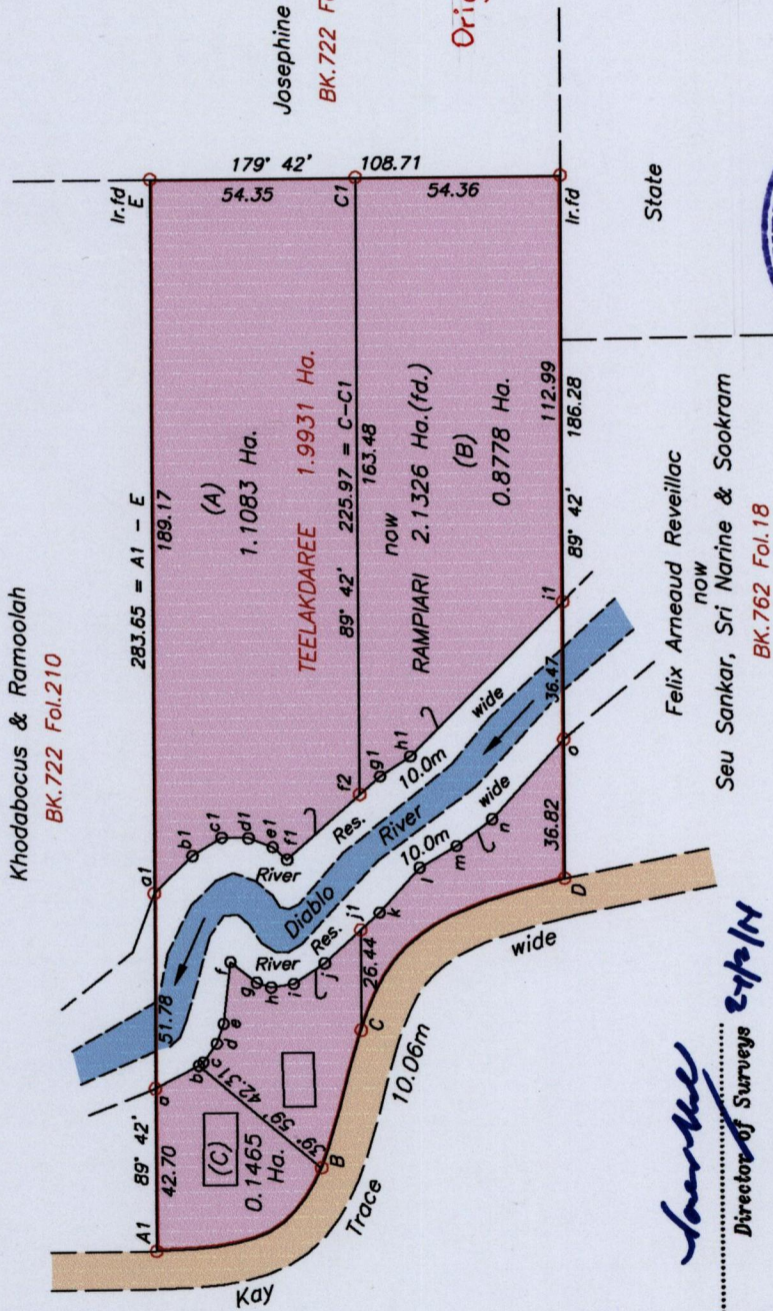

Khodabocus & Ramoolah
BK.722 Fol.210

Josephine Vialva
BK.722 Fol.209

Original Survey Bk. 722 :211

N 1117855
E 665745

Approved: *Sankar*
Director of Surveys 24/1/14

Note: U.T.M 20 Naperima (GPS +/- 3.0m)

- Denotes no mark found
- Denotes Iron put unless otherwise stated
- Bearings are U.T.M Grid based on solar observations
- To obtain Cassini bearings add 18 minutes

SCALE 1:2000
Distances are in METRES

PLAN of 3 Parcels of land coloured pink in the Ward of Siparia.

Containing together two point one three two six hectares.

Surveyed by me, with due authority, in July 2012.

Certified Correct in accordance with Regulation 25 (1) of the Land Surveyors Regulations 1998.

Checked by: *Marta Moolool*

Entered on: *February 19* 2014



FIELD NOTES	
A1	Ir.pt 48.58
	0 3.9
	7.5
	30.0
	20.0
	10.0
	0.0
B	Ir.pt 37.86
	0 1.0
	0.6
	10.0
	0.0
C	Ir.pt 286° 09'
	0 67.31
	60.0
	50.0
	40.0
	30.0
	20.0
	10.0
	0.0
D	Ir.pt 323° 34'
	0 4.6
	10.5
	11.5 (B)
	10.0
	7.5
	4.0
	0

LEGEND	
a - b	151° 43'
b - c	144° 15'
c - d	125° 56'
d - e	108° 43'
e - f	96° 17'
f - g	38° 14'
g - h	18° 37'
h - i	171° 09'
i - j	146° 45'
j - k	137° 26'
k - l	137° 26'
l - m	132° 00'
m - n	149° 47'
n - o	143° 30'
o - p1	132° 04'
p1 - q1	136° 25'
q1 - r1	149° 05'
r1 - s1	149° 05'
s1 - t1	01° 21'
t1 - u1	21° 33'
u1 - v1	40° 45'
v1 - w1	4° 99'
w1 - x1	137° 21'
x1 - y1	25.74
y1 - z1	138° 21'
z1 - g1	7.26
g1 - h1	146° 45'
h1 - i1	134° 57'
i1 - j1	57.44
j1 - k1	48.58
k1 - l1	153° 36'
l1 - m1	106° 09'
m1 - n1	37.86
n1 - o1	143° 34'
o1 - p1	67.31
p1 - q1	89° 42'
q1 - r1	36.05