

R.P.O Vol. 647 Fol. 259

C.T. Vol. Fol.

PROCESS ID # 81381

Ward of San Raphael

County of St. George

Cadastral Sheet D.10.I, 34F

References

Vide Bk. 610/184
1135/473

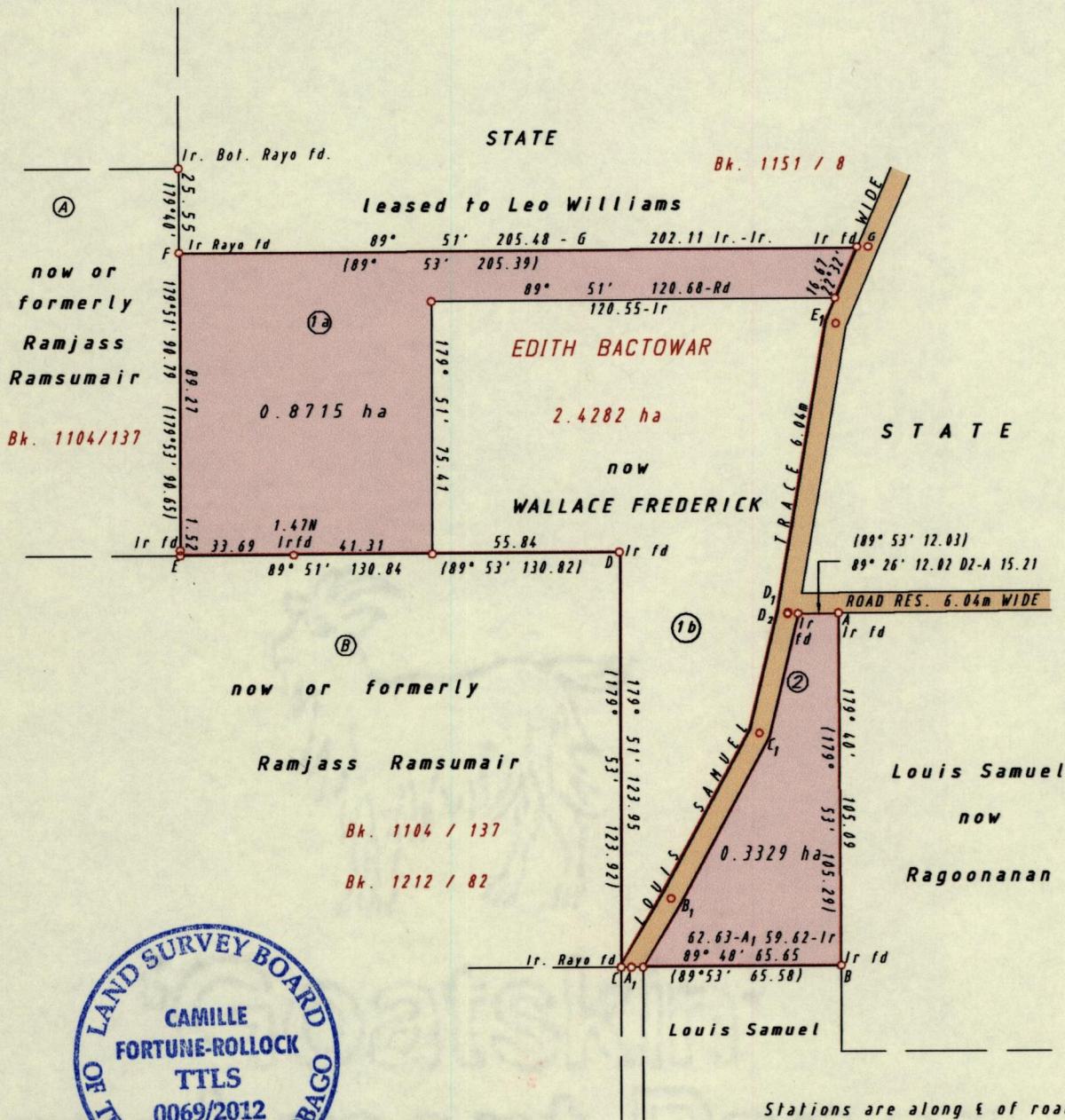
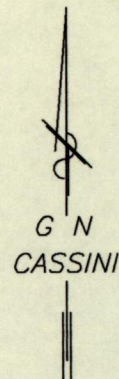

Original Survey Bk.610:184

Stations are along E of road

E ₁ - G	22° 44'	25.08
A ₁ - B ₁	30° 16'	23.62
B ₁ - C ₁	28° 15'	55.90
C ₁ - D ₁	13° 23'	36.87
C ₁ - D ₂	13° 23'	36.51
D ₁ - E ₁	9° 31'	87.49

o Denotes Iron put unless otherwise stated

Bearings are Cassini Grid based on Solar Obs.

SCALE 1 / 2000

Distances are in METRES

Approved

Camille Fortune-Rollock
Director of Surveys 20/1/14

PLAN of 2 Parcels of land coloured PINK in the Ward of San Raphael
Containing together one point two zero four four hectares
Surveyed by me, with due authority, in March 2001
In accordance with Regulation 25 (1) of the Land Surveyors Regulations 1998,
I certify that this Plan is correct.

Checked by NW 20.2.2014

Camille Fortune-Rollock

Entered on Trinidad & Tobago Land Surveyor. 26th January 2012