

1654

71

REMAINING PORTION PLAN

R.P.O. Vol. 21 Fol. 521

C.T. Vol. 262 Fol. 309

Process ID # 74570

Ward of Ortoire

County of Victoria

Cadastral Sheet H 1 E 54 F 2/a

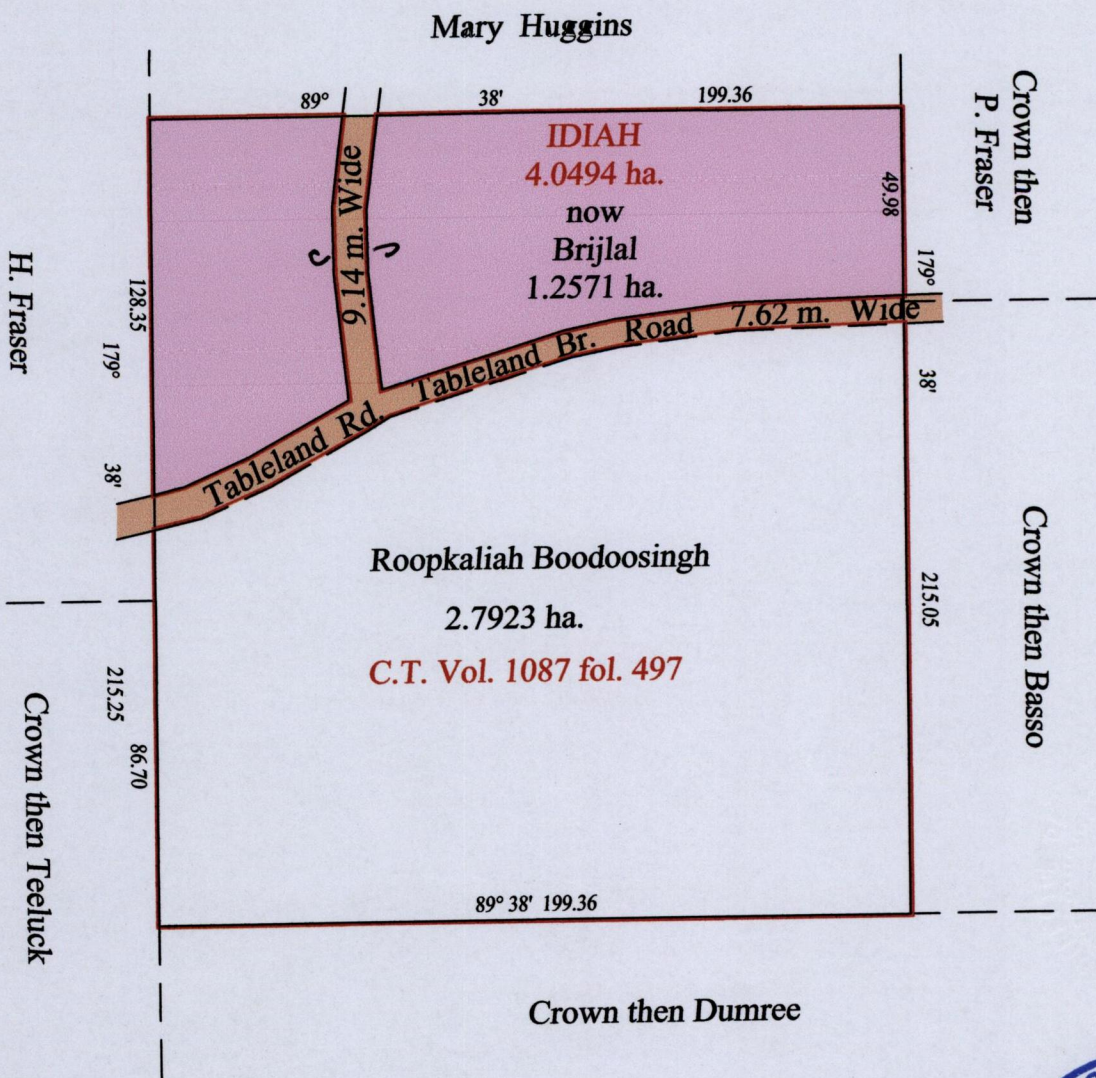

At Station (A)
 E 0689683
 N 1137322
 Reading taken with
 Handheld G.P.S.
 U.T.M. Zone 20
 Naparima
 ± 5 m.



Vide Bk. 868 fol. 152
 Vide Bk. 322 fol. 131 → for Original Survey

Approved *Harvech*
 Director of Surveys 18/2/14

SCALE : 1:2000

SEE BK. 1196:24

Note: Bearings are U.T.M. grid based on solar observations Distances are in metres
 Plan of four point zero nine four hectares
 originally transfered to Idiah, showing a portion
 coloured pink and containing one point two five seven one hectares
 being the remainder after one (1) previous transfer of another portion of the land.
 In accordance with Regulation 25(1) of the Land Surveyors Regulations 1998
 I certify that this plan represents the remaining portion

Checked by *MM. 21/1/2014*

Entered on Trinidad & Tobago Land Surveyor 17.12.2013