

PENAL

Ref. Bk 410 Fol 172

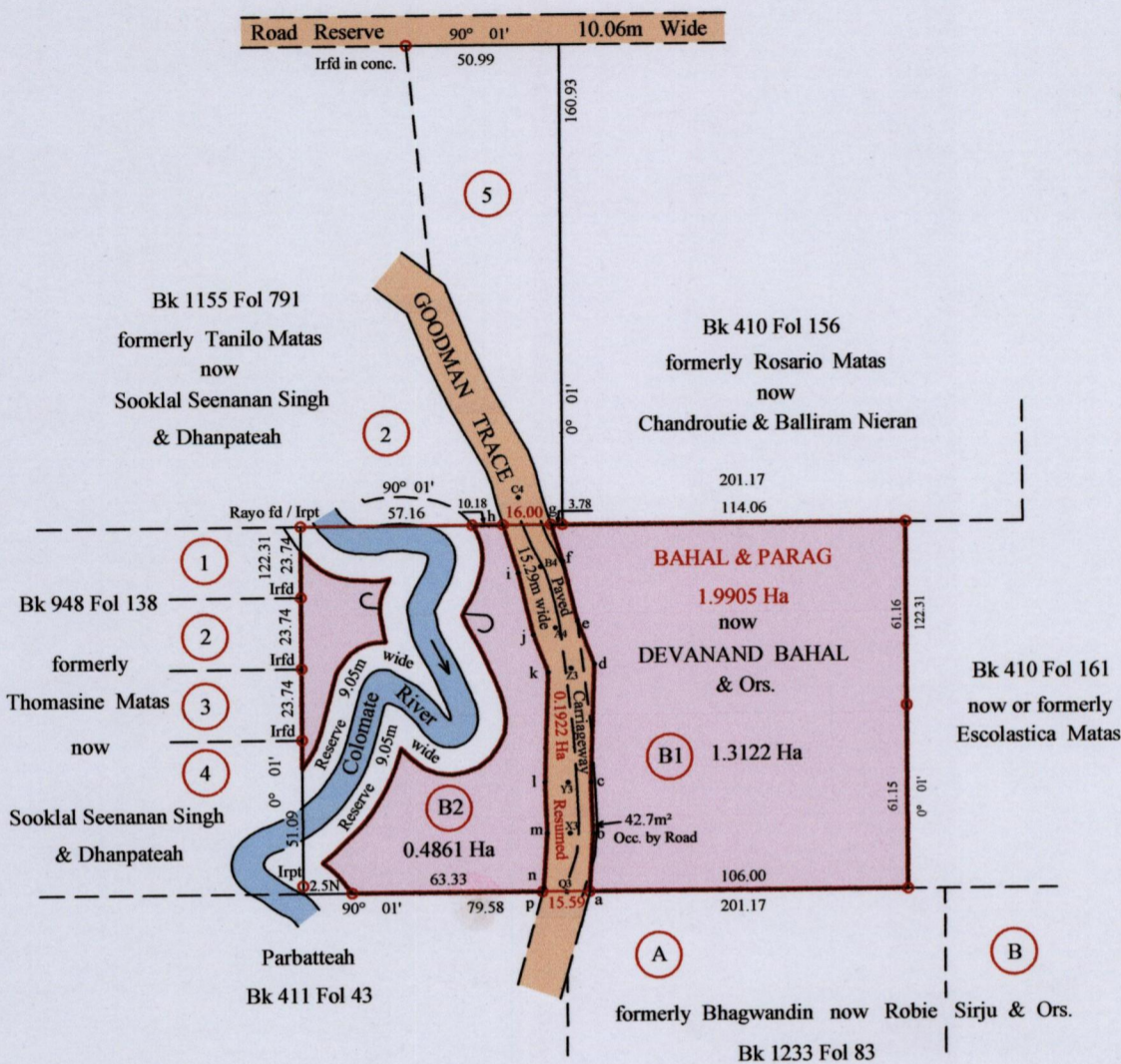
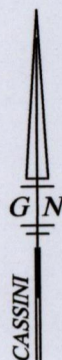

Original Survey Bk. 410: 172

Road Notes
Field Book Vol. 172 Fol. 39

P3 - Q3	15° 23'	26.96	a - b	3° 56'	19.41	p - n	15° 23'	1.33
Q3 - X3	03° 56'	19.55	b - c	358° 12'	17.13	n - m	3° 56'	18.40
X3 - Y3	358° 12'	17.00	c - d	2° 01'	39.21	m - l	358° 12'	16.87
Y3 - Z3	02° 01'	37.90	d - e	338° 56'	15.47	l - k	2° 01'	36.59
Z3 - A4	338° 56'	14.44	e - f	346° 51'	20.73	k - j	338° 56'	13.41
A4 - B4	346° 51'	21.00	f - g	342° 54'	12.57	j - i	346° 51'	21.27
B4 - C4	342° 54'	24.44				i - h	342° 54'	16.76

Note : River Course obtained by scanning, scaling and tracing.
Area of B2 derived using CAD software.

Rayo fd / Irpt
Hand-held GPS Coords.
UTM Zone 20, Naparima 1955
E 0671443 ± 5m
N 1122557

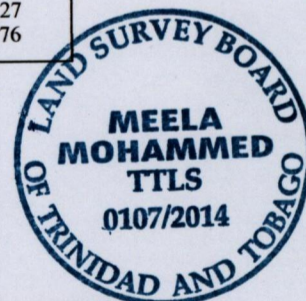

Approved

[Signature]

Director of Surveys

○ denotes Iron put except otherwise stated
Bearings are Cassini Grid based on Solar Obs.
Distances are in Metres
SCALE 1/2500

PLAN of two parcels of land coloured pink in the Ward of Siparia
Comprising together one point seven nine eight three Hectares
Surveyed by me, with due authority, in February 2013 .
Certified correct in accordance with Regulation 25 (1) of the Land Surveyors' Regulations 1998.

Checked by
Entered on

Meela Mohammed
Trinidad and Tobago Land Surveyor

6th Jan. 2014