

R.P.O. Vol. 61 Fol. 493  
C.T. Vol. 5004 Fol. 123  
PROCESS ID # G1888

Ward of Siparia  
County of St. Patrick  
Cadastral Sheet ( G.13.M ) 63 E  
4/d

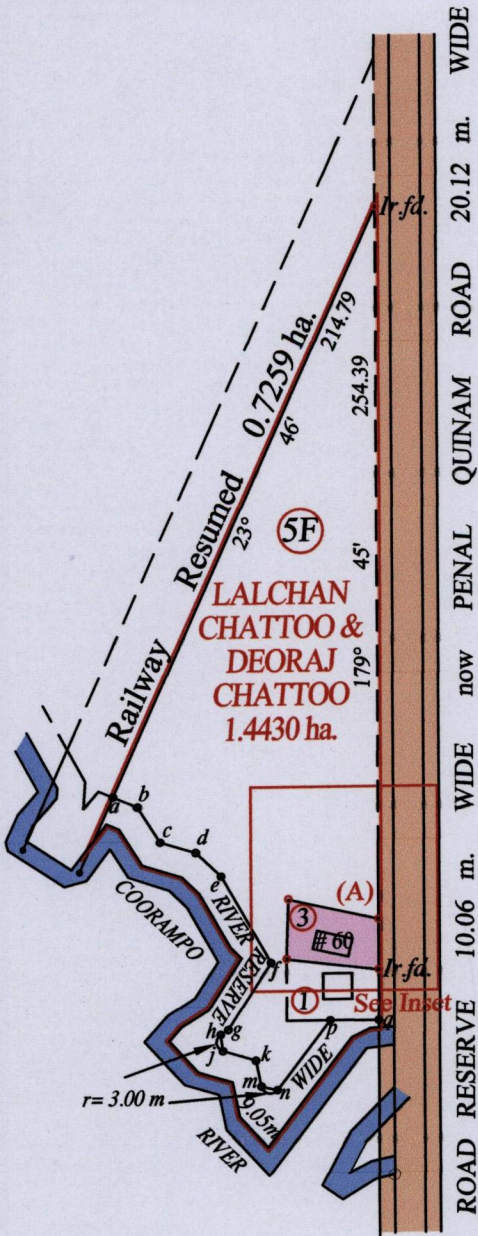

Line	Bearing	Distance
a - b	112° 49'	8.74
b - c	147° 33'	13.91
c - d	106° 55'	12.28
d - e	133° 30'	11.52
e - f	150° 13'	33.15
f - g	212° 28'	26.27
g - h	57° 43'	3.02
h - j	172° 02'	5.47
j - k	106° 22'	11.33
k - m	168° 20'	8.80
m - n	102° 55'	5.47
n - p	37° 24'	28.89
p - q	89° 45'	16.00

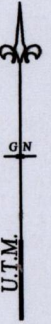
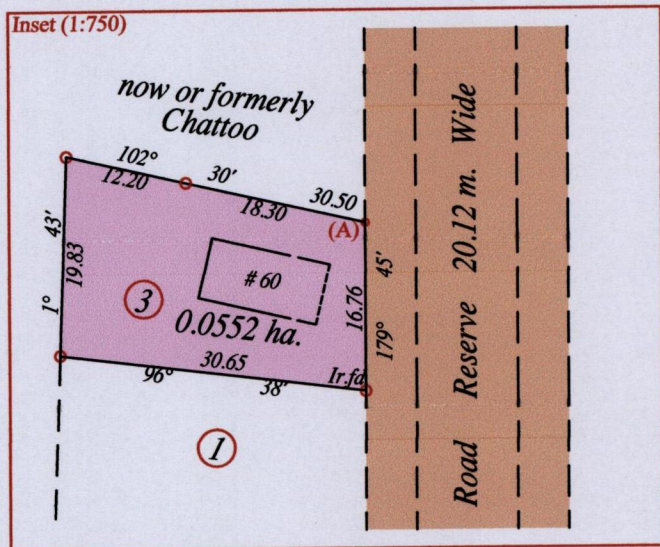

Approved .....  
Director of Surveys *[Signature]* 12/2/14

At Station (A)  
E 0667658  
N 1123264  
Reading taken with  
Handheld G.P.S.  
U.T.M. Zone 20  
Naparima  
± 5 m.



Original → Vide Bk. 935 fol. 3  
Vide Bk. 1256 fol. 139

o Denotes Iron put except stated otherwise.  
Note: Bearings are U.T.M. grid based on solar observations  
PLAN of a Parcel of land coloured pink in the Ward of Siparia  
Containing zero point zero five five two hectares  
Surveyed by me, with due authority, in May 2009  
Certified Correct in accordance with Regulation 25(1) of the Land Surveyors Regulations 1998

SCALE : 1:2500

Distances are in metres

Checked by ..... *[Signature]*

Entered on ..... Trinidad & Tobago Land Surveyor ..... 3.10.2013