

R.P.O. Vol. 124 Fol. 229
C.T. Vol. 2298 Fol. 245

Ward of Siparia.
County of St. Patrick.
Cadastral Sheet G.17.B. 73 A
2/b

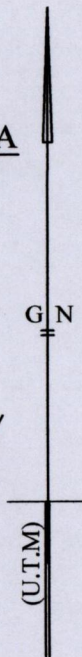
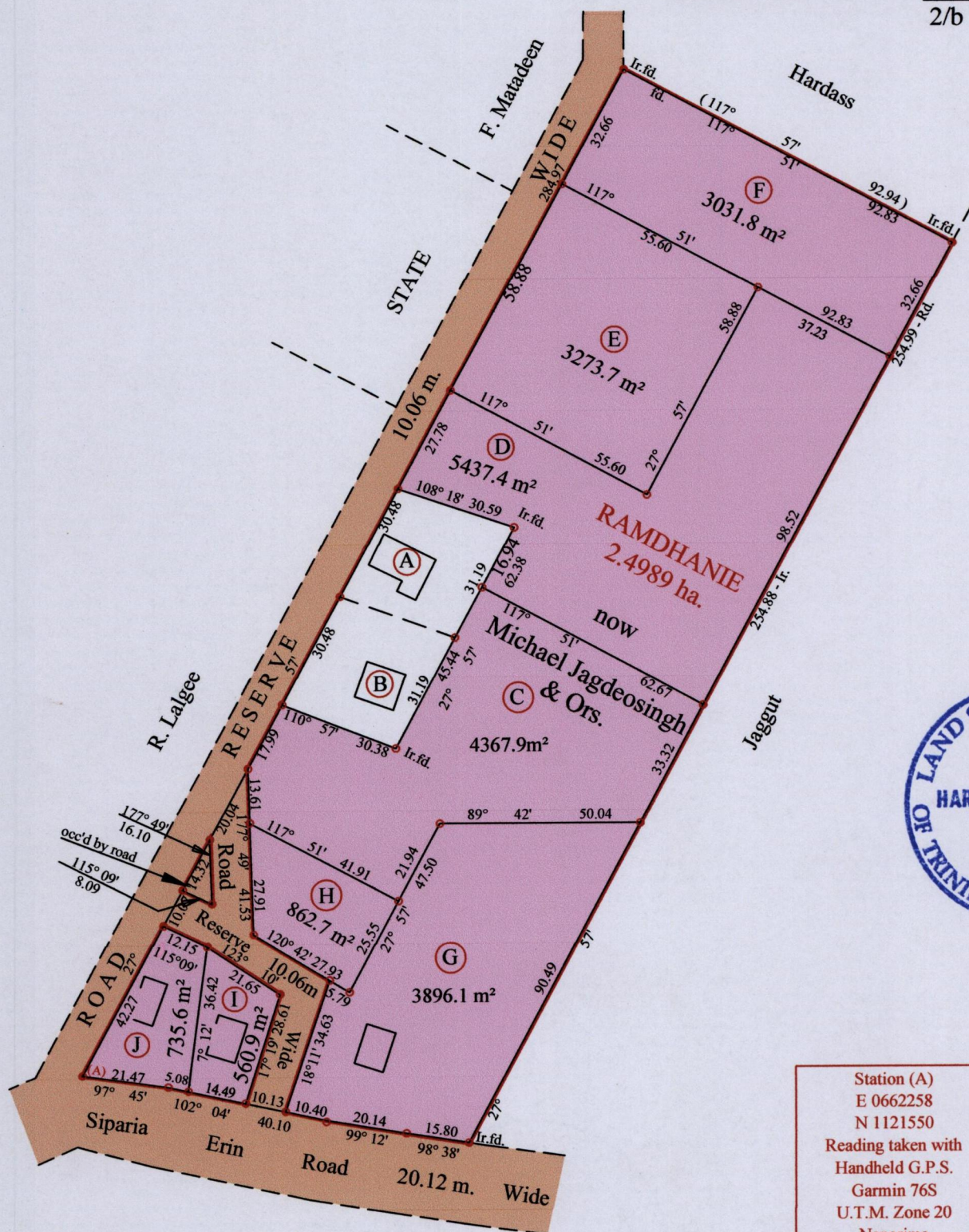

Station (A)
E 0662258
N 1121550
Reading taken with
Handheld G.P.S.
Garmin 76S
U.T.M. Zone 20
Naparima
±10m

Approved
Director of Surveys *27/1/11*

Vide Bk. 470 Fol. 157 for Original

○ Denotes Iron put except stated otherwise.

SCALE : 1:1500

Note: Bearings are U.T.M. grid based on solar observations Distances are in metres

PLAN of 8 Parcels of land coloured pink in the Ward of Siparia.
Containing together two point two one six six hectares
Surveyed by me, with due authority, in August 2005 & October 2006 for Kawal Baal & Ors.
Certified Correct in accordance with Regulation 25 (1) of the Land Surveyors' Regulations 1998,

Checked by *[Signature]*

Entered on Trinidad & Tobago Land Surveyor (TTLS) *4.01.2013*