

R.P.O. Vol. 14 Fol. 449
C.T. Vol. 1721 Fol. 55

Ward of Naparima
County of Victoria

Cadastral Sheet G.13.B $\frac{63C}{3/c}$ & $\frac{63F}{1/a}$

G. N.
U.T.M.

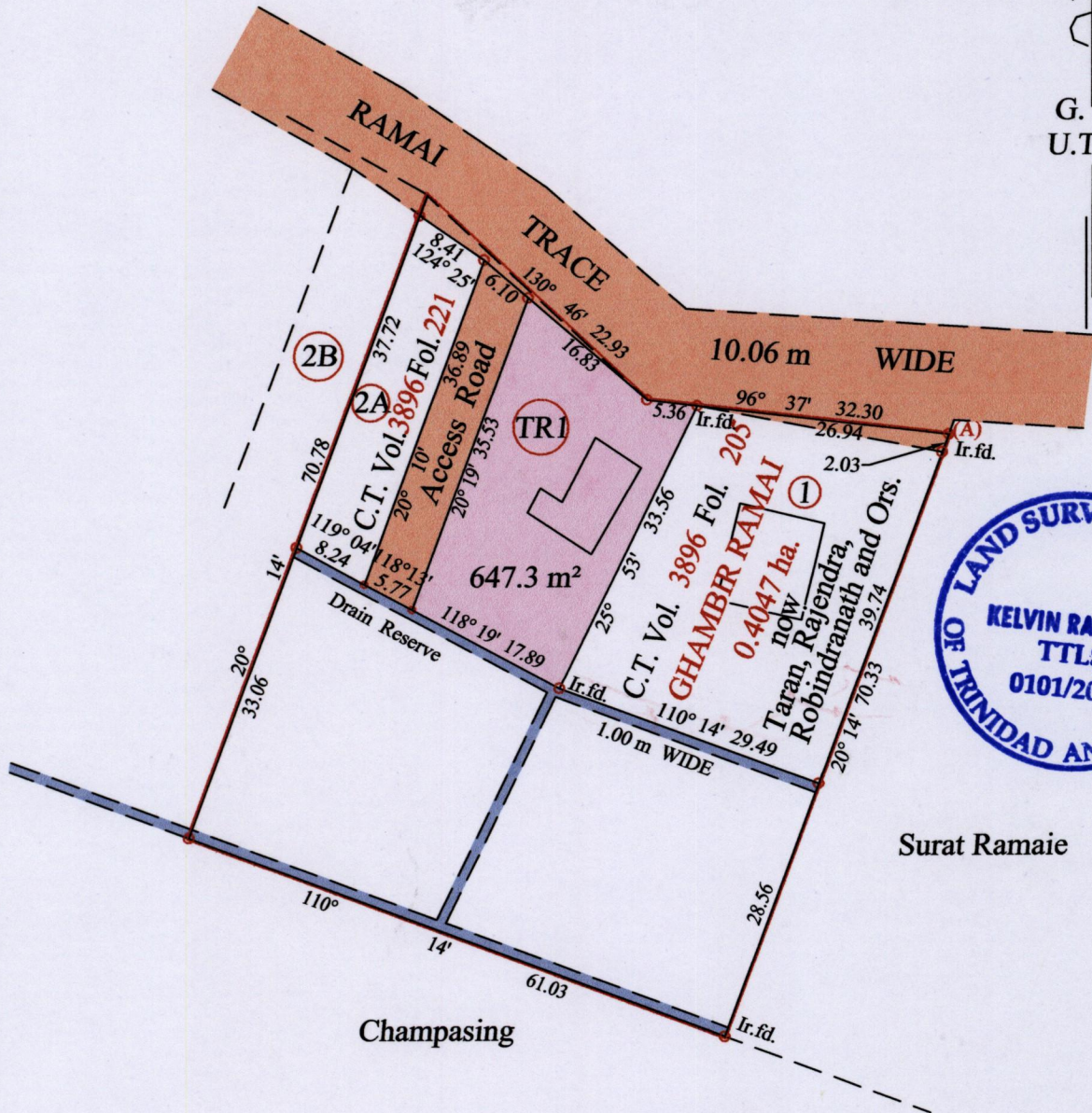

Original Survey → Vide Plan B.A.11
Vide Bk. 1238 fol. 30

Approved *[Signature]*
Director of Surveys 16/1/14

At Station (A)
E 0695610
N 1127570
Reading taken with
Handheld G.P.S.
U.T.M. Zone 20
Naparima
± 5 m.

○ Denotes Iron put except stated otherwise. SCALE : 1:750
 Note: Bearings are U.T.M. grid based on solar observations Distances are in metres
 PLAN of a parcel of land coloured pink in the Ward of Naparima
 Containing six hundred and forty seven point three square metres
 Surveyed by me, with due authority, in May 2013
 Certified Correct in accordance with Regulation 25(1) of the Land Surveyors Regulations 1998

Checked by *[Signature]* 9/1/2014

Entered on Trinidad & Tobago Land Surveyor 03/08/2013