

R.P.O. Vol. 148 fol. 609

C. T. Vol. 722 fol. 445

U. P. R. N.

REMAINING PORTION

Cadastral Sheet 73A, G.17.A  
1/d & 2/c

Ward of Siparia

County of St. Patrick

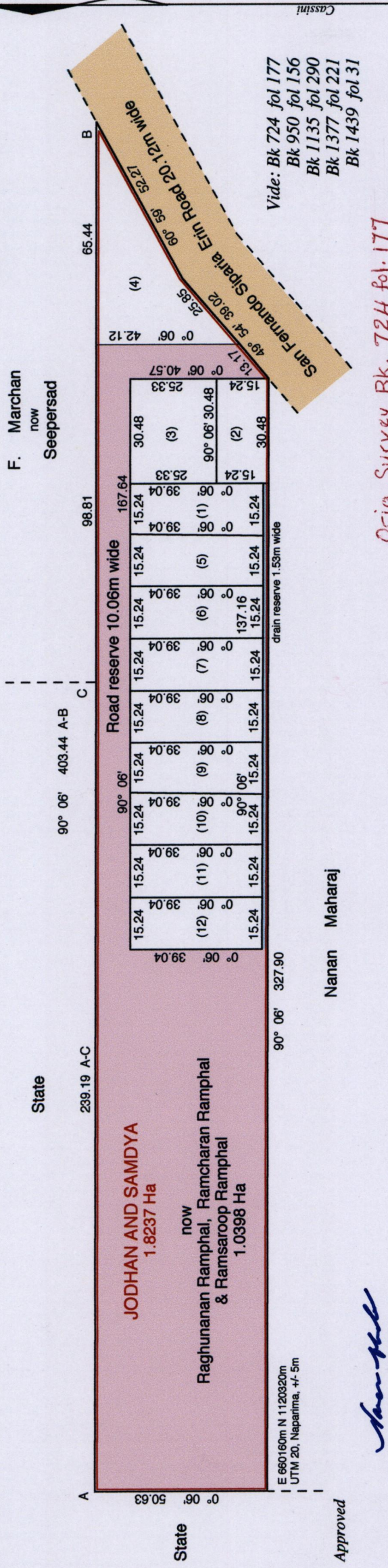

Nanan Maharaj

Approved  
*[Signature]*  
Director of Surveys 16/1/14

SCALE 1 : 1500  
Distances are in metres  
Bearings are Cassini Grid

PLAN of one point eight two three seven hectares originally transferred to JODHAN & SAMDYA

showing a portion coloured pink and containing one point zero three nine eight hectares

being the remainder after twelve (12) previous transfers of other portions of the land.

In accordance with Regulation 25(1) of the Land Surveyors' Regulations of 1998,

I certify that this plan represents the remaining portion.

Checked by: *[Signature]* 10/1/2014

Entered on .....

Trinidad & Tobago Land Surveyor

20th November 2013

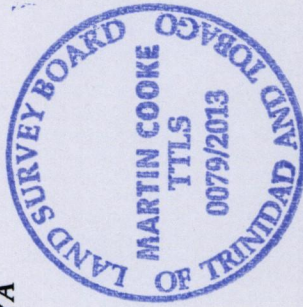

Orig Survey Bk. 724 fol. 177

- Lot (1) 595.0 sq m Raghunanan Ramphal & oths CT 4931 fol 117
- Lot (2) 464.5 sq m Bhagwandaye Ramphal & oths CT 4931 fol 133
- Lot (3) 772.0 sq m Nicholas & Jason Ramphal CT 4931 fol 109
- Lot (4) 1247.7 sq m Ramsaroop Ramphal & oths CT 4931 fol 125
- Lot (5) 595.0 sq m Ramcharan Ramphal & oths CT 5231 fol 133
- Lot (6) 595.0 sq m Lutchan Ramphal & oths CT 5231 fol 141
- Lot (7) 595.0 sq m Dexter & Renuca Ramphal CT 5263 fol 121
- Lot (8) 595.0 sq m Nigel Ramphal CT 5263 fol 129
- Lot (9) 595.0 sq m Kubair & Nadira Ramphal CT 5263 fol 137
- Lot (10) 595.0 sq m Doododhan & Leela Ramphal CT 5263 fol 145
- Lot (11) 595.0 sq m Nandoo Ramphal & oths CT 5263 fol 153
- Lot (12) 595.0 sq m Indra & Hemma Ramphal CT 5263 fol 161

1654

29