

R.P.O. Vol. fol.  
C.T. Vol. 5289 fol. 401

Ward of Siparia  
County of St. Patrick  
Cadastral Sheet G.12 L. 63 E  
2/a

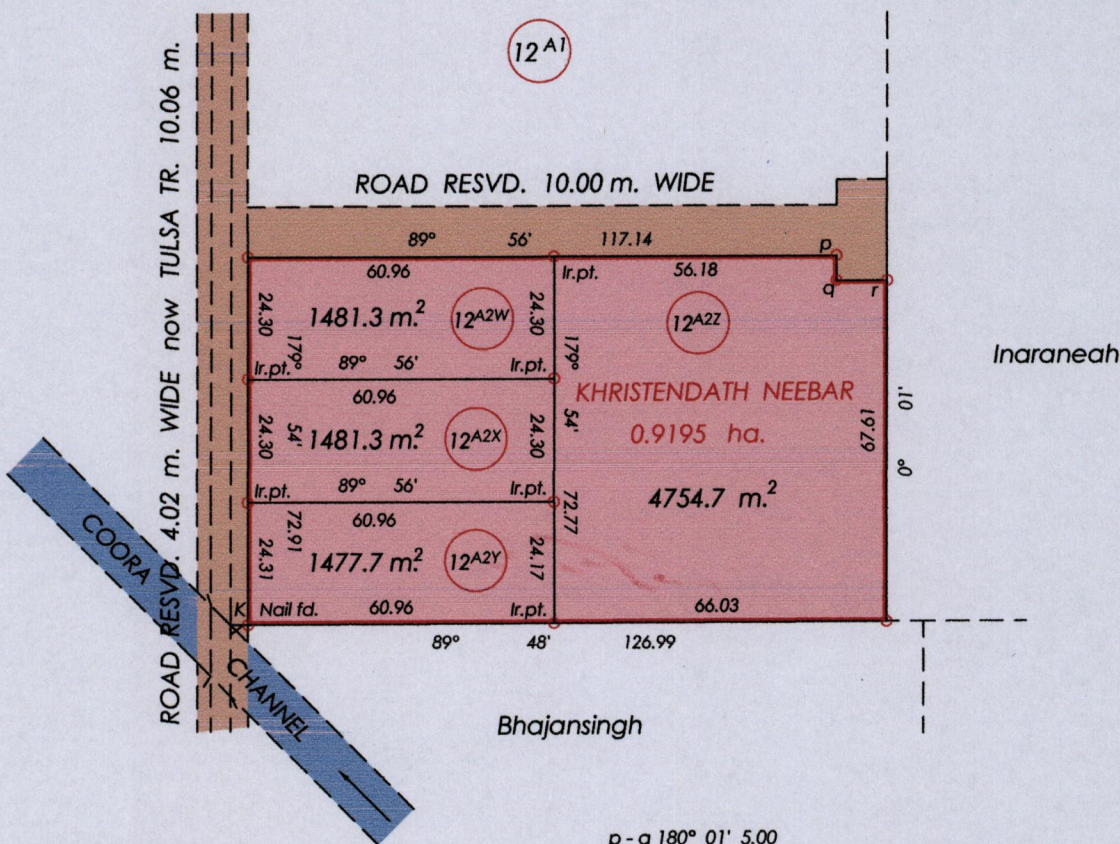

p-q 180° 01' 5.00  
q-r 89° 56' 10.00

K = N. 1126735 E. 666706  
U.T.M. Zone 20 Naparima +/- 5.00 m.  
Hand Held G.P.S.

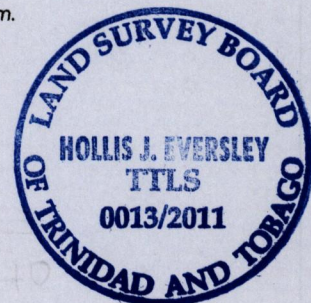

Orig Survey Bk. 964:40

Vide Plan P. G. 54

Approved *[Signature]*  
Director of Surveys 19/11/13

○ Denotes Iron found Except  
Otherwise Stated

SCALE : 1 : 1500

Note: Bearings are cassini grid based on solar observations Distances are in metres  
PLAN of 4 Parcels of land coloured pink in the Ward of Siparia  
Containing nine thousand one hundred and ninety five sq. metres  
Surveyed by me, with due authority, in May 2010  
In accordance with Regulation 25 (1) of the Land Surveyors' Regulations 1998,  
I certify that this plan is correct.

Checked by *[Signature]*

Entered on ..... Trinidad & Tobago Land Surveyor *[Signature]* 2011