

U.P.R.N

R.P.O. Vol. 64 Fol. 367

C.T. Vol. 1990 Fol. 111

A - 669701mE, 1125605mN
UTM ZONE 20, Naparima (+/- 5.00M)
Direct Observation-GPS Hand held

Cadastral Sheet G.13.F., 63F
I/c

Ward of Siparia

County of St. Patrick

Bk: 903 Fol: 10

S.O. Notes: 1321/1899

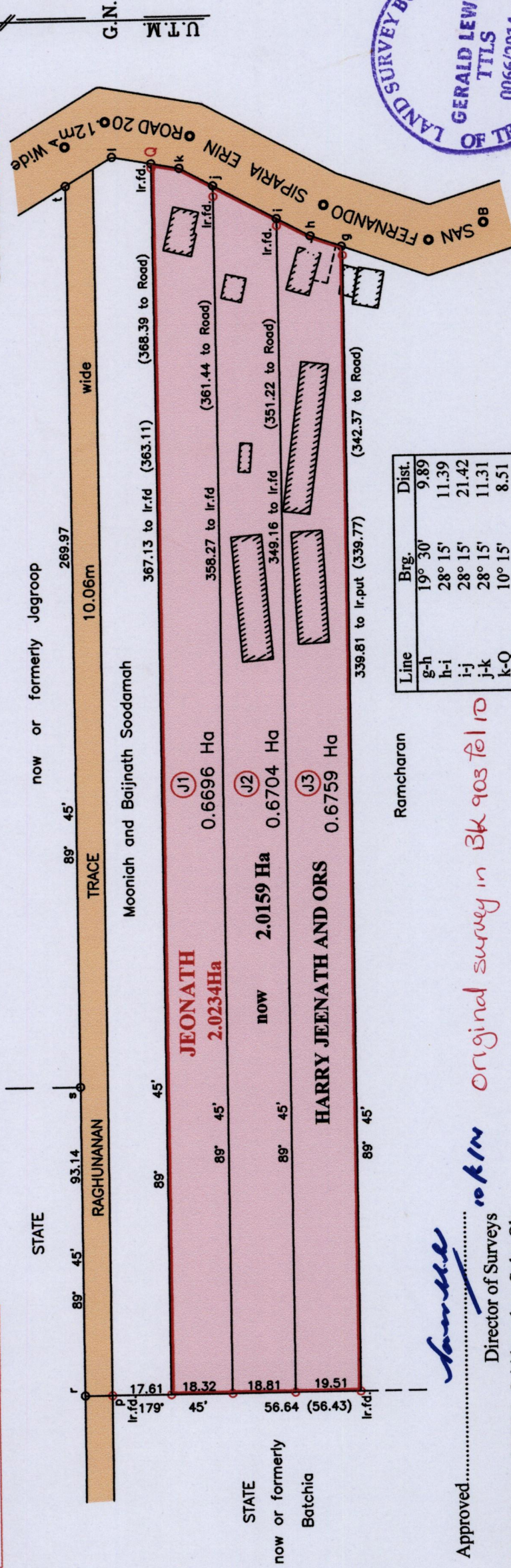

| Line | Brg. | Dist. |
|------|----------|-------|
| g-h | 19° 30' | 9.89 |
| h-i | 28° 15' | 11.39 |
| i-j | 28° 15' | 21.42 |
| j-k | 28° 15' | 11.31 |
| k-Q | 10° 15' | 8.51 |
| Q-I | 10° 15' | 11.88 |
| I-t | 329° 05' | 16.32 |
| t-p | 179° 45' | 10.06 |
| t-A | 89° 45' | 11.06 |

Approved.....
Director of Surveys
Bearings are U.T.M. Grid based on Solar Obs
O Denotes Iron Put unless otherwise stated
PLAN of 3 Parcels of land coloured pink in the Ward of Siparia
Containing together two point zero one five nine hectares
Surveyed by me, with due authority, in January 2013
Certified Correct in accordance with Regulation 25(1) of the Land Surveyors Regulations 1998

Entered on
Checked by

SCALE 1:1500
Distances are in Metres

Gerald Lewis
Trinidad & Tobago Land Surveyor

25/05/2014

1654

213

