

R.P.O. Vol. 12 Fol. 169
C.T. Vol. 4456 Fol. 151

Ward of Siparia
County of St. Patrick
Cadastral Sheet G.12.E & I, $\frac{63D}{4/a}$

Coordinates
Ir.fd. X : N 1124516
E 661171

Parcel Address: No.26 Fyzabad Guapo Road,
Fyzabad.

Error Statement : $\pm 4m$
Datum Definition :
U.T.M. Zone 20 Naparima
Magellan Hand Held GPS

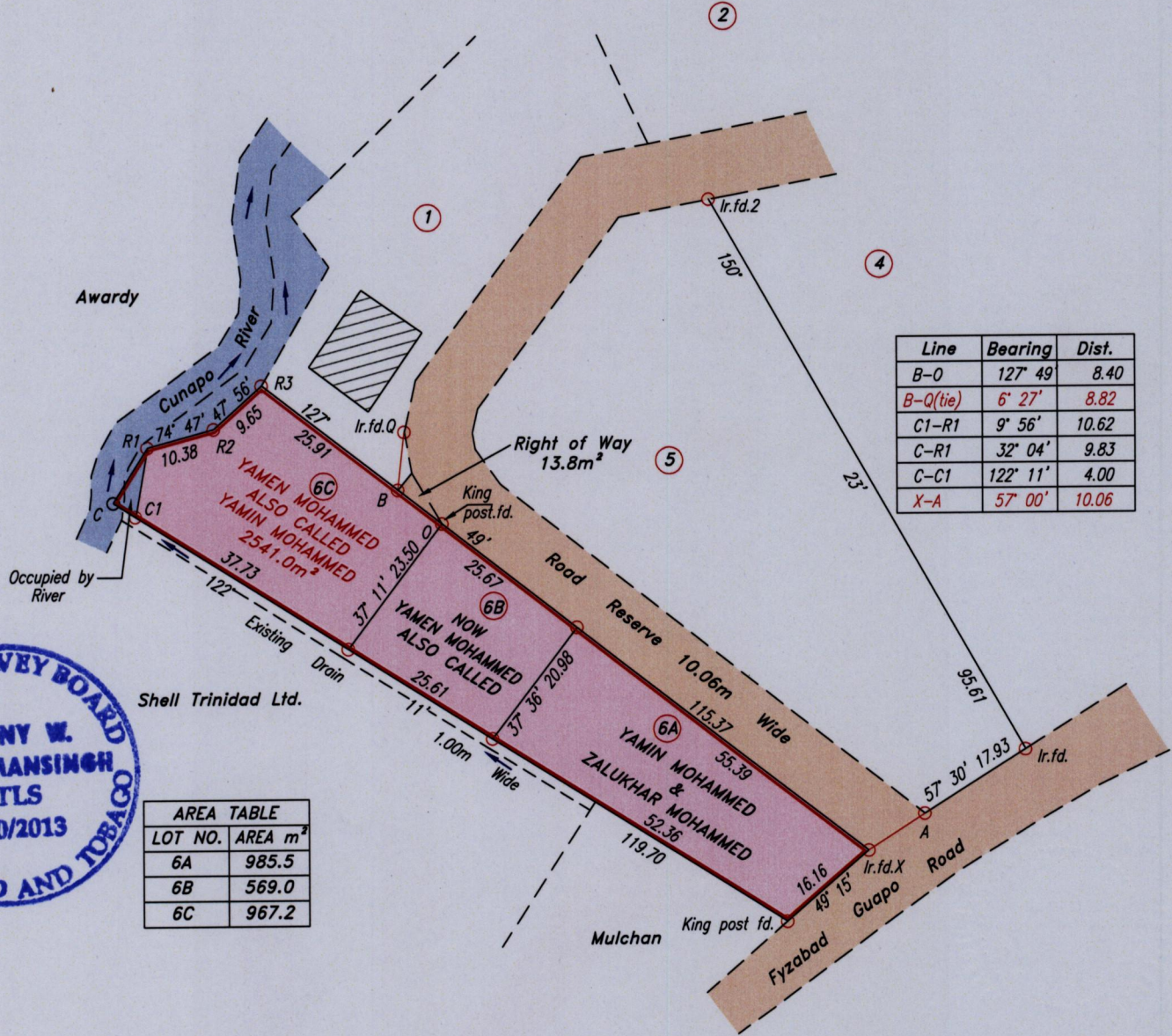
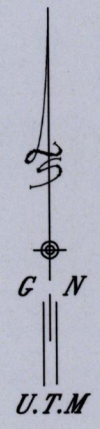

Line	Bearing	Dist.
B-0	127° 49'	8.40
B-Q(tie)	6° 27'	8.82
C1-R1	9° 56'	10.62
C-R1	32° 04'	9.83
C-C1	122° 11'	4.00
X-A	57° 00'	10.06

AREA TABLE	
LOT NO.	AREA m ²
6A	985.5
6B	569.0
6C	967.2



Approved *[Signature]*
Director of Surveys 16/11/13

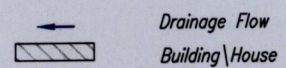

Ref: Bk. 1282 Fol. 188 fol: Original
SCALE 1 : 1000

○ Denotes Iron put except stated otherwise.
Bearings are U.T.M. Grid based on Solar Observations. Distances are in metres
Plan of three Parcels of land coloured pink in the Ward of Siparia
Containing altogether two thousand five hundred and twenty one point seven square metres.
Surveyed by me with due authority, in November 2012
Certified correct in accordance with Regulation 25 (1) of the Land Surveyors
Regulations 1998.

Checked by
Entered by Trinidad & Tobago, Land Surveyor..... 11/12/2013.