

R.P.O. Vol.188 Fol. 515
C.T. Vol. 3494 Fol. 527

Cadastral Sheet G.17.C 73B
Ward of Siparia 1/b,1/d
County of St. Patrick

Bk.482 Fol.158
Bk.1200 Fol.82
Bk.1386 Fol.183
Plan J.S.23

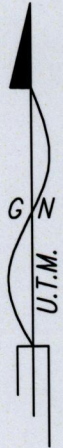

REMAINING PORTION

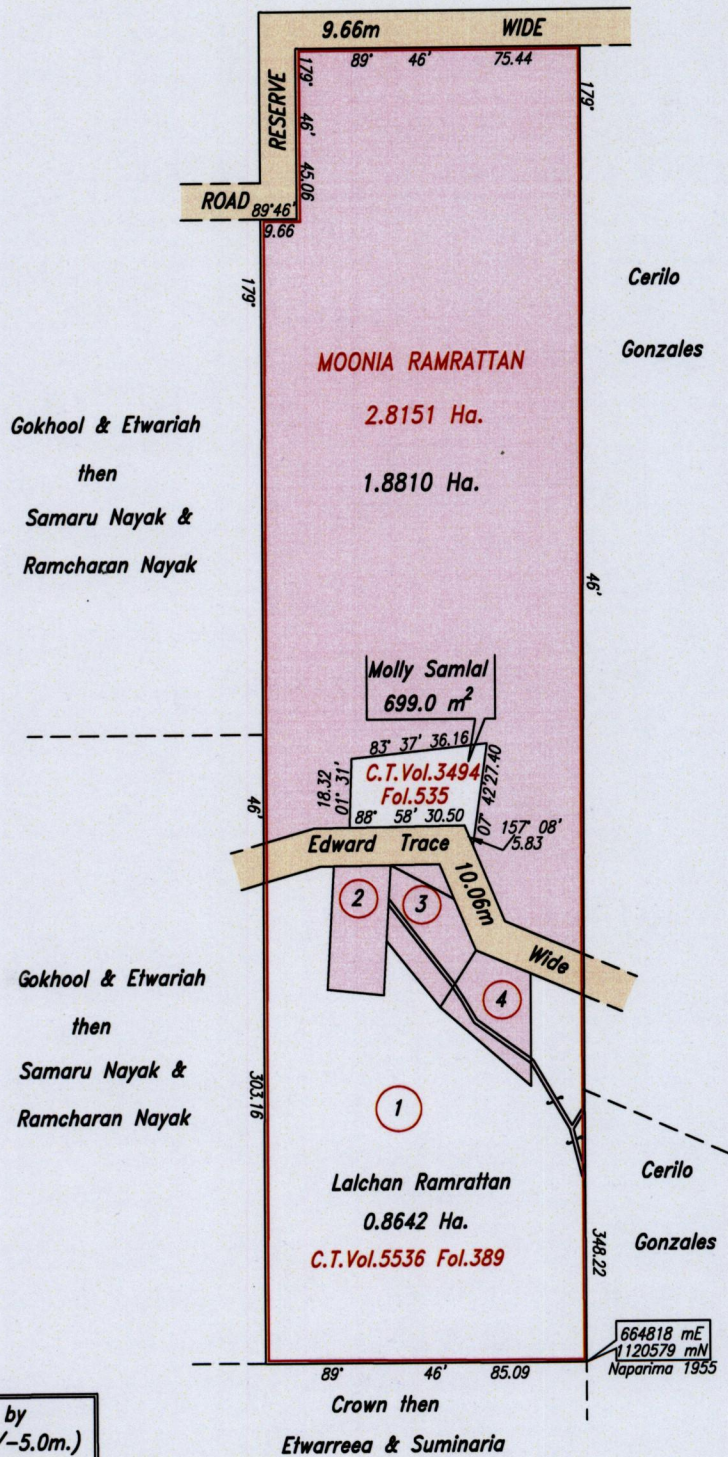

Note :
Coordinates obtained by
hand held G.P.S. (+/-5.0m.)
For Identification only

SCALE 1:2000
Distances are in metres

Approved *[Signature]*
Director of Surveys 61614

original Bk. 482 fol. 158

PLAN of two point eight one five one hectares originally transferred to MOONIA RAMRATTAN
Showing a portion coloured pink and containing one point eight eight one zero hectares
Being the remainder after two previous transfers of other portions of the land.
In accordance with Regulation 25 (1) of the Land Surveyors' Regulations 1998,
I certify that this plan represents the remaining portion.

Checked by *[Signature]* 29/5/2014

Entered on Trinidad & Tobago Land Surveyor. 21st May 2014.
PATH=ADA004 C:/DEO/SAMAROO RAMNATHA REMAINING PORTION DWG.