

R.P.O. Vol. 169 Fol. 387
C.T. Vol. 5080 Fol. 47

Ward of Siparia
County of St. Patrick
Cadastral Sheet (G7N) 63 A
4/d

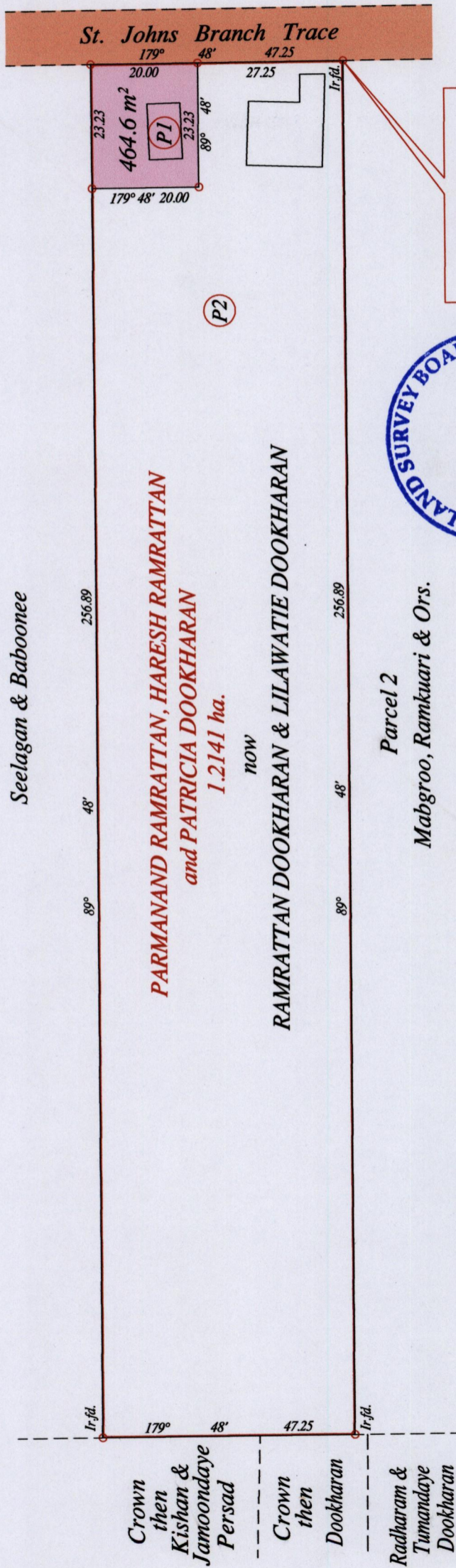

E 0662165
N 1127912
Reading taken with
Handheld G.P.S.
U.T.M. 20 Napparima
+ 5m.



Parcel 2
Mabgoo, Ramkuari & Ors.

SCALE : 1:1000

Note: Bearings are U.T.M. grid based on solar observations Distances are in metres

PLAN of a Parcel of land coloured pink in the Ward of Siparia
Containing four hundred and sixty four point six square metres
Surveyed by me, with due authority, in May 2013
Certified correct in accordance with Regulation 25 (1) of the Land Surveyors Regulations 1998.

Approved
Director of Surveys *W. Ramcharan*

o Denotes Iron put except stated otherwise.

Checked by *Winston Ramcharan*

Entered on Trinidad & Tobago Land Surveyor *21st May 2014*

Bk. 918 Fol. 22
orig. Bk. 1005 Fol. 118
Plan F.A. 159

1654

2011