

1654

1783

R.P.O. Vol. Fol.
C.T. Vol. 2376 Fol. 123
Process Id # G1790

Cadastral Sheet (B.20.M.&B.25.A) 24C
Ward of Arima
County of St. George

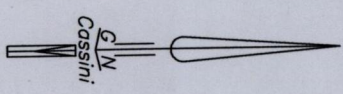
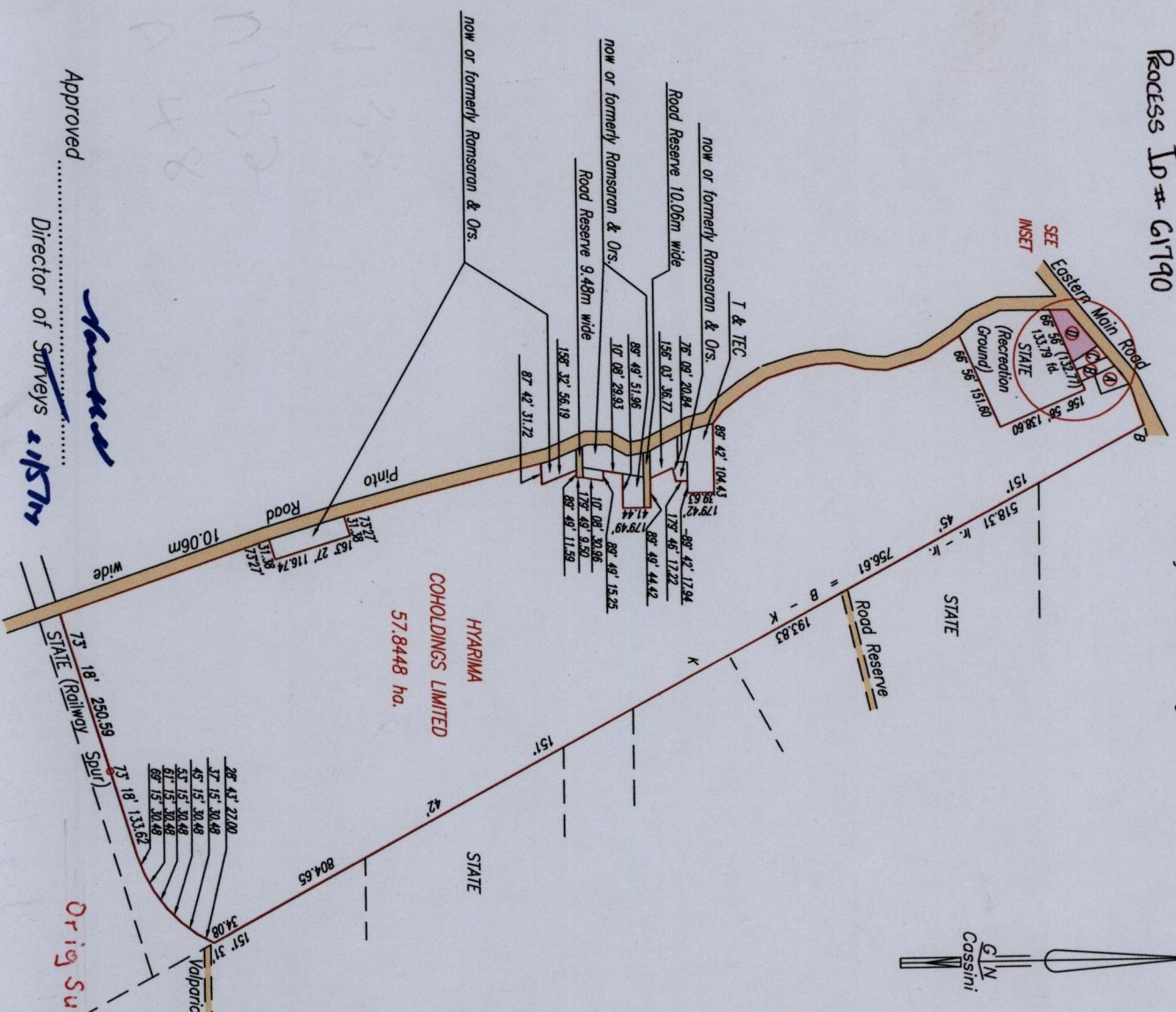

H - E1	320'	52'	8.23
E1 - E	50'	52'	17.71
E - F	230'	52'	152.99
E1 - E2	230'	52'	82.86
M - E2	320'	52'	3.63
F - G	235'	45'	82.18 (N.T.S.)
B - I	230'	52'	5.00
B - O	314'	45'	5.46

INSET
SCALE 1/1000
Distances are in metres

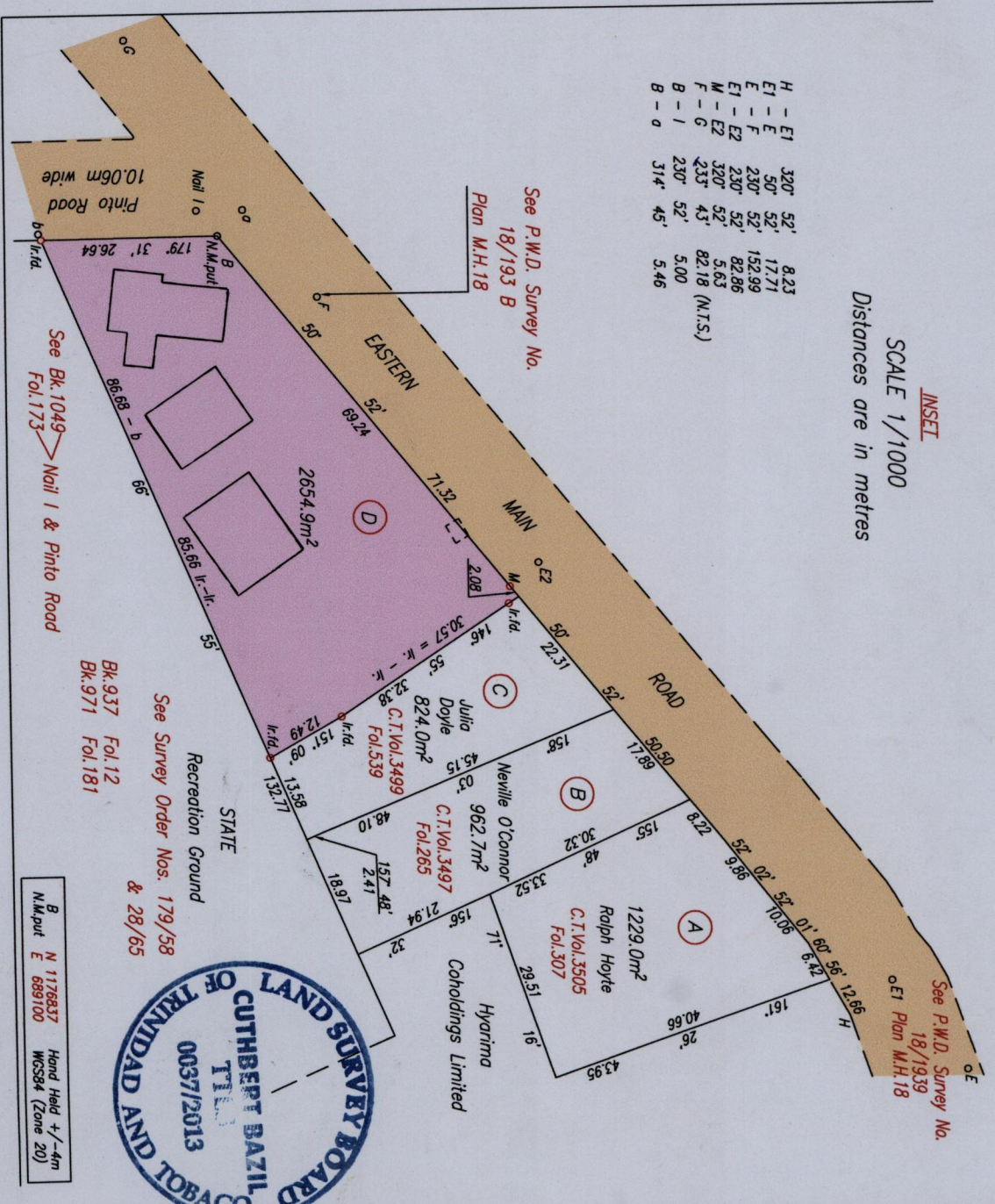

See G.A.48

Note: To obtain compass bearings add 11 minutes
Denotes iron put except otherwise stated

SCALE 1/10,000
Distances are in metres

Bearings are Cassini Grid based on Solar Observations
Plan of a Parcel of land coloured pink in the Ward of Arima
Containing two thousand six hundred and fifty four point nine square metres
Surveyed by me, with due authority, on 5th September 1986 for Hyarima Holdings Limited
Certified Correct in accordance with Regulation 25 (1) of the Land Surveyors' Regulations 1998,
Entered on

Orig Survey Bk. 997:199

Checked by: mm. 3/5/2013
Trinidad & Tobago Land Surveyor . 16th . January . 2013

Approved
Director of Surveys