

165 1654

166

R.P.O. Vol. 197 Fol. 193  
C.T. Vol. 1120 Fol. 341  
Process ID # 79201

Ward of Siparia  
County of St. Patrick  
Cadastral Sheet G.13.K.  $\frac{63 F}{3/b}$



Chandoo & Jamoortee  
Vide Bk. 408 fol. 259

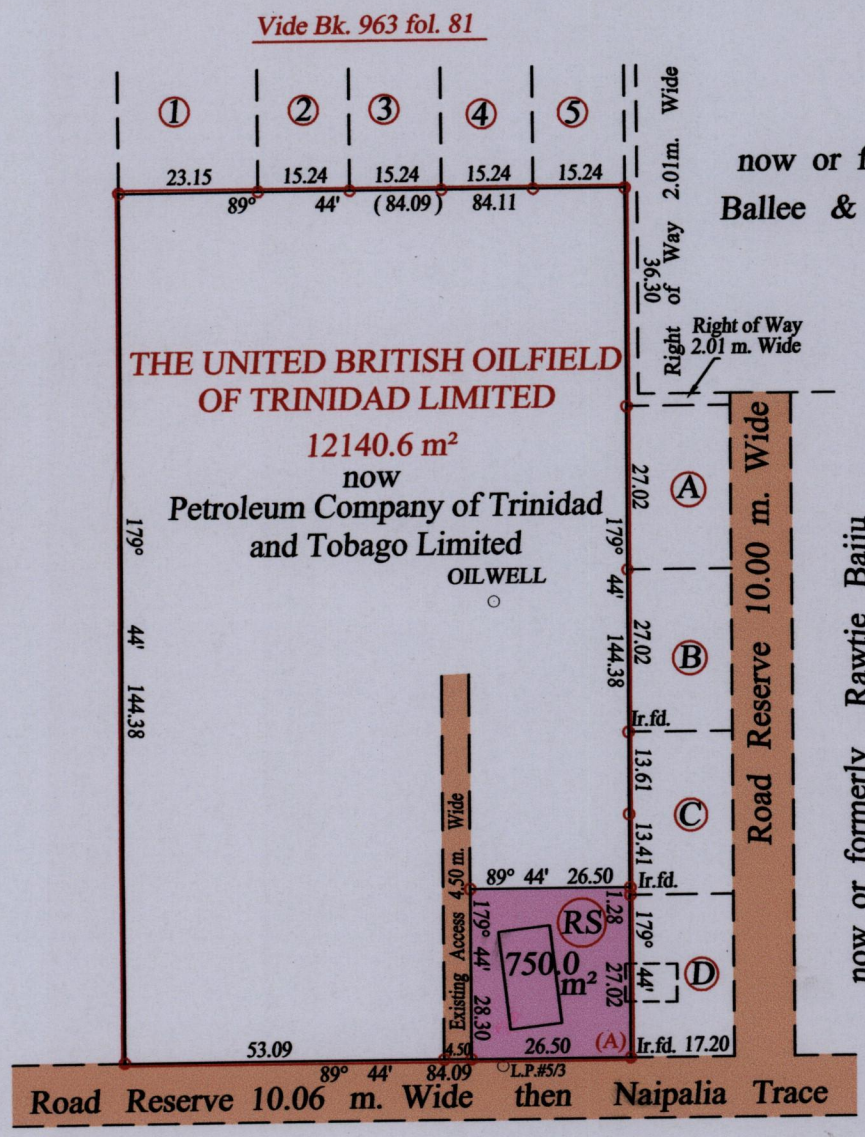

now or formerly  
Ballee & Sahadaree

now or formerly  
Rawtie Bajju

Vide Bk. 1247 fol. 76

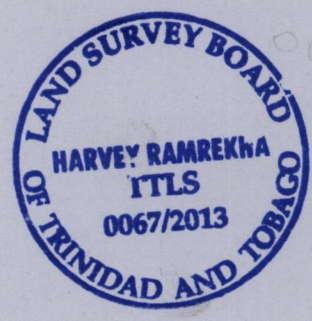

Vide Bk. 871 fol. 112 for Orig. Survey

Approved   
Director of Surveys  
2/5/14

At Station (A)
E 0671480
N 1123950
Reading taken with
Handheld G.P.S.
U.T.M. Zone 20
Naparima
+ 5 m.

SCALE : 1:1250

○ Denotes Iron put except stated otherwise.

Note: Bearings are U.T.M. grid based on solar observations      Distances are in metres

PLAN of a Parcel of land coloured pink in the Ward of Siparia  
Containing seven hundred and fifty point zero square metres  
Surveyed by me, with due authority, in June 2003  
Certified Correct in accordance with Regulation 25(1) of the Land Surveyors Regulations 1998

Checked by

Entered on ..... Trinidad & Tobago Land Surveyor ..... 10.12.2013