

Original Survey in Bk. 189 Fol. 251 ✓  
Reference: See Bk. 1111 Fol. 195  
See Bk. 1124 Fol. 75

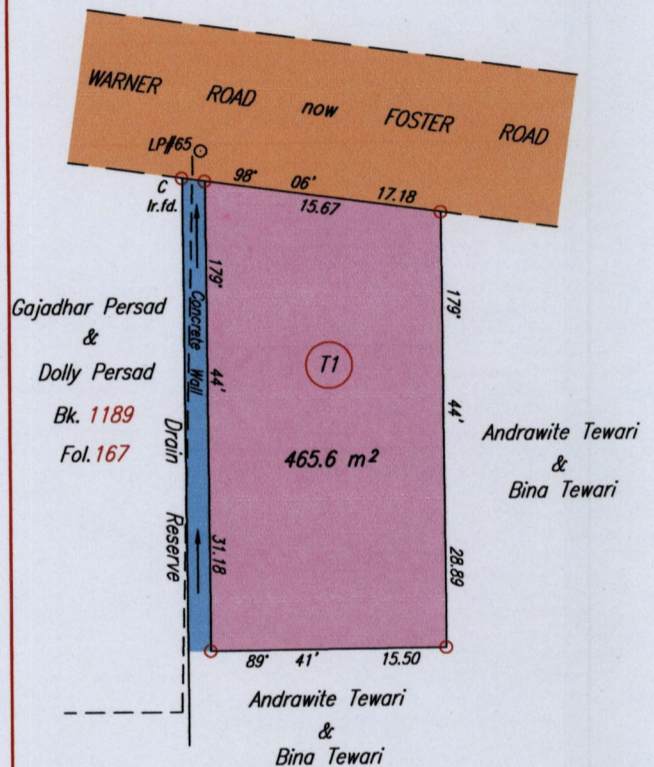

Coordinates of G (I.r.f.d.): 0706371mE, 1172770mN  
U.T.M. 20 WGS 84 (+/- 6.00)  
G.P.S. Direct Observation

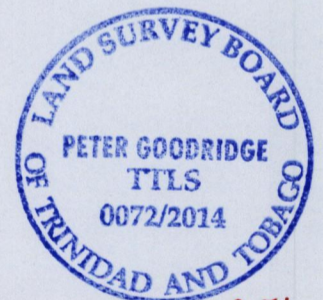

Orig Bk. 189 fol. 251

Approved .....  
Director of Surveys

**SCALE 1:500**  
Distances are in METRES

○ Denotes Iron put except where otherwise stated  
Bearings are Cassini Grid based on Solar Observations

**PLAN of a Parcel of land coloured pink in the Ward of Manzanilla**  
Containing four hundred and sixty five point six square metres  
Surveyed by me, with due authority, on the 4th of July 2011

Certified Correct in accordance with Regulation 25 (1) of The Land Surveyors Regulations 1998,

Checked by ..... TTLS

Entered on ..... 20th April 2014