

R.P.O. Vol. 104 Fol. 319

C.T. Vol. 5502 Fol. 75

PROCESS ID # 80771

Ward of Naparima

County of Victoria

Cadastral Sheet G 13 C & G, $\frac{63 F}{11b \& d}$

N: 1126404
E: 670654
Hand Held GPS.
Naparima Datum (+/-5m)
UTM Zone 20.

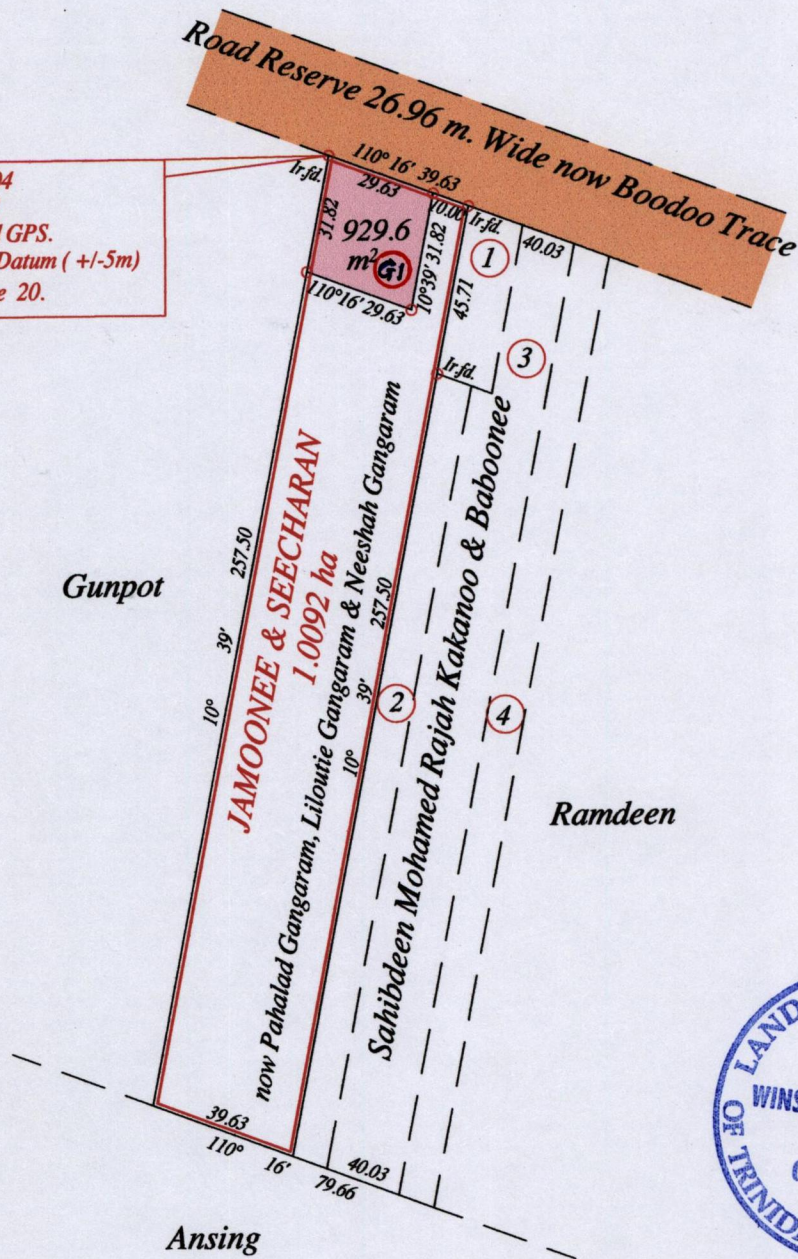

GN
UTM



Approved *[Signature]*
Director of Surveys *[Signature]*

Vide Bk. 393 fol. 73 for Orig Survey
Vide Bk. 1014 fol. 45

o Denotes Iron put except stated otherwise. SCALE : 1:2000
Note: Bearings are U.T.M. grid based on solar observations Distances are in metres
PLAN of a Parcel of land coloured pink in the Ward of Naparima
Containing nine hundred and twenty nine point six square metres
Surveyed by me, with due authority, in September 2012
Certified correct in accordance with Regulation 25 (1) of the Land Surveyors Regulations 1998.

Checked by *[Signature]*

Entered on Trinidad & Tobago Land Surveyor *[Signature]* 28th January 2014