

1054

146

RPO Vol 75 Fol 271
CT Vol 5328 Fol 23

Cadastral Sheet G.13.J., 63F
County of St. Patrick 3/a
Ward of Siparia

Refs. Bk 818 Fol 135, 102
Bk 723 Fol 198
Bk 717 Fol 57, 58
Bk 976 Fol 5

PENAL

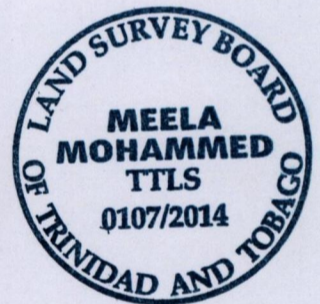
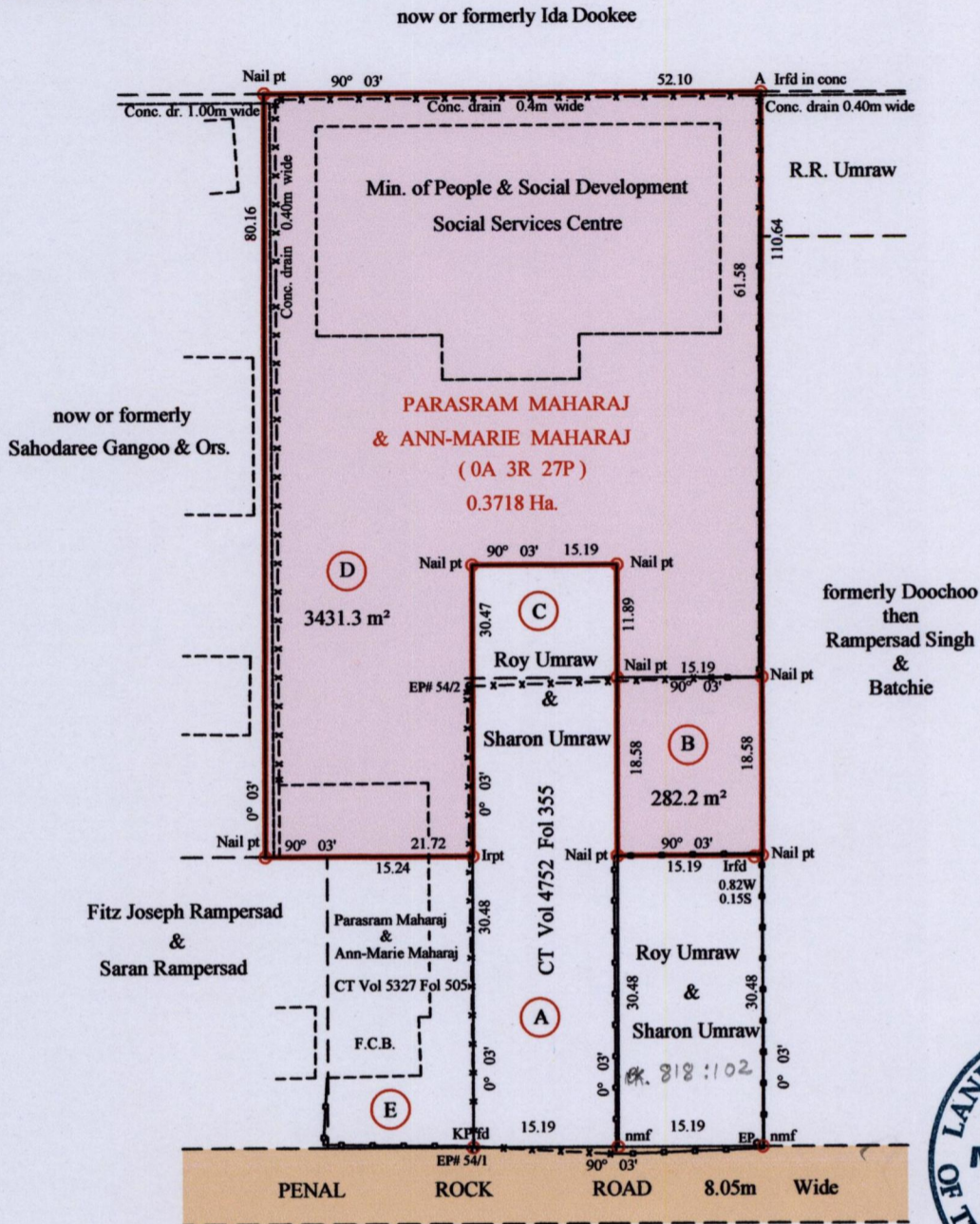

Note: Plot B is to be amalgamated to land on the West, plot A
Plot D is to be amalgamated to land described in CT Vol. 5327 Fol. 505, plot E & plot C

Orig Survey BK 818:135

Irfd A
Hand-held GPS Coords.
UTM Zone 20, Naparima 1955
E 0668990 ± 5m
N 1124283

Approved

Director of Surveys

[Signature]
14/4/14

—●—●—●—●— Brick Wall
-x-x-x-x-x-x-x-x C/L wire fence

○ denotes Iron put except otherwise stated
Bearings are Cassini Grid based on Solar Obs.
Distances are in Metres
SCALE 1/750

PLAN of two parcels of land coloured pink in the Ward of Siparia
Comprising together three seven one three point five square metres
Surveyed by me, with due authority, in April 2014.

Certified correct in accordance with Regulation 25 (1) of the Land Surveyors' Regulations 1998.

Checked by
Entered on

Meela Mohammed
Trinidad and Tobago Land Surveyor

14th April 2014