

R.P.O. Vol. 70

Fol. 29

C.T. Vol. 3235

Fol. 489

U.P.I.N. No.:

Ramdane Mahragde

then

Parcel (5)

Bk. 1010 Fol. 187

Ward of Siparia

County of St. Patrick

Cadastral Sheet G.13.E & F. 63E

2/d

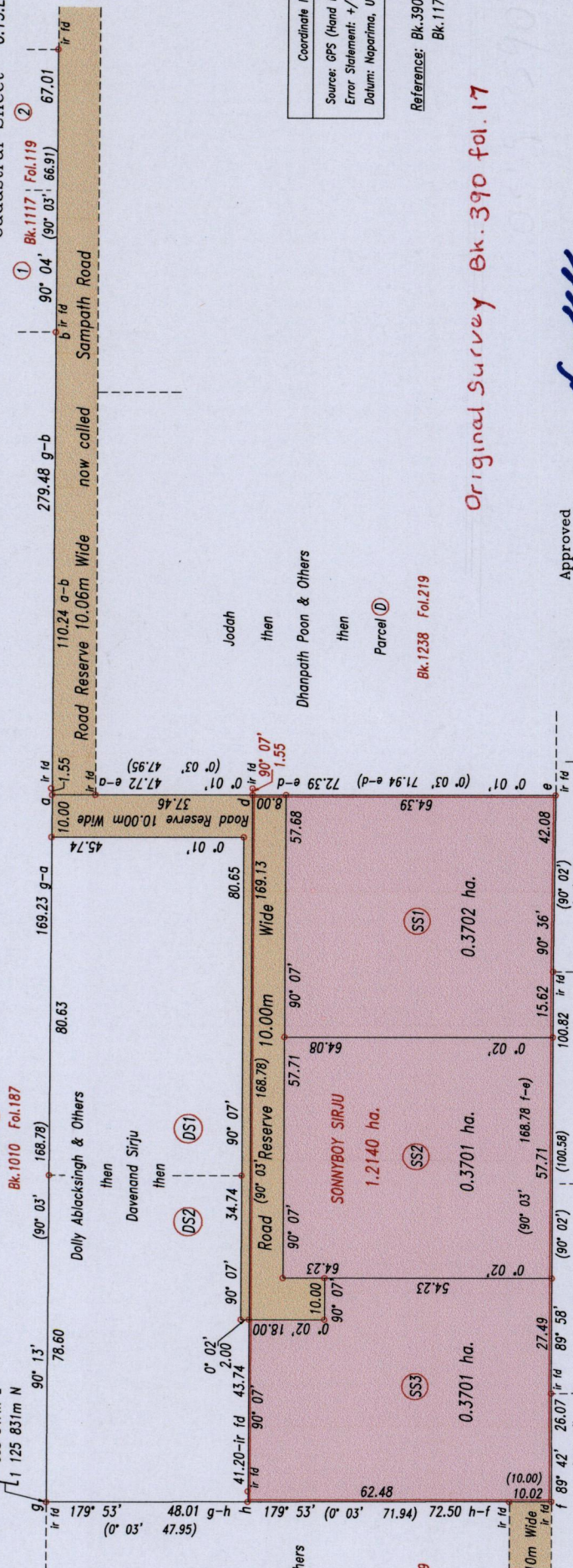
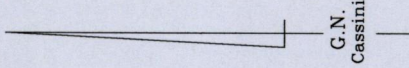

Coordinate Information	
Source:	GPS (Hand Held)
Error Statement:	+/- 5m
Datum:	Naparima, UTM (Zone 20).

Reference: Bk. 390 Fol. 17
 Bk. 1175 Fol. 67

Original Survey Bk. 390 fol. 17

Approved
[Signature]
 Director of Surveys 19/14/14

SCALE 1: 1500

Distances are in metres
 o Denotes iron put except otherwise stated

Bearings are Cassini Grid based on Solar Observations

PLAN of 3 parcels of land coloured pink in the Ward of Siparia

Containing together one point one zero four hectares

Surveyed by me, with due authority, in May 2013

Certified Correct in accordance with Regulation 25(1) of the Land Surveyors' Regulations 1998.

Checked by
 Entered
[Signature]
 Trinidad & Tobago Land Surveyor 28/3/2014

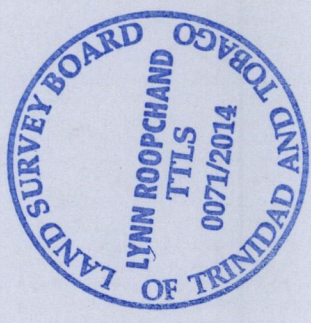

1654

144

1654