

INSET
SCALE 1:1500

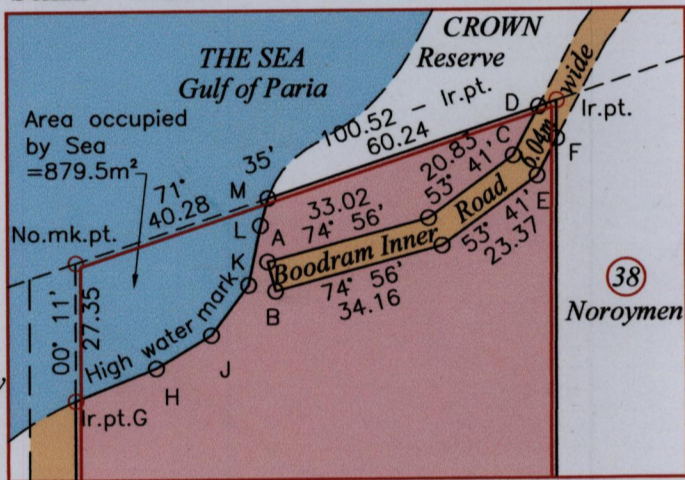

LEGEND		
LINE	BEARING	DISTANCE
A-B	164° 56'	6.04
C-D	27° 30'	10.87
D-Ir.pt.	71° 35'	3.75
E-F	27° 30'	8.29
F-Ir.pt.	00° 17'	7.51
G-H	68° 26'	17.21
H-J	59° 27'	12.75
J-K	36° 52'	12.42
K-L	11° 19'	12.12
L-M	15° 17'	5.66

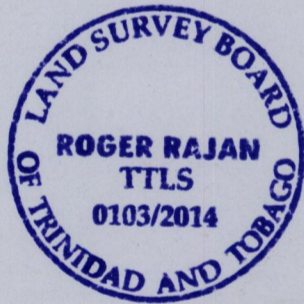

Coordinate was obtained from Handheld GPS
Naparima Datum (+/-5m)
UTM Zone 20

Approved *[Signature]*
Director of Surveys 1/4/14

- Denotes Traverse Station (No.mk.pt.)
- Denotes Iron found except stated otherwise.

Bearings are Cassini Grid based on Solar Observations
Plan of a Parcel of land coloured pink in the Ward of Cedros.
Containing three point nine four nine one hectares.

Surveyed by me, with due authority, in May 2013

In accordance with Regulation 25 (1) of the Land Surveyors Regulations 1998,

Certified correct in accordance with Regulation 25(1) of the Land Surveyors' Regulations 1996

Checked by.....

[Signature]

Entered onTrinidad & Tobago Land Surveyor.....27th March.....2014

Vide: Bk. 709 Fol. 157
Bk. 439 Fol. 157

SCALE 1:4,000

Distances are in metres