

1654

121

R.P.O. Vol. 52 Fol. 213
C.T. Vol. Fol.

Ward of Charuma
County of Nariva
Cadastral Sheet H.2.A&B 55.B.
3/c



INSET

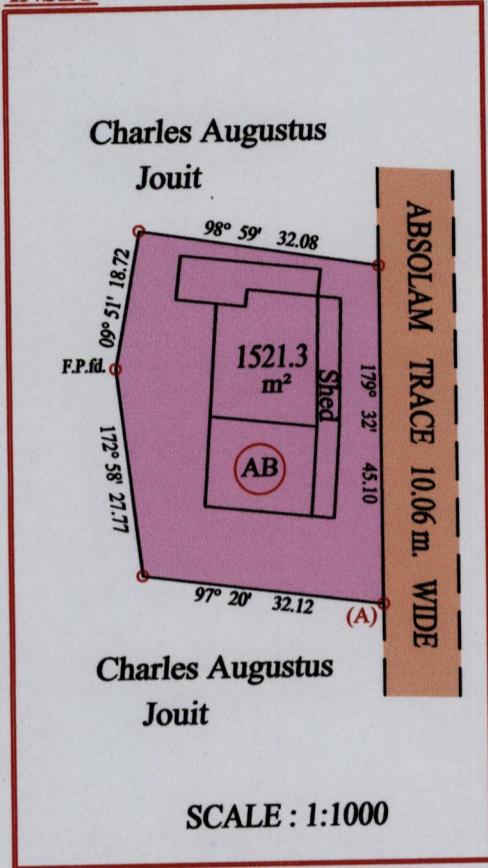

Vide Bk. 980 fol. 55
Vide Bk. 1117 fol. 172

At Station (A)
E 0697470
N 1139571
Reading taken with
Handheld G.P.S.
U.T.M. Zone 20
Naparima
+ 5 m.

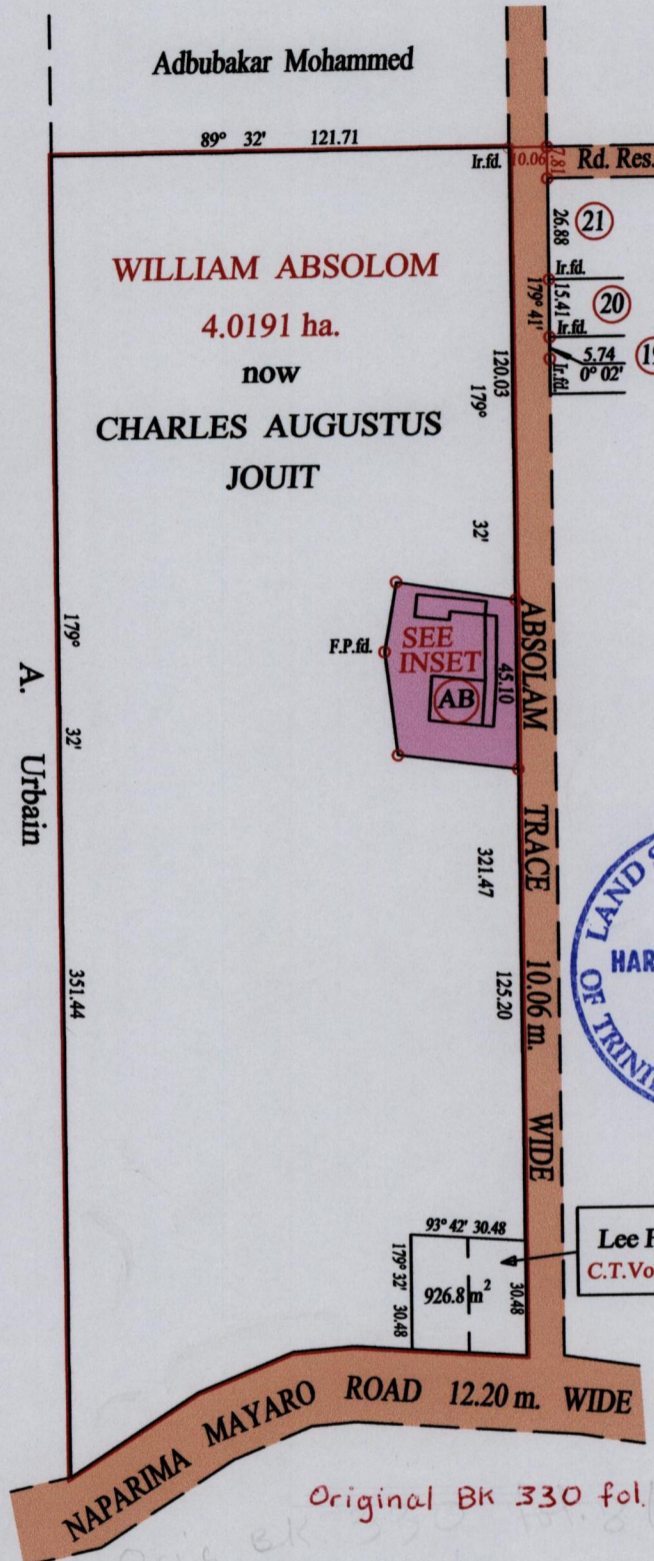

Approved
Director of Surveys 26/5/14

Original BK 330 fol. 86

o Denotes Iron put except stated otherwise. SCALE : 1:2000
 Note: Bearings are U.T.M. grid based on solar observations Distances are in metres
 PLAN of a Parcel of land coloured pink in the Ward of Charuma
 Containing one thousand five hundred and twenty one point three square metres
 Surveyed by me, with due authority, in February 2006
 Certified Correct in accordance with Regulation 25(1) of the Land Surveyors Regulations 1998
 Checked by
 Entered on Trinidad & Tobago Land Surveyor 18.03.2014

7430
72006