

Cadastral Sheet D.5.P. 35A & 35A  
2/c 2/d  
Ward of Tamana  
County of St. Andrew

Remaining Portion Plan

R.P.O. Vol. 56 Fol. 333  
C.T. Vol. 5065 Fol. 525

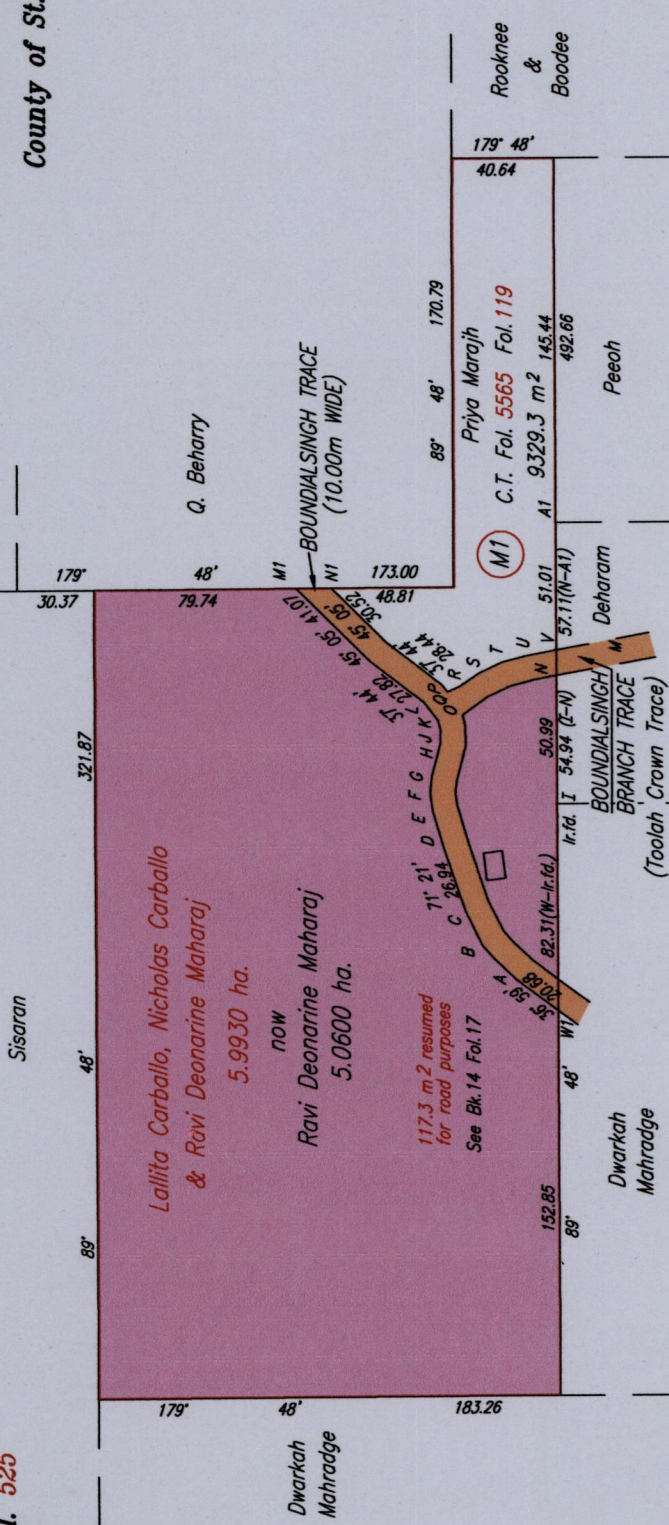

Approved .....  
Director of Surveys 9/3/14

Coordinates of M1 (lr. Id.) 0695456mE, 1165481mN  
U.T.M. 20 WGS 84 (+/- 6.00m)  
G.P.S. Direct Observation

Plan of five point nine three zero hectares  
originally transferred to Lallita Carballo, Nicholas Carballo & Ravi Deonarine Maharaj showing a portion  
coloured pink and containing five point zero six zero zero hectares  
being the remainder after one previous transfer of other portions of the land  
In accordance with Regulation 25 (1) of The Land Surveyors Regulations 1988,

I certify that this plan represents the remaining portion.

Checked by .....  
Entered on .....  
Trinidad & Tobago Land Surveyor  
C:\LESS 2014\TRINIDAD\MAHARAJ,RM\REMAINING FOR PLAN2014\CUMUTO.dwg  
FILE NO: M051

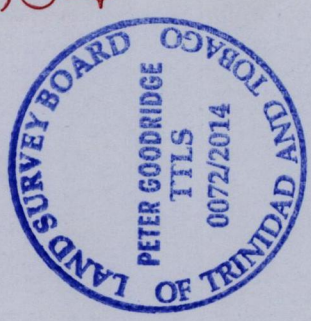

A - B	45° 11'	19.12
B - C	63° 27'	15.45
D - E	73° 35'	15.00
E - F	81° 27'	7.00
F - G	95° 36'	6.62
G - H	104° 41'	13.97
H - J	87° 57'	5.41
J - K	76° 14'	3.43
K - L	52° 04'	8.92
M - N	179° 48'	14.07
N - O	340° 57'	42.01
O - Q	42° 51'	4.99
P - Q	232° 04'	3.49
Q - R	155° 30'	5.26
R - S	146° 48'	9.38
S - T	154° 17'	10.13
T - U	165° 45'	10.09
U - V	169° 19'	12.01

Orig Survey Bk. 7 fol. 165

SCALE 1:3000  
Distances are in METRES

N.B.: A - L & P - V denotes peg pt.

1654

113

original 7:165