

R.P.O Vol. 107 Fol. 397
 C.T. Vol. 3976 Fol. 529
 Address - #8E Lalbeharry Trace,
 Debe.

Ward of Naparima
 County of Victoria
 Cadastral Sheet G.8.M., 63C
 3/c

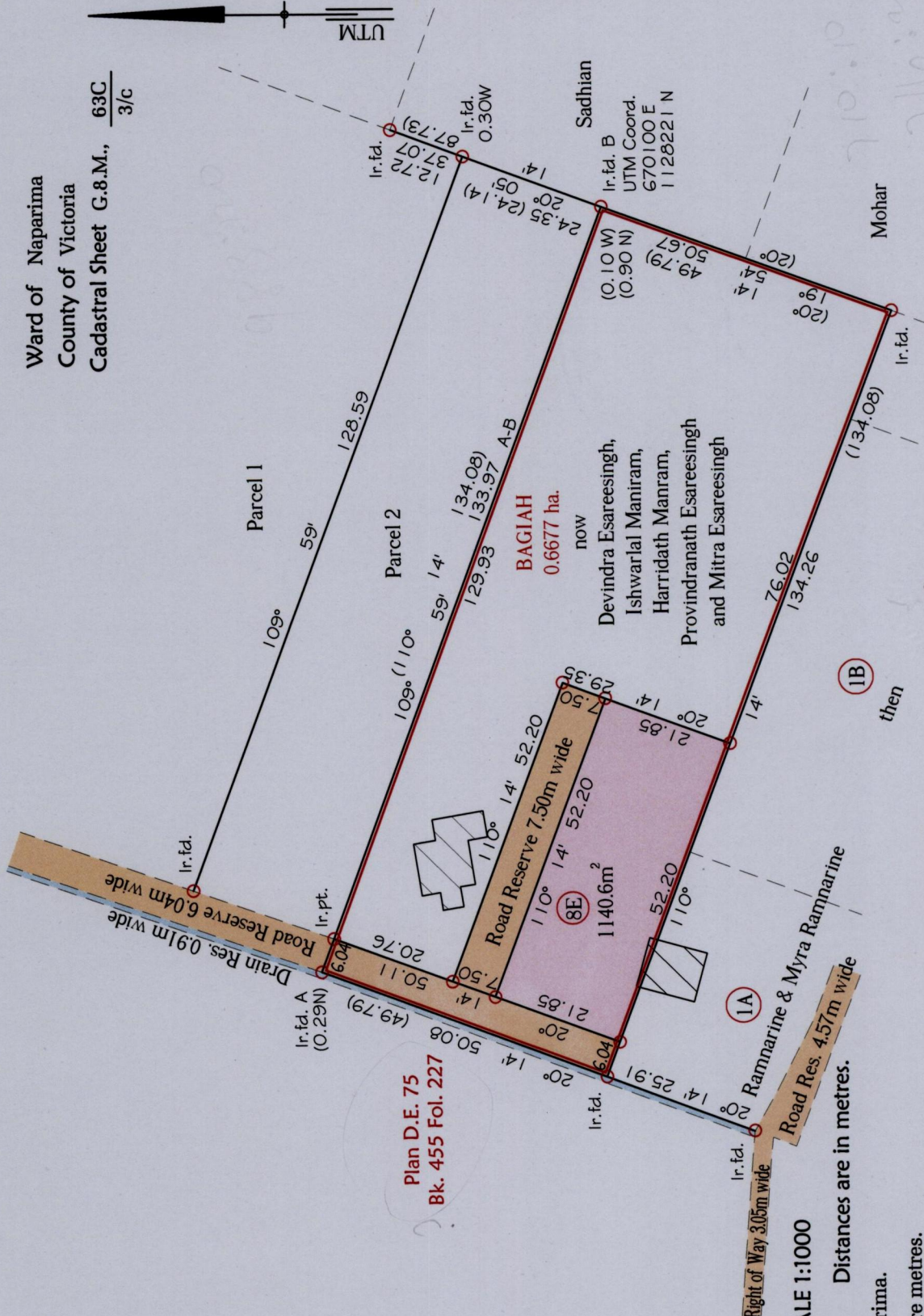

Plan D.E. 75
 Bk. 455 Fol. 227

Note - UTM (Nap Zone 20) Coordinates obtained from hand held GPS receiver + 5.00m

Ref.:- Bk. 716 Fol. 252 for Original Survey
 Bk. 993 Fol. 191
 Bk. 1196 Fol. 4
 Bk. 834 Fol. 85

Approved
 Director of Surveys 12/13/14

o Denotes Iron put except stated otherwise.
 Note: Bearings are U.T.M. grid based on solar observations Distances are in metres.
 Plan of a Parcels of land coloured pink in the Ward of Naparima.
 Containing one thousand one hundred and forty point six square metres.
 Surveyed by me, with due authority, in January 2002
 Certified correct in accordance with Regulation 25(1) of the Land Surveyors' Regulations 1998,

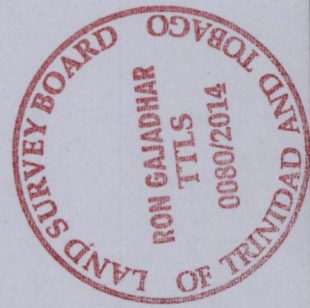

Checked by *[Signature]* 28/12/2014
 Entered on
 Trinidad & Tobago Land Surveyor 4/2/2014

1054

109