

TO BE BROUGHT UNDER THE PROVISIONS OF THE REAL PROPERTY ORDINANCE

U.P.R.N.

Cadastral Sheet F. 25. K., 72E  
3/b

Ward of Erin

County of St. Patrick

Plan P. R. 141

A - 649,069mE, 1112298mN  
UTM ZONE 20, Naparima (+/- 3.00M)  
Direct Observation-GPS Hand held

1653

134

G.N.  
U.T.M

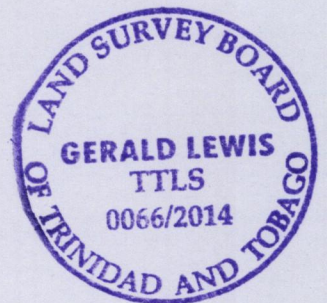
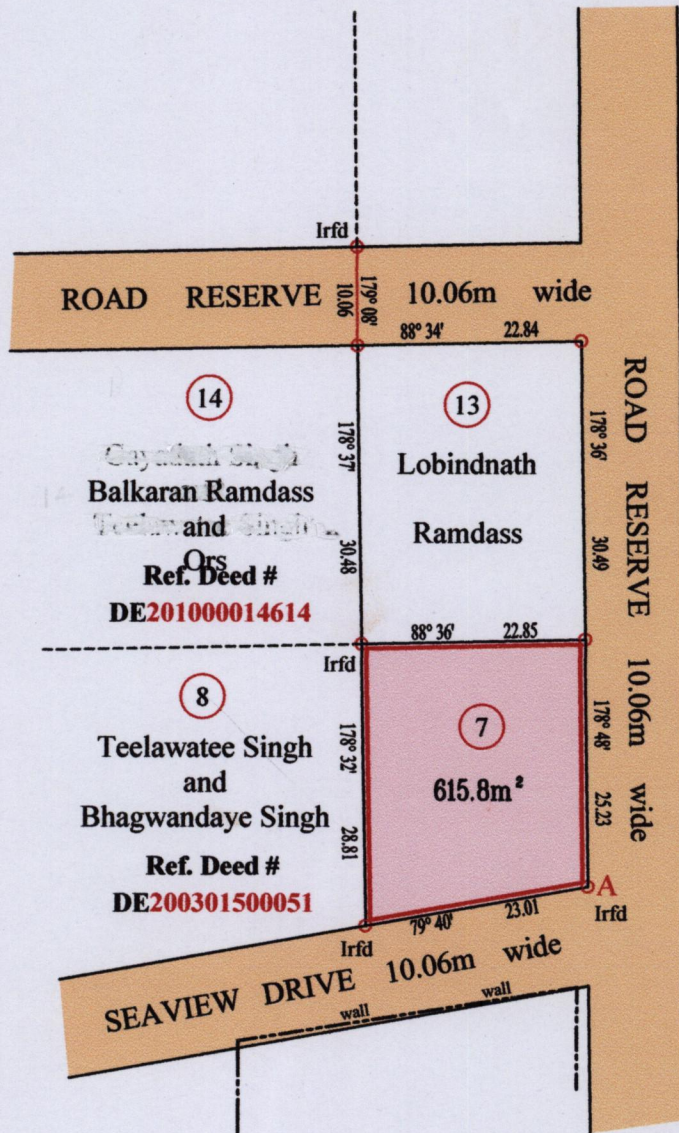

Approved .....  
Director of Surveys

SCALE 1: 750  
Distances are in Metres

○ Denotes Iron Put unless otherwise stated

Bearings are U.T.M Grid based on Solar Obs

PLAN of a Parcel of land coloured pink in the Ward of Erin

Containing six hundred and fifteen point eight square metres

Surveyed by me, with due authority, on 29th August 2014 at the request of Lobindnath Ramdass

Certified Correct in accordance with Regulation 25(1) of the Land Surveyors Regulations 1998

Checked by K. 19.5.2015 .....

Entered on .....

Trinidad & Tobago Land Surveyor .....  
05/09/2014



1653/13A