

1653

119

To be brought under the provisions of the Real Property Ordinance

Cadastral Sheet A.15.1 13A 3/d  
Ward of Diego Martin  
County of St. George

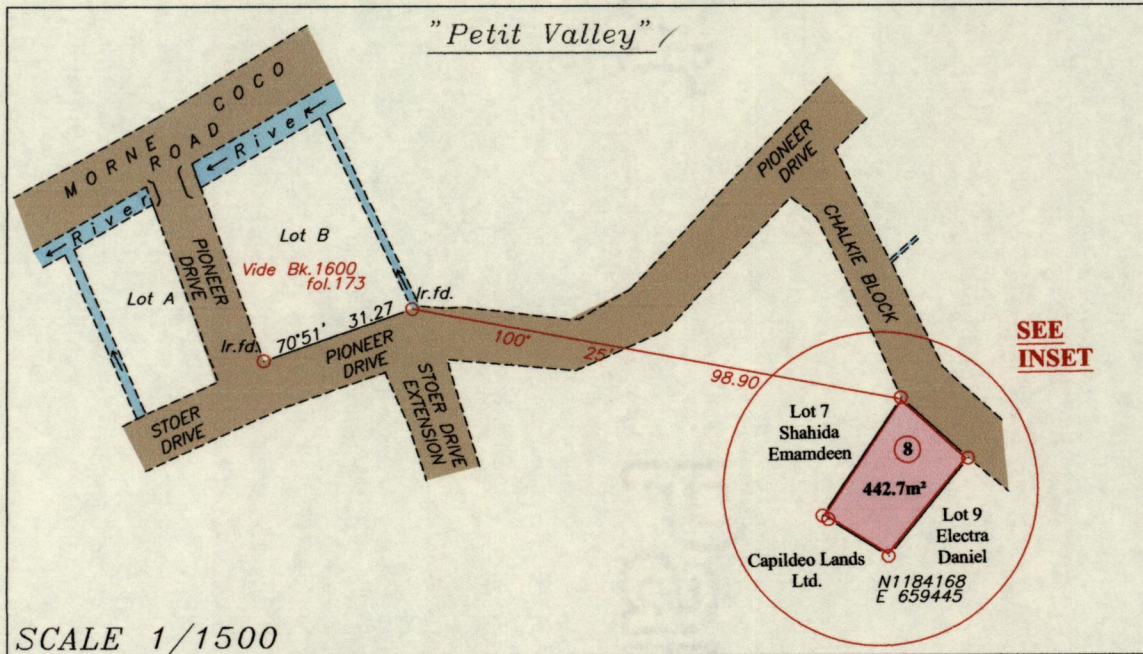

G N  
U.T.M.

INSET

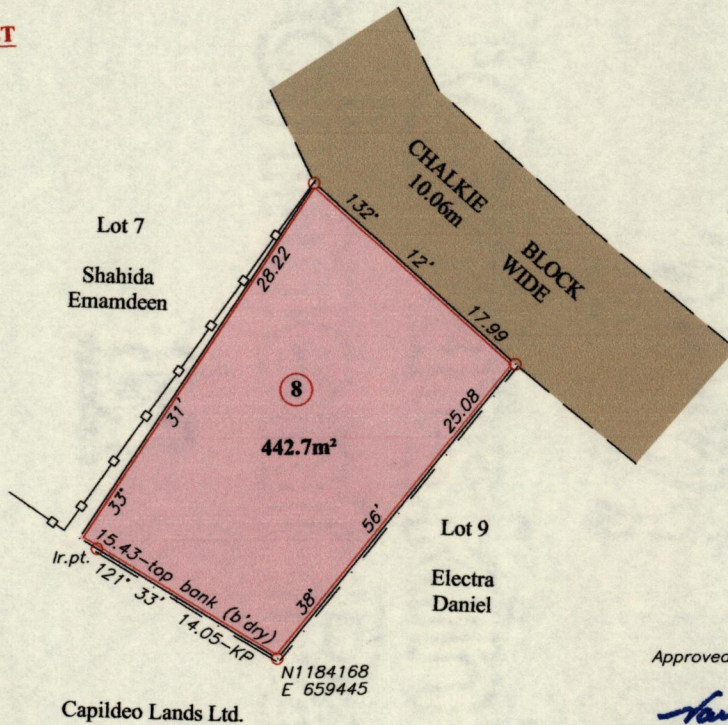
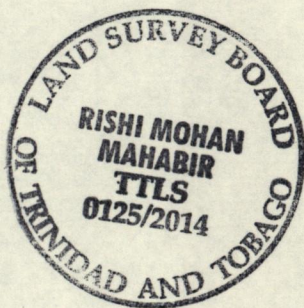

Approved

Director of Surveys

15/3/15

— — Fence  
— □ — Wall

○ Denotes KP unless otherwise stated

Co-ordinates are U.T.M. Zone 20N Naparima Datum +/-5m obtained from a hand held GPS.

Bearings are U.T.M. grid based on solar observations

Note: To obtain compass bearings add 15 minutes.

Vide plan P.A.158

SCALE 1/500

Distances are in metres

PLAN of a Parcel of land coloured pink in the Ward of Diego Martin  
Containing four four two point seven square metres

Surveyed by me, with due authority, on 26th February 2014 for Joanne Joseph  
Certified Correct in accordance with Regulation 25 (1) of the  
Land Surveyors Regulations 1998

Checked by 5.3.2015

*R. P. Joseph*

Entered..... Trinidad & Tobago Land Surveyor... 2<sup>nd</sup> December 2014.....

12-01-2014 10:10:10 AM

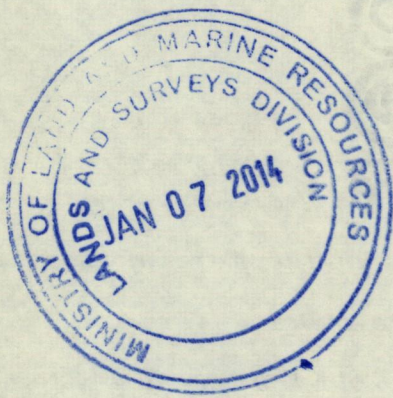

1653/119