

1653/103

1653

103

TO BE BROUGHT UNDER THE PROVISIONS OF THE REAL PROPERTY ORDINANCE

Cadastral Sheet 25F 1/b, C.22.M.

Ward of Manzanilla

County of St. Andrew

"L.P. No. 907 EASTERN MAIN SANGRE GRANDE"

Vide Bk. 1069:208 Bk. 1088:14

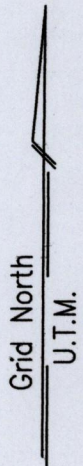

LINE	BEARING	DIST.
A - B	44° 19'	1.90
B - C	71° 36'	3.72
C - D	66° 46'	2.12
D - E	53° 54'	2.16
F - G	21° 39'	2.43
G - H	4° 29'	9.05
H - J	90° 03'	1.27

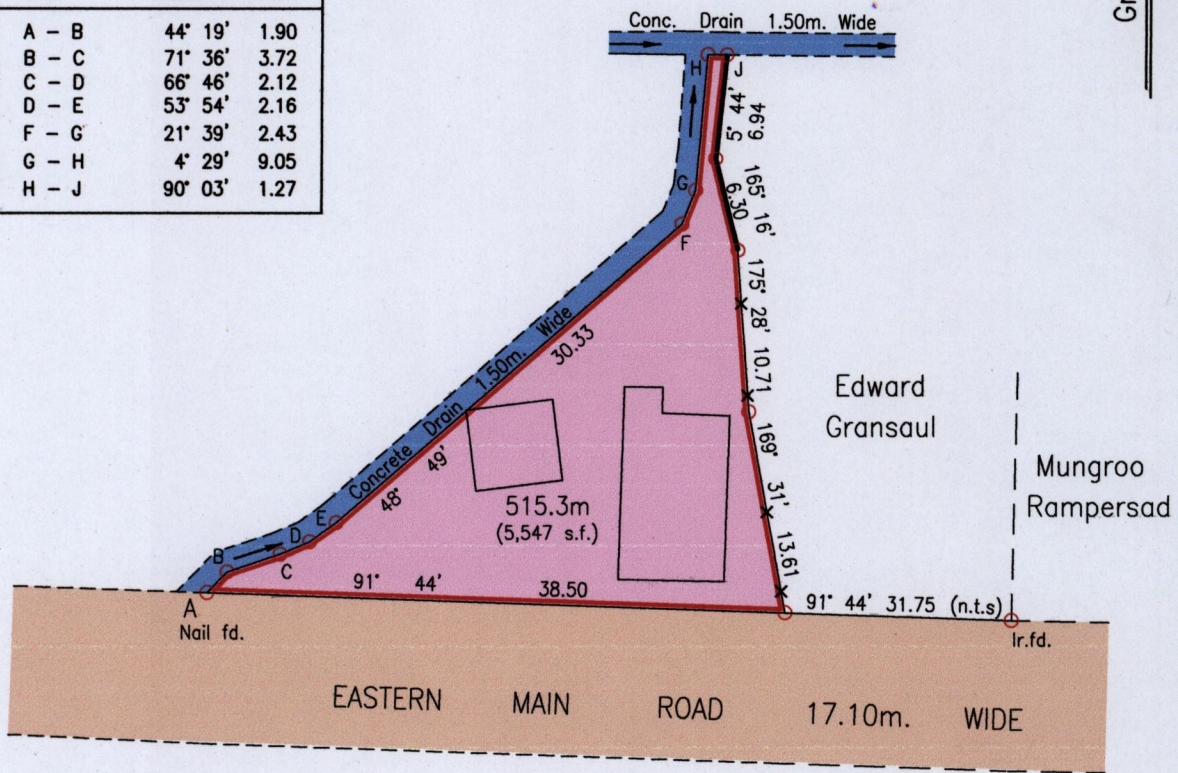

Approved

*Shirley Mongolas*  
Director of Surveys  
30/11/14

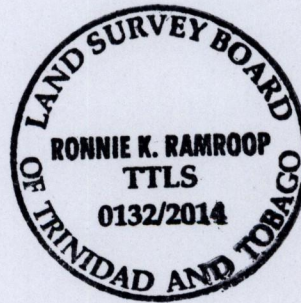

SCALE 1:500

Distances are in Metres

A	E 704030
	N 1170633

Reliability Error ± 5.0 m. (Zone 20)  
Coordinates are UTM, Naparima 1955  
Obtained from Handheld GPS Receiver

— Denotes Concrete Brick Wall.  
x-x-x-x Denotes Chain link wire fence

Bearings are UTM Grid based on Solar Obs.

○ Denotes Iron Put unless otherwise stated

Plan of a Parcel of land coloured pink in the Ward of Manzanilla  
Containing five hundred and fifteen point three square metres

Surveyed by me, with due authority, on 28th July 2014 for Shirley Mongolas

Certified Correct In accordance with Regulation 25(1) of the Land Surveyors Regulations 1998,

Checked by *PR-26/11/14*

*Shirley Mongolas*

Entered on .....

Trinidad & Tobago Land Surveyor

*6<sup>th</sup> August* 2014

PLAN No. 902 EASTERN MAIN  
SHEET 6/10

1	2
3	4

NO.	DESCRIPTION	AREA
1		
2		
3		
4		
5		
6		
7		
8		
9		
10		

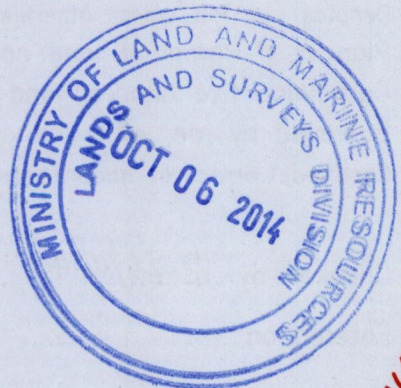
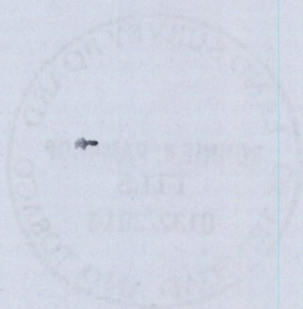

1653/103