

1652

84

R.P.O. Vol. 14 Fol. 449
C.T.Vol. 5523 Fol. 159

Cadastral Sheet G.13.B. & G.8.N 63C/3/c
Ward of Naparima
County of Victoria

Vide: Bk.903 Fol.152

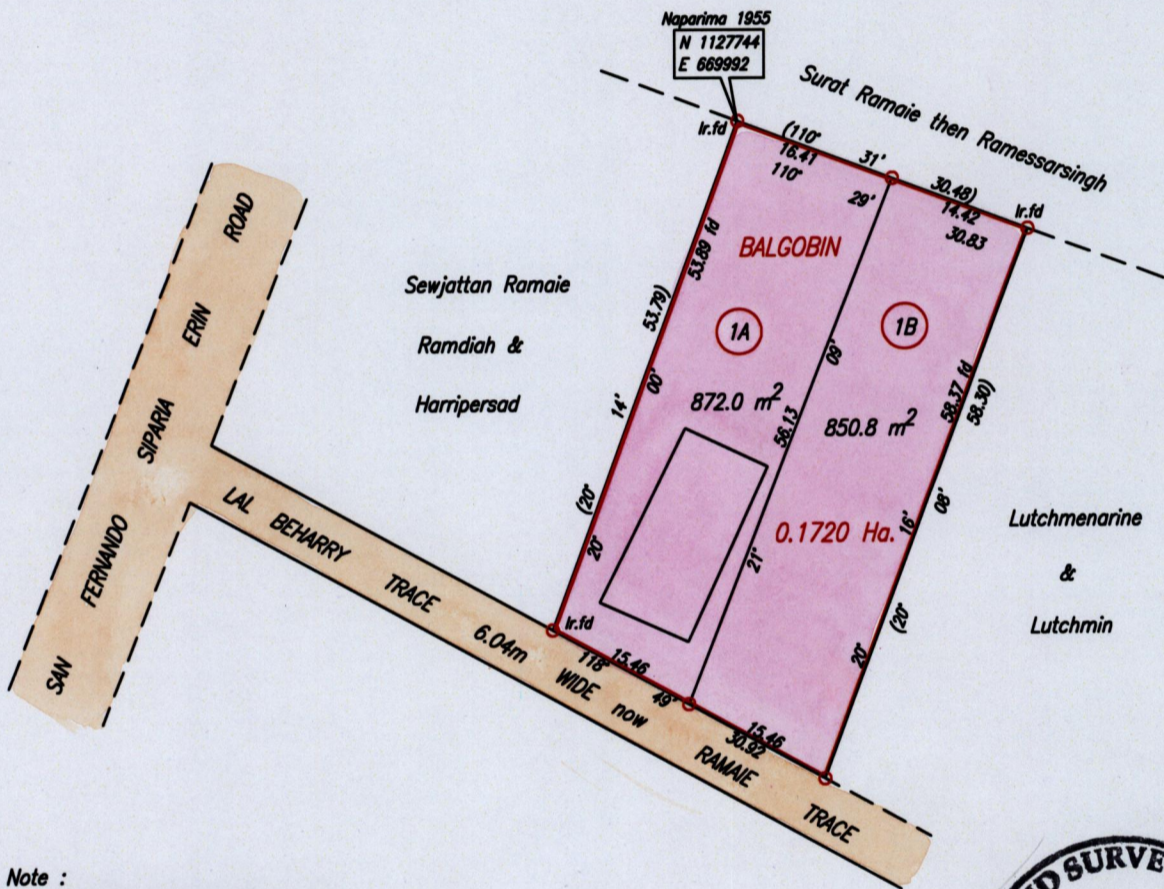
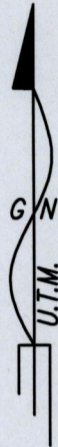

Note :

Coordinates obtained by hand held G.P.S. (+/-5.0m.) For Identification only

Orig. Bk. 903:152

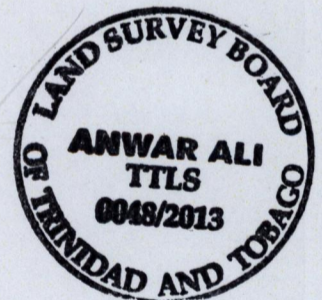

Approved

[Signature]

Director of Surveys 16/7/13

SCALE 1:750

Distances are in metres

○ Denotes Iron put except where otherwise stated
Bearings are U.T.M. Grid based on Solar Observations
PLAN of 2 Parcels of land coloured pink in the Ward of Naparima
Containing together one thousand seven hundred and twenty two point eight square metres
Surveyed by me, with due authority, in August 1991
Certified correct in accordance with Regulation 25 (1) of the Land Surveyors' Regulations 1998,

Checked by *[Signature]* 10/7/2013

[Signature]

Entered on

Trinidad & Tobago Land Surveyor. 23rd May 2013.
PATH = ADA004 D:/DRAWINGS/BALGOBIN DWG.

Axc D
K 7 G 12

901.67