

R.P.O Vol. 218 Fol. 609
 C.T. Vol. 3508 Fol. 133

Ward of Siparia.
 County of St. Patrick.
 Cadastral Sheet G.13.G. 63F
 2/c

1652

56

671915 mE, 1125152mN.
 X- U.T.M. 20, WGS 84 (+/- 5.0m)
 GPS Handheld Direct Obs.

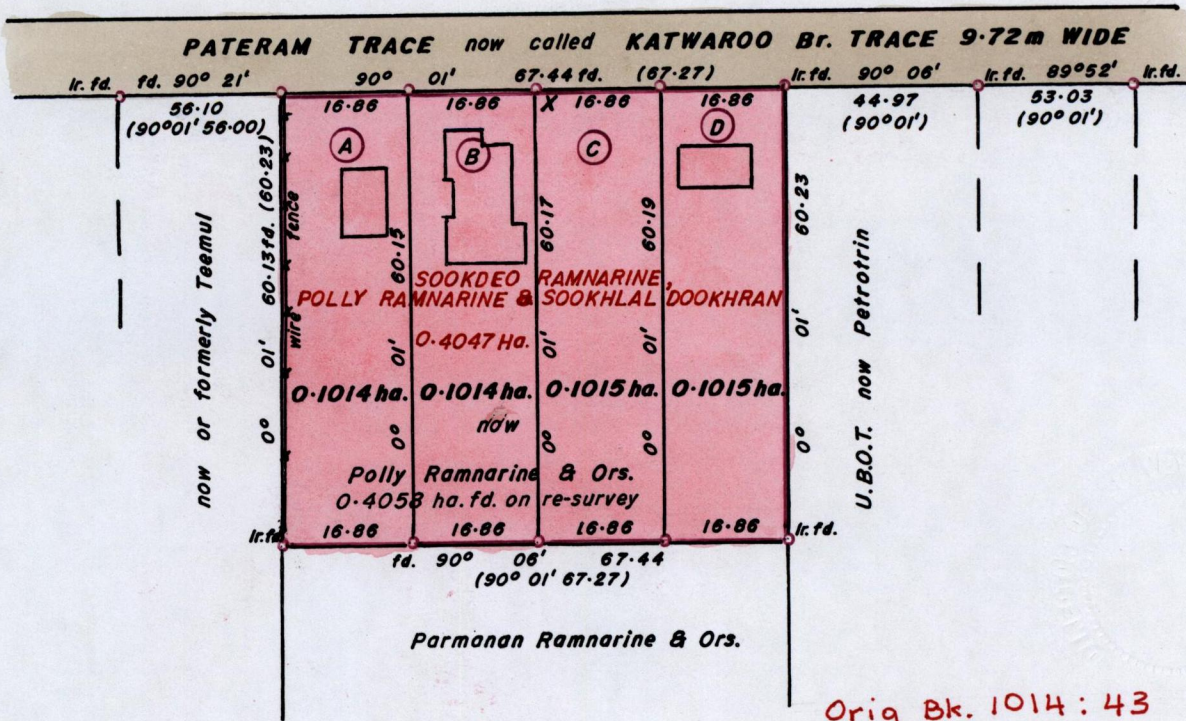
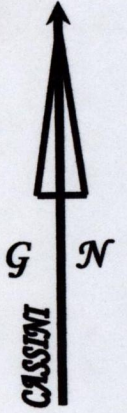

Orig Bk. 1014 : 43

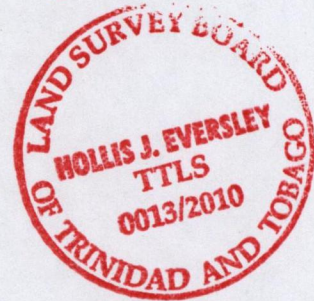

1014-343

Approved.....
 Director of Surveys. *21 R/13*

Bk. 1014 : 43.
 SCALE 1:1000.

Distances are in METRES
 o Denotes Iron Put except otherwise stated
 Bearings are Cassini Grid based on Solar Observations.

PLAN of 4 Parcels of land coloured PINK in the Ward of Siparia.
Containing together zero point four zero five eight hectares.
Surveyed by me, with due authority, in October 2010.
In accordance with Reg. 25(1) of the Land Surveyors' Regulations 1998,
I certify that this plan is correct.

Checked by *Maly 6/3/13*

[Signature]
 11th October 2010.

Entered Trinidad and Tobago Land Surveyor 2010.