

Process Id # 55233
R.P.O. Vol. 429 Fol. 315
C.T. Vol. 4797 Fol. 531
C.T. Vol. 5647 Fol. 269

Ward of Savana Grande
County of Victoria
Cadastral Sheet G.14.C 64 D
2/a

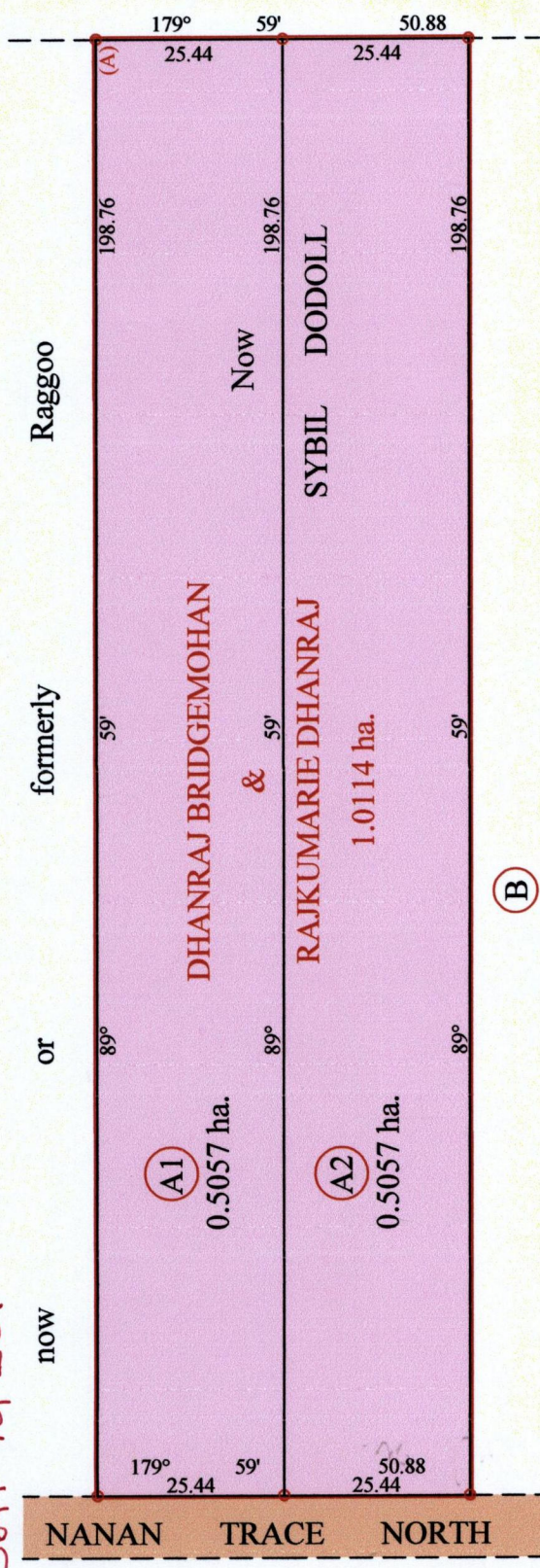

now or formerly
Seecharan

now or formerly
Bridgemohan

Approved *[Signature]*
Director of Surveys 12/6/13
SCALE : 1:1000
Distances are in metres

Note: Bearings are cassini grid based on solar observations
PLAN of 2 Parcels of land coloured pink in the Ward of Savana Grande
Containing together one point zero one one four hectares
Surveyed by me, with due authority, in January 2010
Certified Correct in accordance with Regulation 25 (1) of the Land Surveyors' Regulations 1998.

Checked by *[Signature]* 12/6/13
Entered on Trinidad & Tobago Land Surveyor 22,01,2013

Station (A)
E 0678480
N 1126460
Reading taken with
Handheld G.P.S.
Garmin 765
U.T.M. Zone 20
Naparima
±5m



ROCHARD DOUGLAS
ROAD 20.12 m WIDE

NANAN TRACE NORTH 8.05 m WIDE

1652/44

LOT #	C.T Vol & Folio	Names.
A1	5647 fol 285	Sybil & Govindra Dadoll.
A2	5647 fol 275	Dave Dadoll.

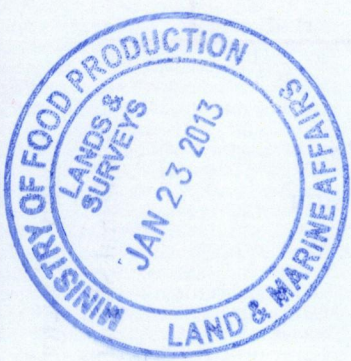

1652/44