

PROCESS ID # 78073

R.P.O. Vol. 112 Fol. 593

C.T. Vol. 4994 Fol. 53

U.P.I.N. No.:

Cadastral Sheet G.11.C.

62F

County of St. Patrick

2/b

Ward of Siparia

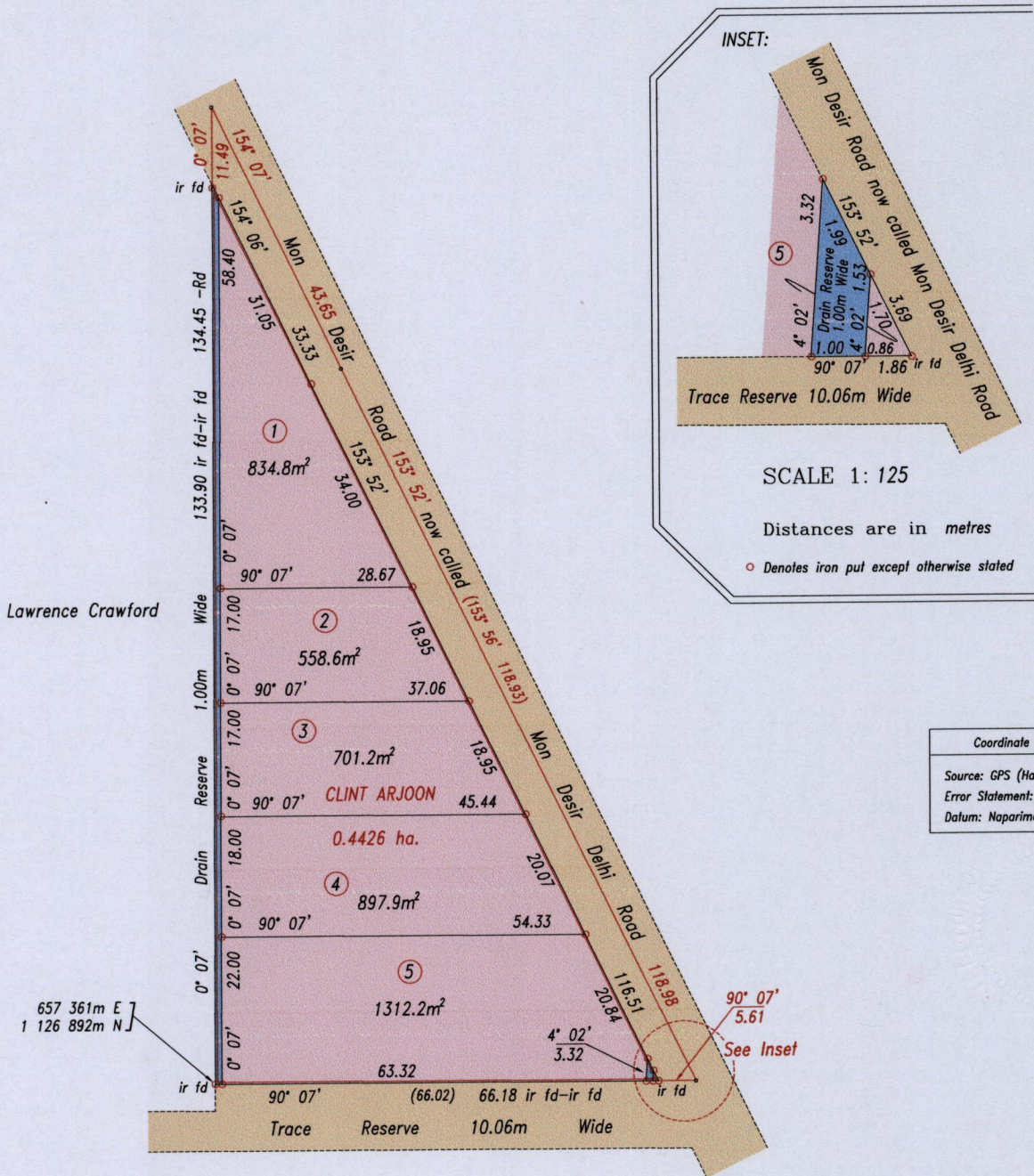

Lawrence Crawford

657 361m E  
1 126 892m N

Reference: Bk.1128 Fol.136 *Original Survey*

Approved *[Signature]*  
Director of Surveys 5/12/13

SCALE 1: 1000  
Distances are in metres  
○ Denotes iron put except otherwise stated  
Bearings are Cassini Grid based on Solar Observations

PLAN of 5 parcels of land coloured pink in the Ward of Siparia  
Containing together four thousand three hundred and four point seven square metres  
Surveyed by me, with due authority, in January 2009

Certified correct in accordance with Regulation 25(1) of the Land Surveyors' Regulations 1998.

Checked by .....  
Entered .....  
*L.A. Rippland*  
Trinidad & Tobago Land Surveyor 21/10/2013

