

PROCESS ID # G51A2

RPO Vol. 600 Fol. 553

CT. Vol. 3722 Fol. 33

Coordinates

Ir.f.d. L : N 1126286  
E 666230

Error Statement : ±4m

Datum Definition : U.T.M. Zone 20 Naparima

Source : Magellan Hand Held GPS

Ward of Siparia

County of St. Patrick

Cadastral Sheet G.12.D., 63E  
2/a

Parcel Address:

#96A, Doorbass Branch Trace No.4,  
San Francique, Penal.

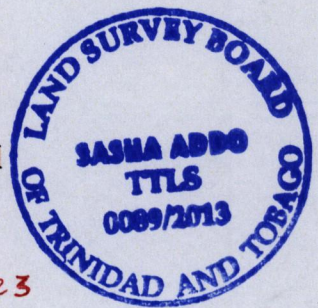
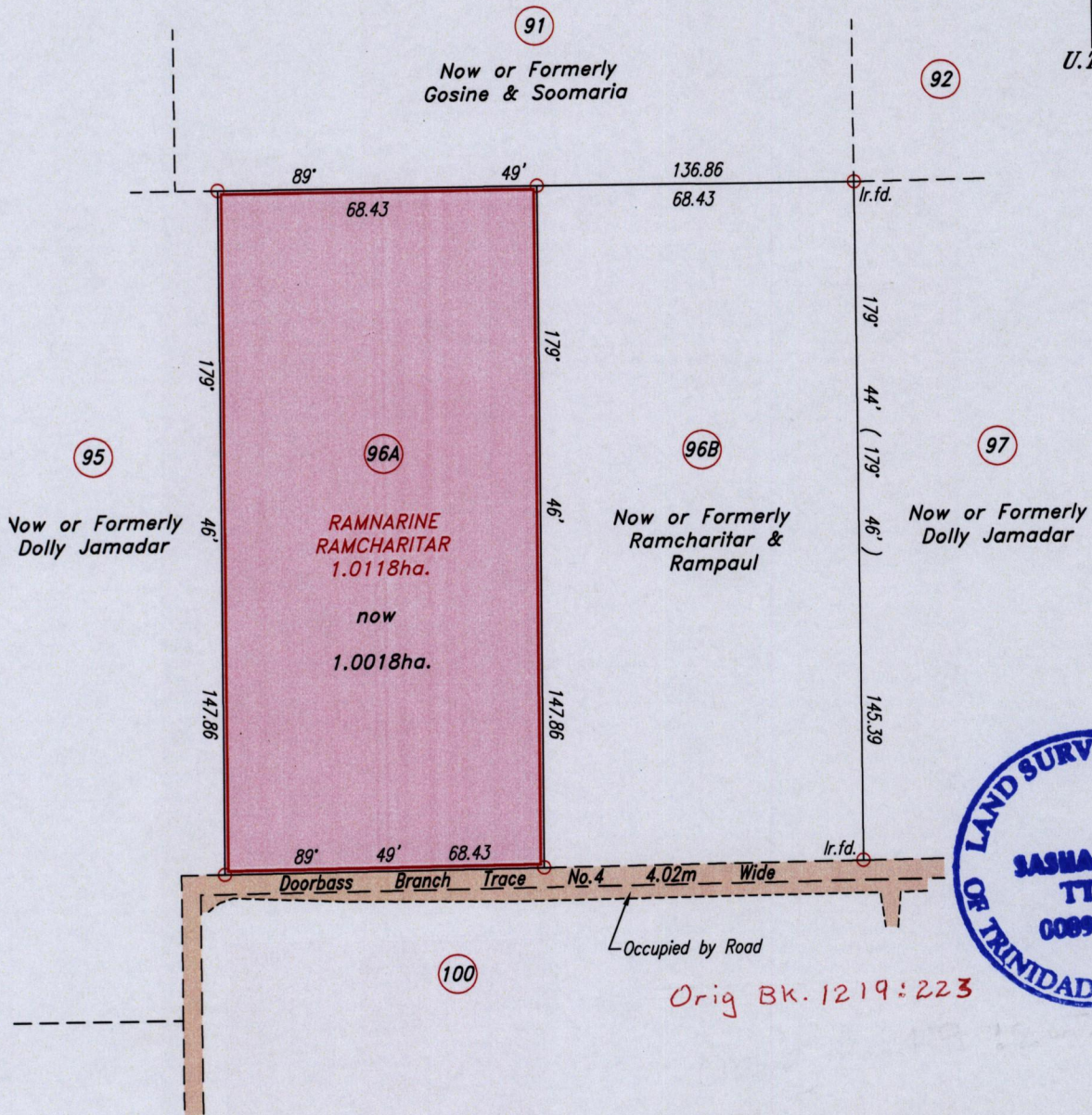

Orig BK. 1219:223

Ref.: Plan A.K.52  
Bk. 1238 Fol.193

Approved.....  
Director of Surveys *[Signature]*

SCALE 1:1500

○ Denotes Iron Put except otherwise stated.  
 Note: Bearings are U.T.M. grid based on solar observations. Distances are in metres.  
 Plan of a Parcel of land coloured pink in the Ward of Siparia  
 Containing one point zero one one eight hectares.  
 Surveyed by me, with due authority, in August 2013  
 Certified correct in accordance with Regulation 25 (1) of the Land Surveyors  
 Regulations 1998.  
 Checked by.....  
 Entered ..... Trinidad & Tobago Land Surveyor *[Signature]* 17 Sept 2013