

R.P.O. Vol. 283 Fol. 225
C.T. Vol. 3759 Fol. 215

Ward of Siparia
County of St. Patrick
Cadastral Sheet G.13.A., $\frac{63E}{2/b}$

INSET
1/1,000

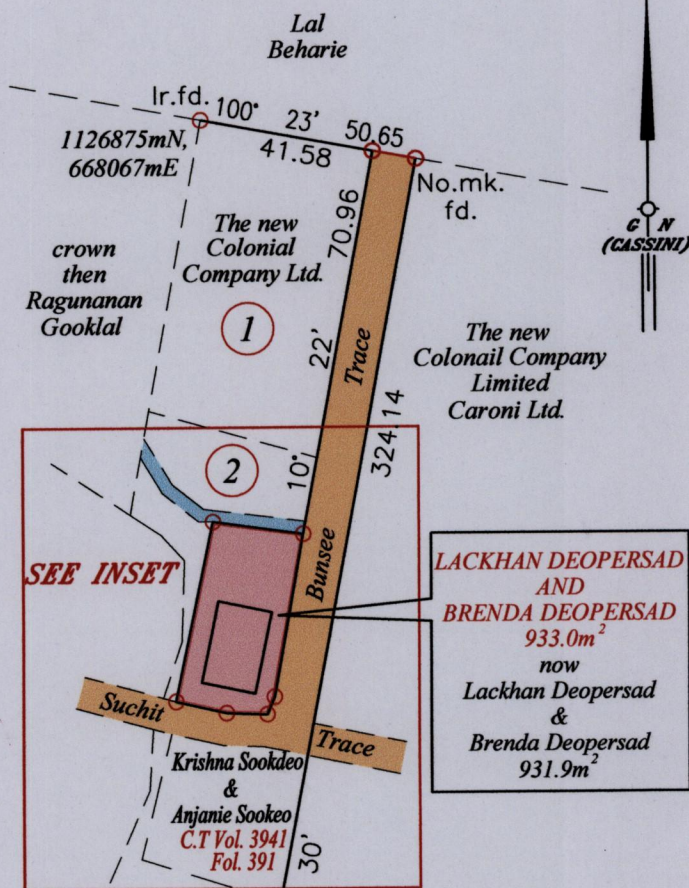
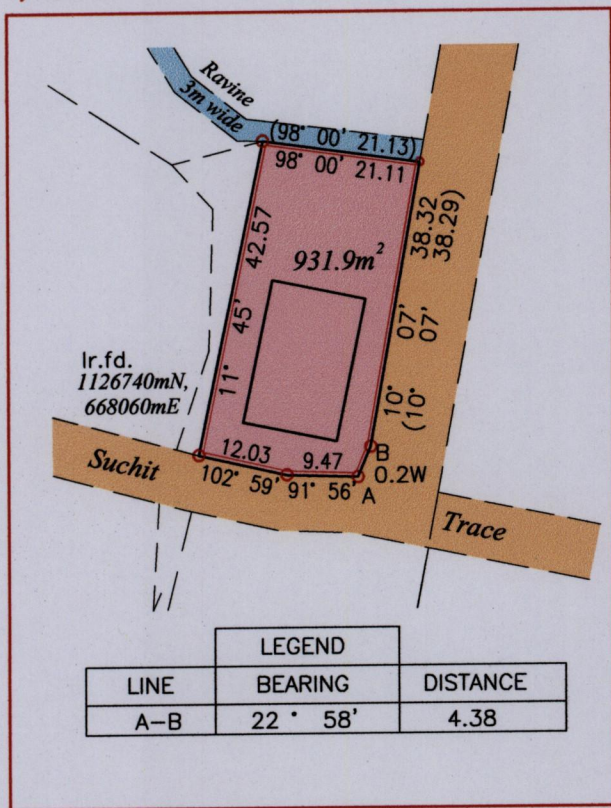

LACKHAN DEOPERSAD AND BRENDA DEOPERSAD 933.0m² now Lackhan Deopersad & Brenda Deopersad 931.9m²

Puzzle Island
Sir Chas Tennant

Dhaniram Bhoopsingh
C.T Vol. 3791
Fol. 381

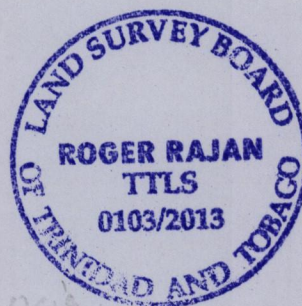

Vide: Bk. 1135 Fol. 501
Bk. 1256 Fol. 137
Bk. 1238 Fol. 109
Bk. 1227 Fol. 208
Bk. 1227 Fol. 213

Coordinate was obtained from Hand Held GPS.
Naparima Datum (+/-5m)
UTM Zone 20.

Distances are in metres
SCALE 1:1,750

Approved

[Signature]
Director of Surveys

○ Denotes Iron put except stated otherwise.

Bearings are Cassini Grid based on Solar Observations

Plan of a Parcel of land coloured pink in the Ward of Siparia.

Containing nine hundred and thirty one point nine square metres.

Surveyed by me, with due authority, in January 2013

Certified correct in accordance with Regulation 25(1) of the Land Surveyors' Regulations 1998,

Checked by.....

Entered on Trinidad & Tobago Land Surveyor..... August 2013