

Cadastral Sheet G.10.C. $\frac{64C}{1/a}$
 Ward of Ortoire
 County of Victoria
Hindustan

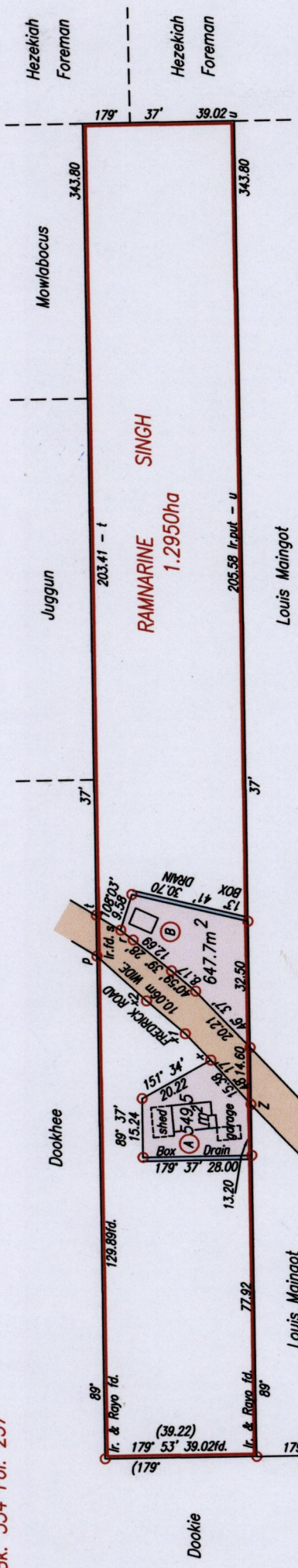
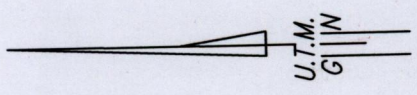

Orig. Survey Bk. 334 fol. 257

SCALE 1:1500
 Distances are in metres
 o Denotes iron put except otherwise stated
 Bearings are U.T.M. Grid based on Solar Observations

r - s	= 38° 48'	4.06
s - t	= 31° 26'	7.52
p - t	= 89° 37'	10.50
x - x1	= 46° 40'	9.48
x1 - x2	= 40° 59'	13.10
x2 - P	= 42° 49'	17.25

Z : 685893mE, 1132726mN
 (U.T.M. 20, WGS 84(+/-5m))
 Coordinates obtained from
 hand held GPS.

Approved
[Signature]
 Director of Surveys 15/11/13

PLAN of 2 Parcels of land coloured pink in the Ward of Ortoire
 Containing together one thousand, one hundred and ninety seven point two square metres.
 Surveyed by me, with due authority, in September, 2011
 Certified Correct in accordance with Regulation 25 (1) of the Land Surveyors' Regulations 1998,

Checked by
[Signature]

Entered on
 Trinidad & Tobago Land Surveyor. 3rd. September . . . 2013.

Process ID # 70444
 R.P.O. Vol. 49 Fol. 207
 C.T. Vol. 5313 Fol. 471
 Ref.: Bk. 719 Fol. 50
 Ref.: Bk. 334 Fol. 257