

R.P.O Vol. 144 Fol. 599
 C.T. Vol. 1138 Fol. 253
 C.T. Vol. 5464 Fol. 335

1650

Ward of Siparia.
 County of St. Patrick.
 Cadastral Sheet G.18.H. 73C

2/c;2/d

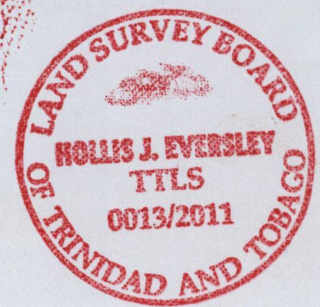
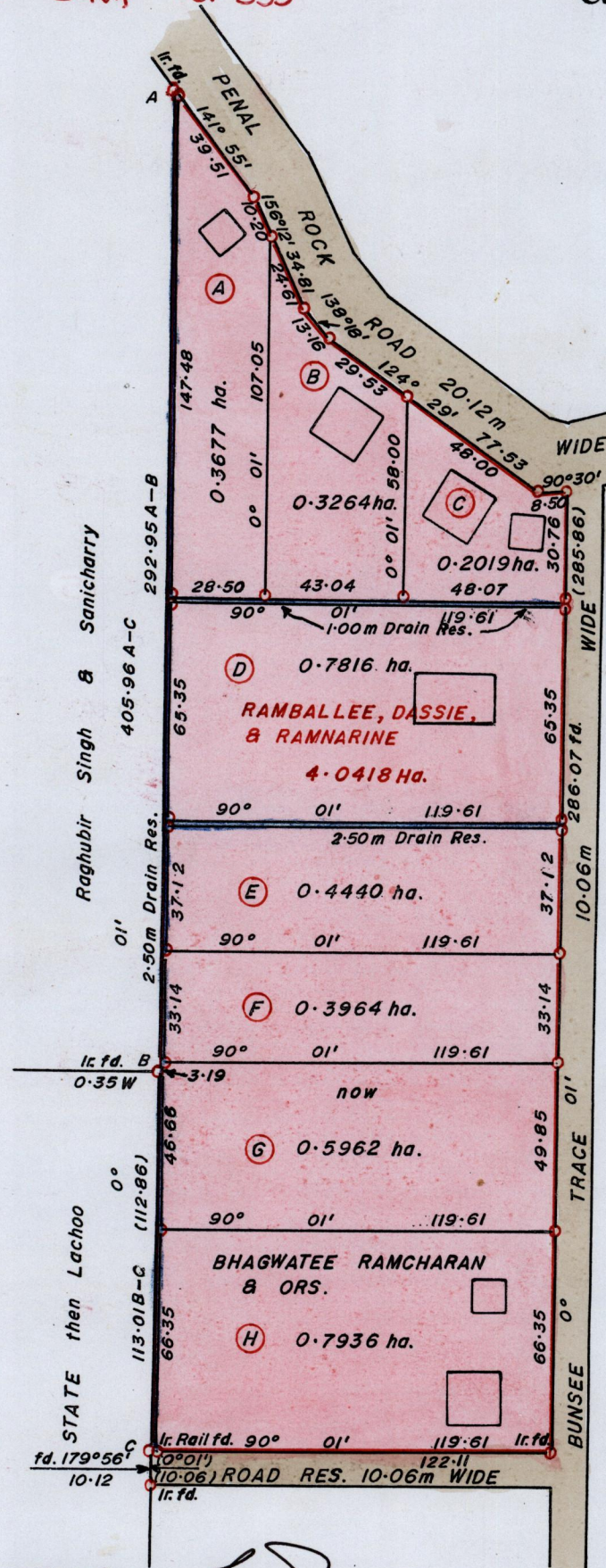
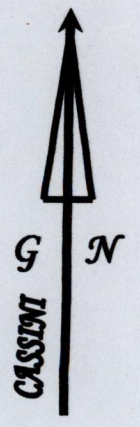

1119504 mN, 673124 mE.
 X - U.T.M. 20, WGS 84 (+/-5.0m)
 GPS Handheld Direct Obs.

S.O. 38/1905
 Bk. 397: 276.
 SCALE 1 : 2000.

Distances are in METRES
 o Denotes Iron Put except otherwise stated
 Bearings are Cassini Grid based on Solar Observations.

Approved: *[Signature]*
 Director of Surveys. 2011-9.12

Note: To obtain compass bearing subtract 01 minute
PLAN of 8 Parcels of land coloured in PINK in the Ward of Siparia.
Containing together three point nine zero seven eight hectares.
Surveyed by me, with due authority, in December 2008.
In accordance with Reg. 25(1) of the Land Surveyors' Regulations 1998,
I certify that this plan is correct.

Checked by *[Signature]* 6/2/11

Entered

[Signature]
 Trinidad and Tobago Land Surveyor. 11. x. 2011. 2011.

Original Bk. 397:276

LOT#	NAMES	C.T. VOL & Folio
A	Motilal Ramcharan.	5464 fol 361
B	Rampersad Ramcharan	5464 fol 365.
C	Bhagwatee Ramcharan	5464 fol 369.
D	Premchand Ramcharan	5464 fol 371
E	Rampersad Ramcharan	5464 fol 367.
F	Motilal Ramcharan	5464 fol 363
G	Hardeo Ramcharan	5464 fol 375
H	Ramdeo Ramcharan	5464 fol 375

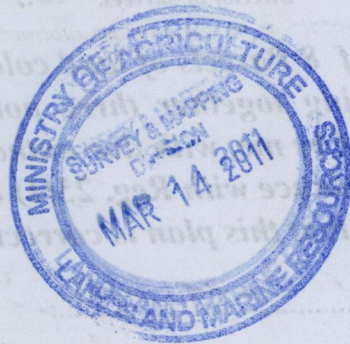

Now 1650/9
1376/200