

7

Vol. 5A-13 Fol. 199  
R.P.O. Vol. 427 Fol. 337  
C.T. Vol. Fol.  
Process JD# 39471

Ward of Savana Grande  
County of Victoria  
Cadastral Sheet G.14.D. 64.E.  
1/a

At Station (A)  
E 0680932  
N 1126523  
Reading taken with  
Handheld G.P.S.  
U.T.M. Zone 20  
Napartina  
+ 5 m.

1650

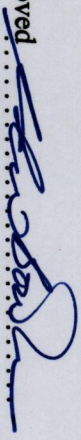
Approved   
Director of Surveys 2011.12.16

Denotes Iron put except stated otherwise.

Note: Bearings are cassini grid based on solar observations  
PLAN of 2 Parcels of land coloured pink in the Ward of Savana Grande  
Containing together nine hundred and forty point zero square metres  
Surveyed by me, with due authority, in May 2008  
In accordance with Regulation 25 (1) of the Land Surveyors' Regulations 1998,  
I certify that this plan is correct.

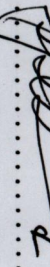
Checked by  .....

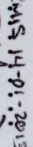
Entered on  14-01-2013 Trinidad & Tobago Land Surveyor ..... 2011

now or formerly Soomaroo  
Vide Bk. 386 fol. 14

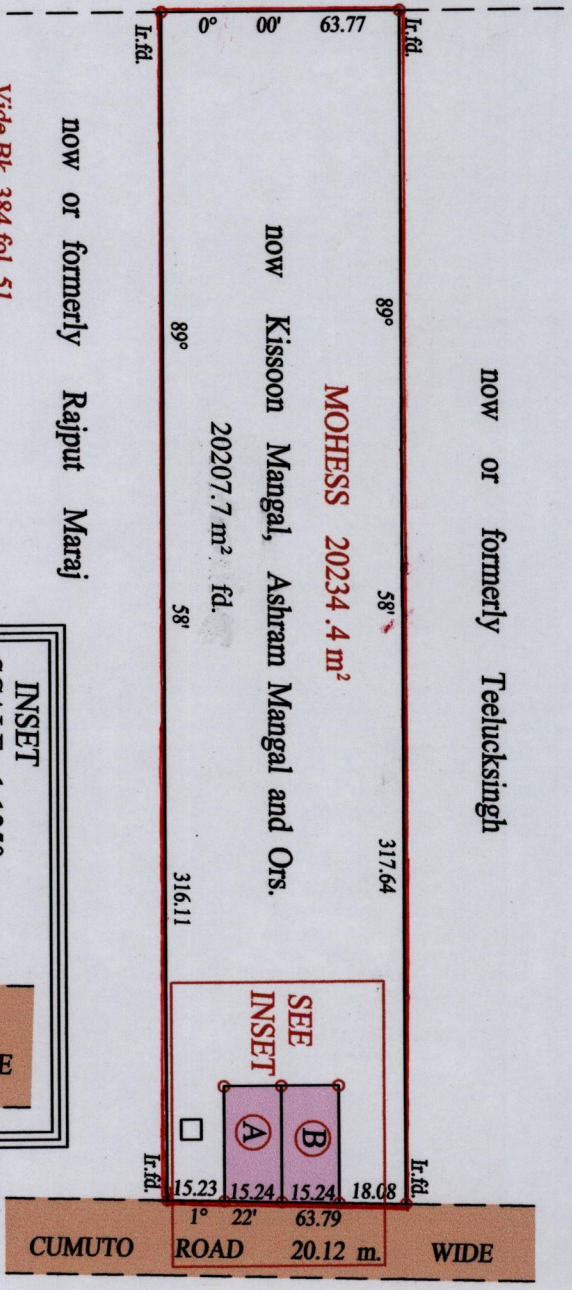

SCALE : 1:2000  
Distances are in metres  
Vide Bk. 384 fol. 51  
Vide Bk. 1145 fol. 759

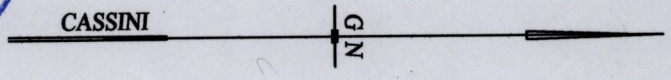
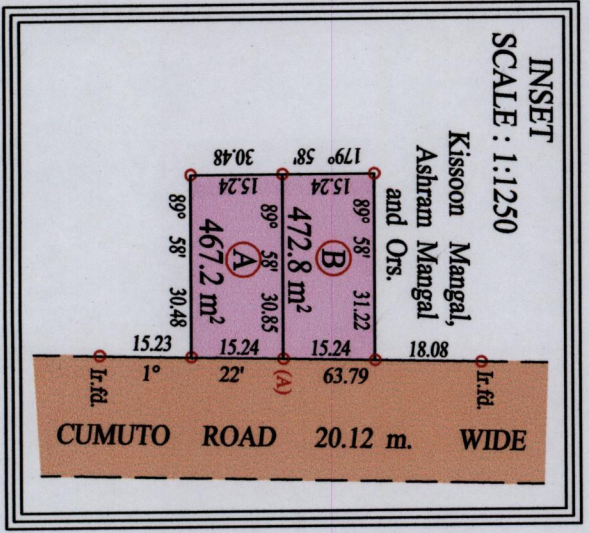

1650/87



Lot No.	CT. VOLUME & FOLIO	NAMES
A	5473 fol. 211	TARAMATIE MUNGAL
B	5473 fol. 205	VIDIA MANGAL - SOOKHAN

NOO 1650/87  
1398/87