

111

Vol. 5509 Fol. 325

R.P.O. Vol. 83 Fol. 293

C.T. Vol. 1302 Fol. 203

Pross JD# 49925

R.C. 29

REMAINING PORTION

Cadastral Sheet G.13.J. 63F  
3/a

Ward of Siparia  
County of St. Patrick

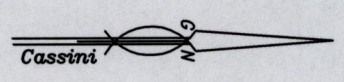
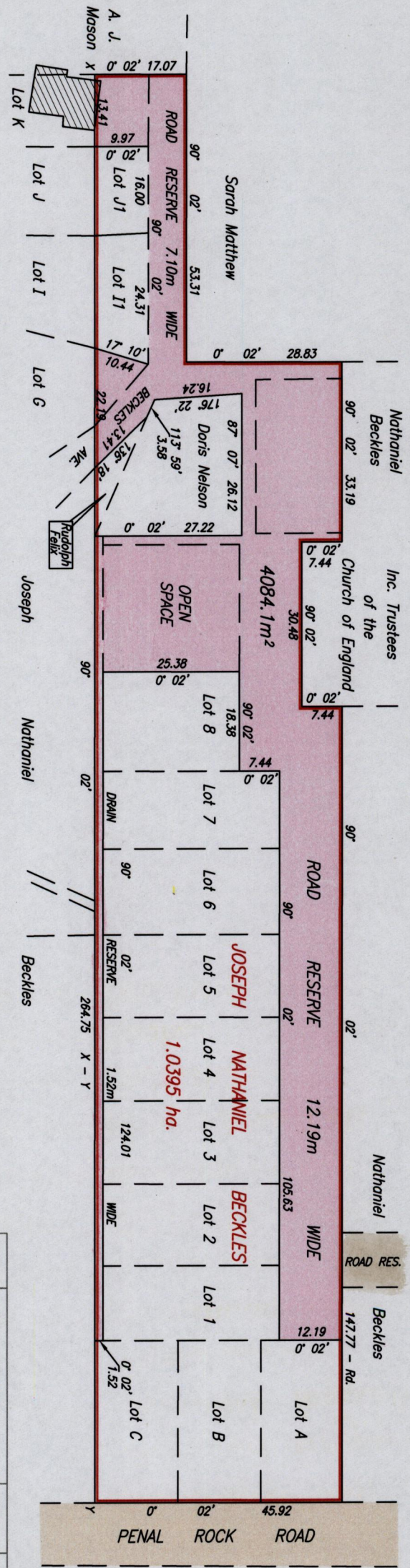

1650

Approved *[Signature]*  
Director of Surveys 2012.10.5

SCALE 1/1000  
Distances are in metres

To obtain compass bearings subtract 2 minutes  
This is a true copy of a diagram of one point zero three nine five hectares originally granted to Joseph Nathaniel Beckles, showing a portion coloured pink and containing four thousand and eighty four point one square metres being the remainder after fifteen (15) previous transfers of other portions of the land. In accordance with regulation 25 (1) of the Land Surveyors' Regulations 1998, I certify that this plan is correct.

Checked by *[Signature]* 2/8/12

Entered on: O.M.S. Reg. 28. 2013



Nos.	NAMES	AREAS	C of T
1	J. N. Beckles	494.8m <sup>2</sup>	2512/439
2	R. Jogessor	494.8m <sup>2</sup>	1609/55
3	R. & L. Mohan	494.8m <sup>2</sup>	1708/505
4	R. Ramrattan	494.8m <sup>2</sup>	1609/43
5	R. Jogessor & B. Jogessor	494.8m <sup>2</sup>	1708/475
6	S. Kanhai	494.8m <sup>2</sup>	1708/489
7	S. Daniel	494.8m <sup>2</sup>	2002/267
8	S. Caldero	466.1m <sup>2</sup>	1811/389
A	P. Kanhai & S. Kanhai	464.5m <sup>2</sup>	1570/65
B	B. & H. Ramnison	464.5m <sup>2</sup>	1800/375
C	I. Manbooth	464.5m <sup>2</sup>	1800/367
11	J. Pollonais & G. Pollonais	227.1m <sup>2</sup>	4570/75
J1	E. Bhiary	159.5m <sup>2</sup>	4829/489
	Doris Nelson	540.3m <sup>2</sup>	2891/95
	Rudolph Felix	60.8m <sup>2</sup>	3889/501

Trinidad & Tobago Land Surveyor *[Signature]* 2012

143

18/09/1

124

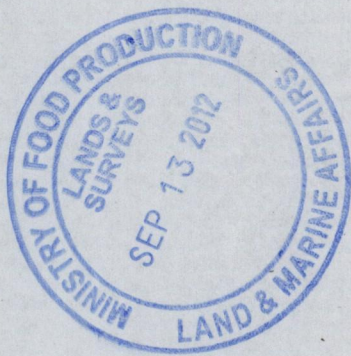

1733

now 1650/81  
1133/124