

No

22214

1650

65

Vol. 5465 Fol. 101

R.P.O. Vol. 171

C.T. Vol. 1211

Fol. 379

Fol. 29

Ward of Saparia

County of St. Patrick

Cadastral Sheet G.12.H. $\frac{63E}{2/c}$

Rem. Portion Plan in

R.P.O. Vol. 2908

Fol. 25

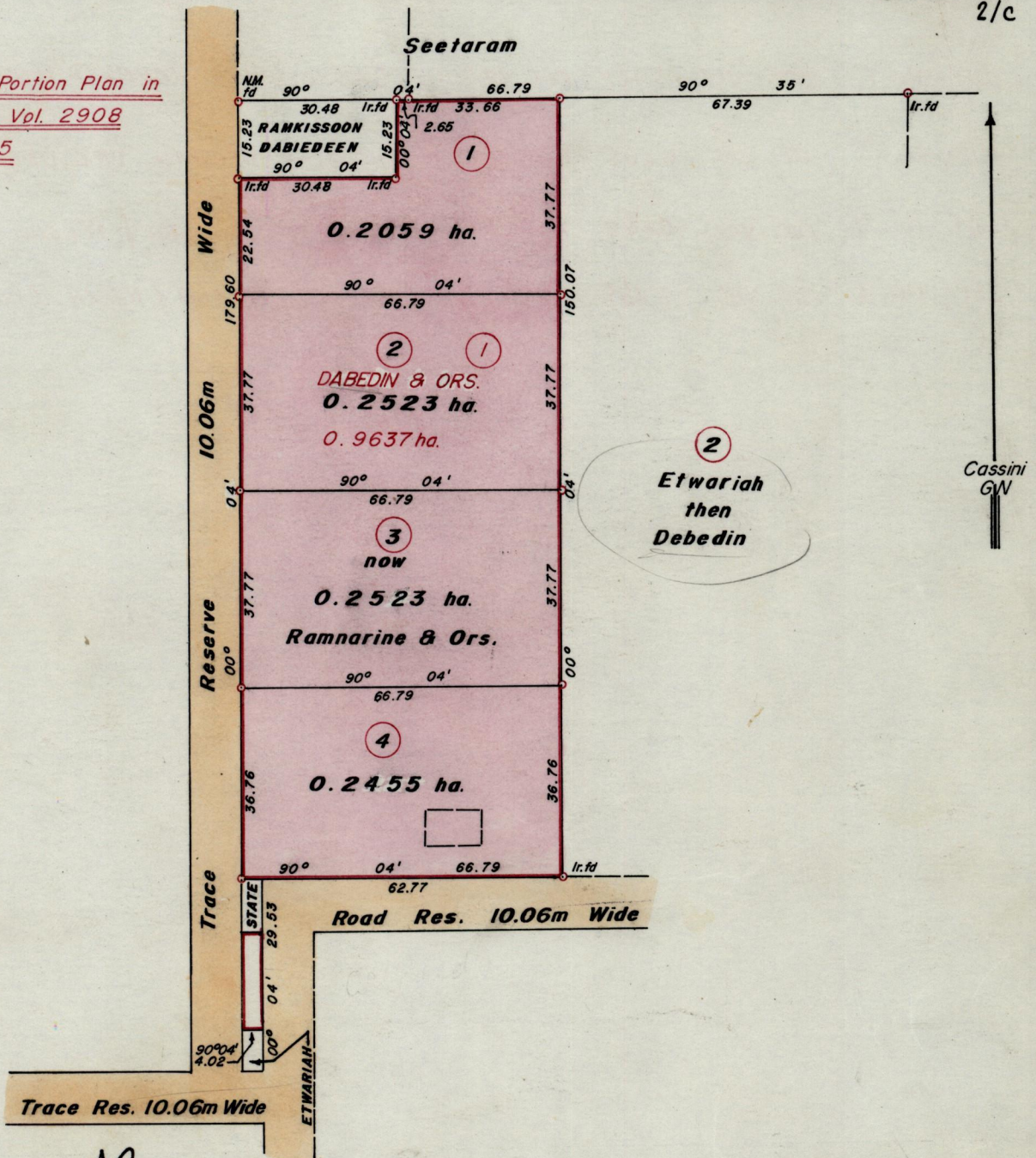

Approved

Louis Charles

AP Director of Surveys 92.04.13

• Denotes Iron Put except otherwise stated
Bearings are based on Solar Obs.

SCALE 1:1250

Note: To obtain compass bearings add/subtract

minutes

Distances are in Metres.

PLAN of 4 Parcels of land coloured pink in the Ward of Saparia.

Containing together, zero point nine five six zero hectares.

Surveyed by me, with due authority, in August 1991.

I certify that I have complied with rule 76 under section 14(2)(d) of the Land Surveyors' Ordinance 1952, and that this plan is correct.

Checked by *Ramcharan* 7/14/92

Juma

Entered

Land Surveyor, Trinidad *24th October* 1991

20

Remaining portion plan - BK 1141 fol. 164

LOT. NO. 1 CT. VOL. 5465 FOL. 123 - JASSODRA & JEENATH LOORKHOOR

LOT. NO. 2 CT. VOL. 5465 FOL. 131 - BASDEO & DEODATH DEBIDEEN

LOT. NO. 3 CT. VOL. 5465 FOL. 115 - KAMNARINE JASODRA & PERSAD ROHIT

LOT. NO. 4 CT. VOL. 5465 FOL. 107 - GOPAUL, SEETA & NEERA LOORKHOOR

new 1650/65
1146 vol. 180