

Vol. 5475 Fol. 431

R.P.O. Vol. 193 fol. 521

C.T. Vol. 3044 fol. 217

Vide: Bk.1157 fol. 58

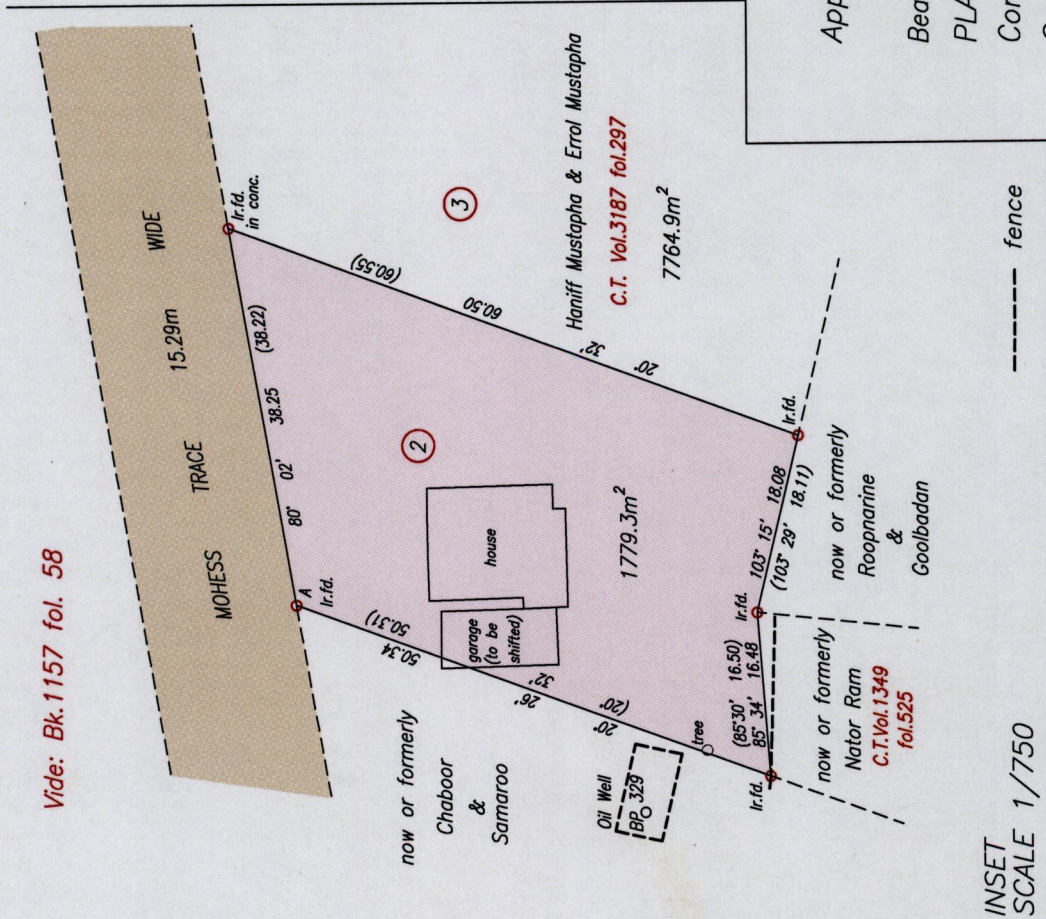

INSET
SCALE 1/750



Cadastral Sheet G.13.G. 63F
2/c
Ward of Siparia
County of St. Patrick

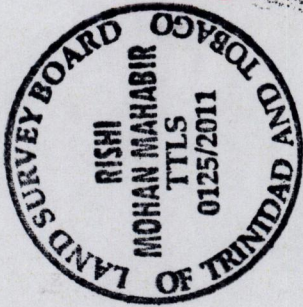

Distances are in metres

A	Ir.f.d.	N 1125455	Hand Held GPS +/- 5m
		E 672000	UTM proj. nap. 1965 datum

SCALE 1/1500

Distances are in metres

Approved *[Signature]*
Director of Surveys 2011.8.19

Bearings are Cassini based on Solar Observations

PLAN of a parcel of land coloured pink in the Ward of Siparia

Containing one thousand seven hundred and seventy nine point three square metres

Surveyed by me, with due authority, in January, 2011

In accordance with Regulation 25 (1) of the Land Surveyors' Regulations 1998,

I certify that this plan is correct.

Checked by *[Signature]*
Entered on
Trinidad & Tobago Land Surveyor...!6.....2011

64



now 1650 / 64
~~1376 / 89.~~