

REMAINING PORTION

R.P.O. Vol Fol
C.T. Vol. 519 Fol. 607
Vol. 5471 Fol. 481
Ref: Bk. 720 Fol. 142

Ward of Pointe-a-Pierre
County of Victoria
Cadastral Sheet $\frac{54B}{1/a}$ (D.24.E)

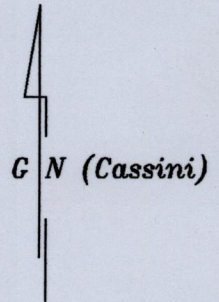
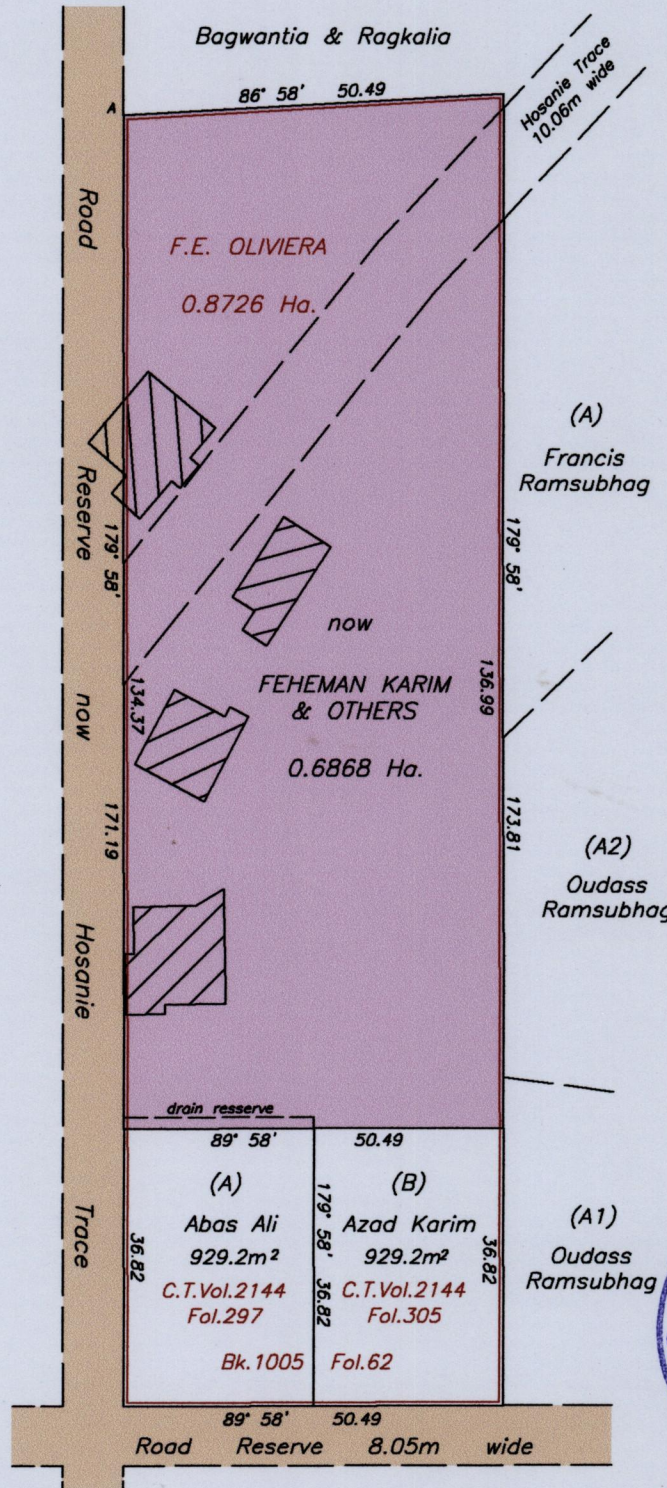

Approved: *[Signature]*
Director of Surveys
2012.4.12

A = N 1143500 (U.T.M)
E = 681305

Notes: U.T.M 20 Naparima (GPS +/- 3.0m)
Bearings are Cassini Grid based on solar observations

SCALE 1:1000
Distances are in METRES

This is a true copy of a diagram of Zero Point Eight Seven Two Six Hectares, originally transferred to F.E. OLIVIERA, showing a portion coloured pink and containing Zero Point Six Eight Six Eight Hectares being the remainder after Two previous transfers of another portion of the land. In accordance with Regulation 25 (1) of the Land Surveyors Regulations 1998, I certify that this plan is correct.

Checked by: *[Signature]* 29/3/2012

[Signature]

Entered on.....

Trinidad and Tobago Land Surveyor..... February 102012

52

1056

Part of Town of...
County of...
Industrial Site...
Lot...
CT...
M...

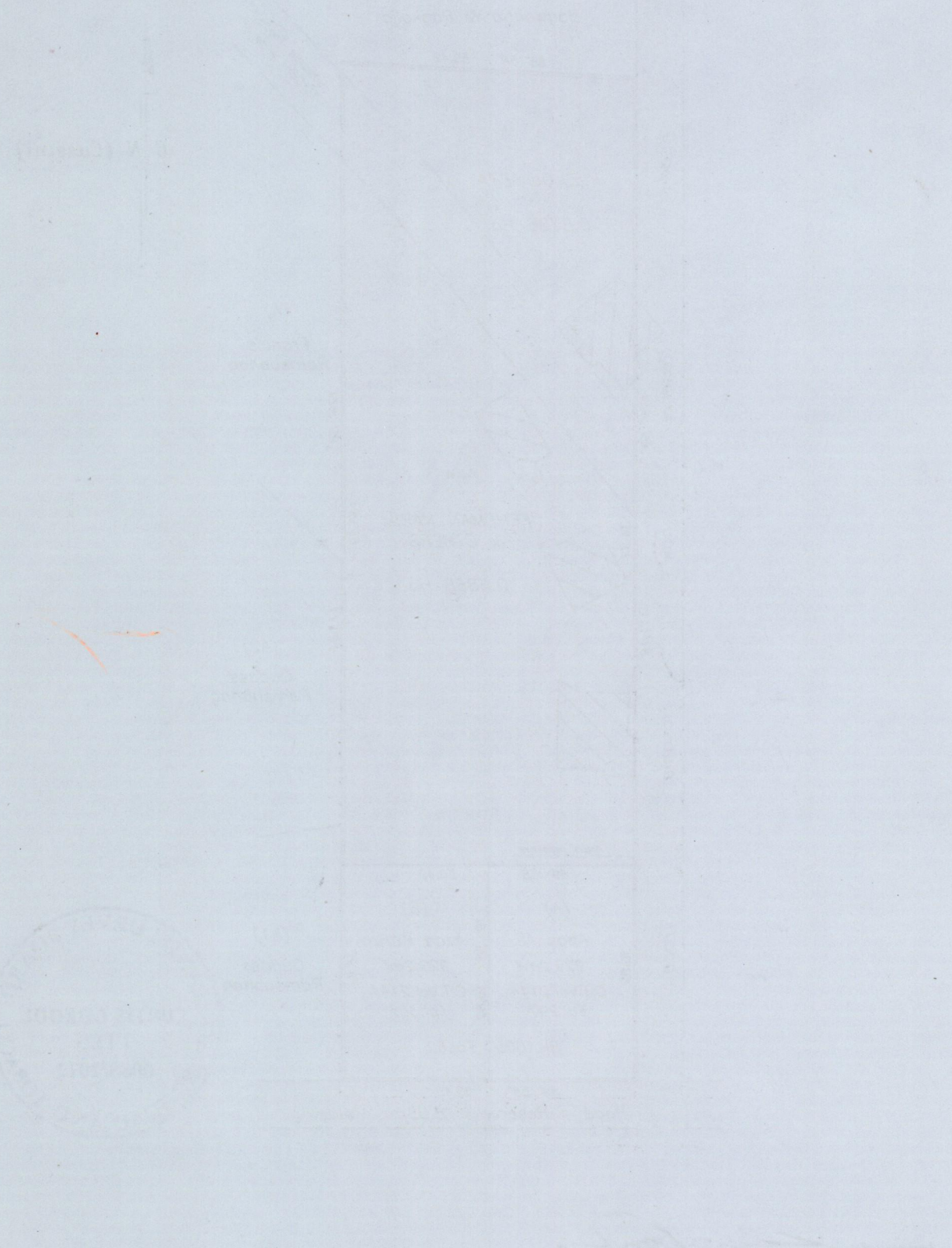

1395/202
NOW 1650/52