

C.T. Vol. 1823

Fol. 229

1650

Cadastral Sheet B.24.A

24B  
1/d

48

C.T. Vol. 2541  
C.T. Vol. 5328

Fol. 521  
Fol. 247

Ward of Tacarigua

County of St George

### REMAINING PORTION PLAN

See Bk. 1017 Fol. 206

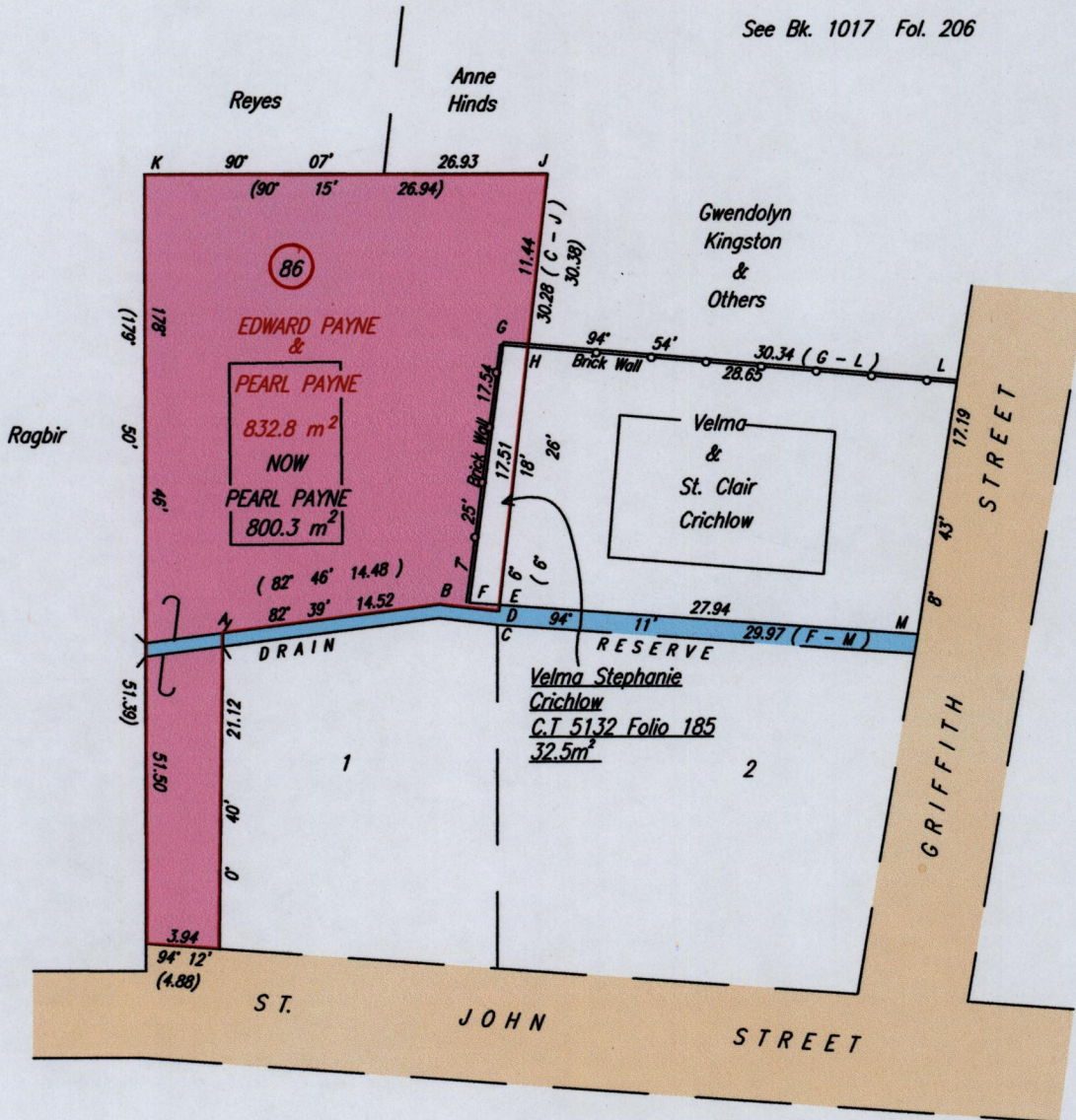

Approved

*[Signature]*  
Director of Surveys  
2011. 2. 25



B - C	109° 12'	4.15
C - D	6° 18'	0.91
D - E	6° 18'	0.43

SCALE 1 : 500

Distances are in metres.

This is a true diagram of Eight Hundred and Thirty Two Point Eight square meters Originally granted to EDWARD PAYNE & PEARL PAYNE shewing a portion Coloured Pink and containing Eight Hundred Point Three square meters being the remainder after ONE previous tranfer of another portion of the land In accordance with Regulation 25 (1) of the Land Surveyors' Regulations 1998, I certify that this plan is correct.

Checked by *[Signature]* 22/2/2011

Entered on .....

*[Signature]*

Trinidad and Tobago Land Surveyor .....2010.



Original Bk. 1017:206

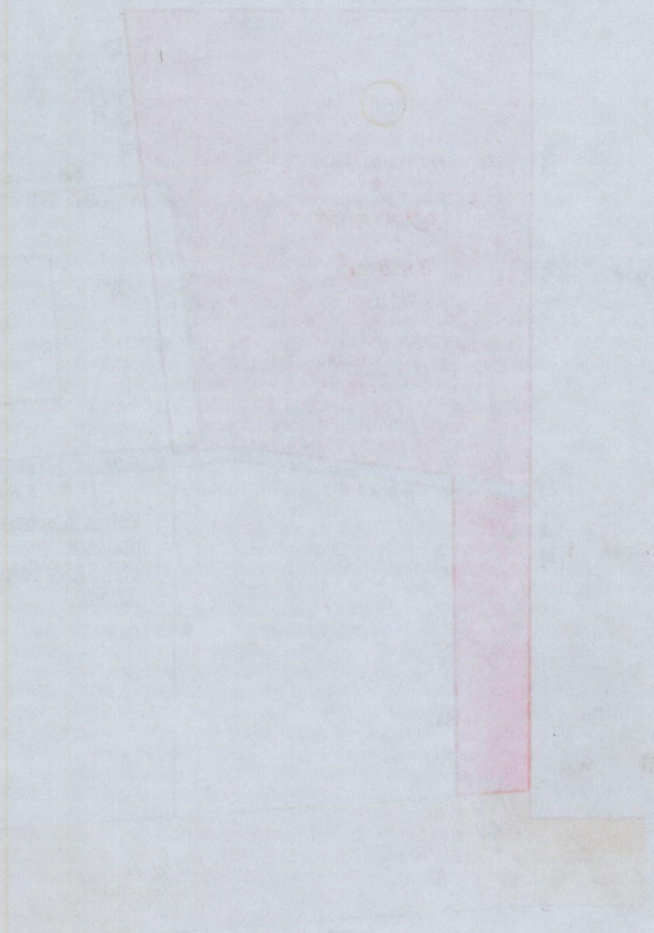

MINISTRY OF AGRICULTURE  
SURVEY & MAPPING  
JAN 17 2011  
LANDS AND MARINE RESOURCES

now 1650/48  
1376/53